

VICTORIAN RAILWAYS, MURCHISON AND RUSHWORTH LINE.

SCALE. 10 CHAINS TO AN INCH

CONTRACT N^o 2984
N^o 1.

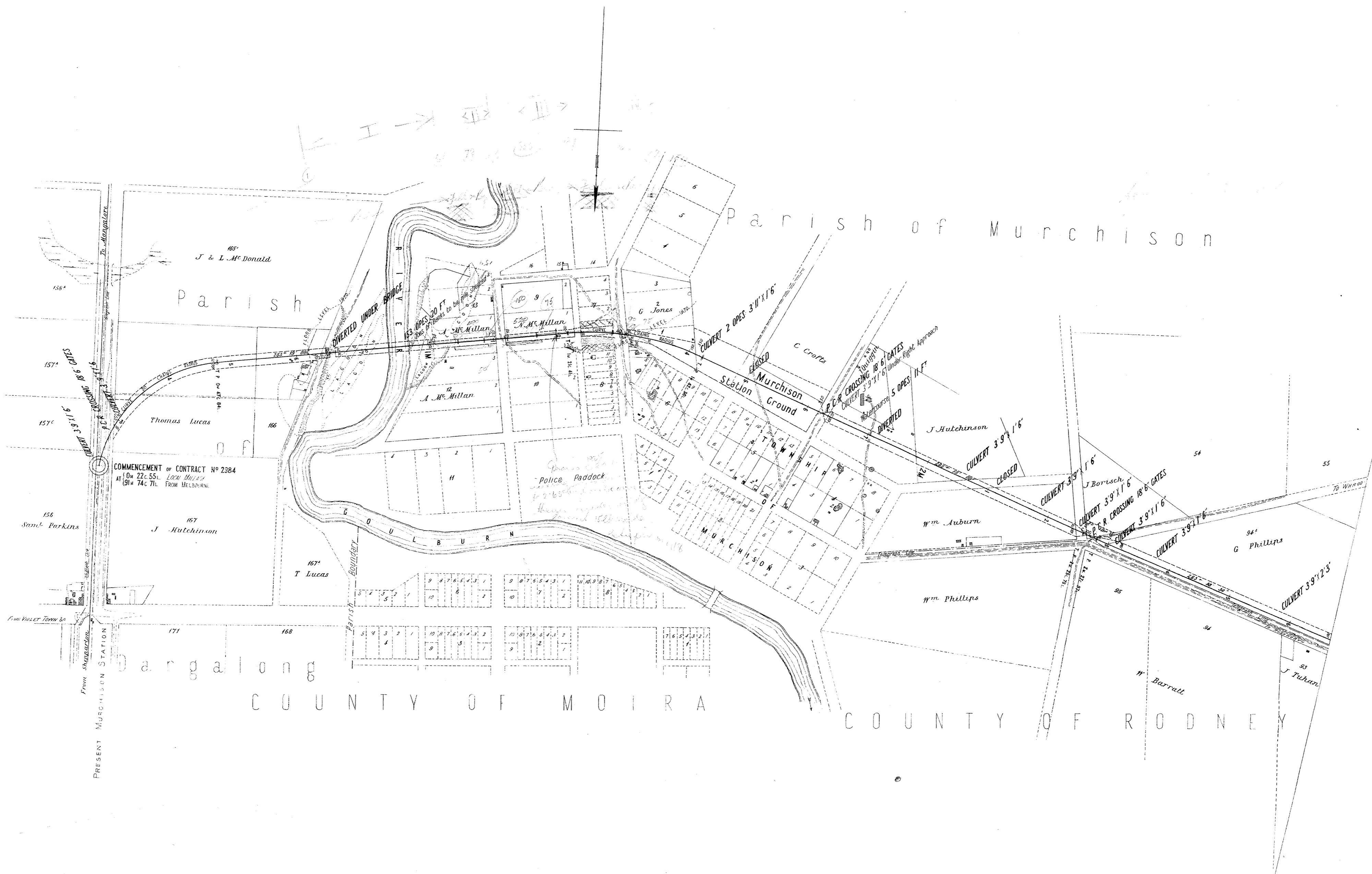

NOTE—Contractors must form their own judgment as to the nature of the Excavations, Borings and other information shown on these Sections are derived from the Surveyors' notes but are not guaranteed as correct, and the Corporation will not incur any responsibility in respect thereof.

The figures under the description of the Curves at the bottom of the Section denote the super-elevation of the outer rail; Speed 30 miles an hour.

VICTORIAN RAILWAYS, MURCHISON AND RUSHWORTH LINE.

**CONTRACT NO 2984.
No 1.**

SCALES: HORIZONTAL 4 CHAINS TO AN INCH.
VERTICAL 40 FEET TO AN INCH.

