

VICTORIAN RAILWAYS, KOROIT AND DUNKELD LINE. Plan of Land

⑥

Reference Number

Belonging to Occupied by

Situated in the Parish of in the County of Villiers

Scale 10 Chains to 1 Inch.

Quantity of Land required and colored red ^{A. R. P.} more or less.

Parish of Willatook Parish of Kangertong

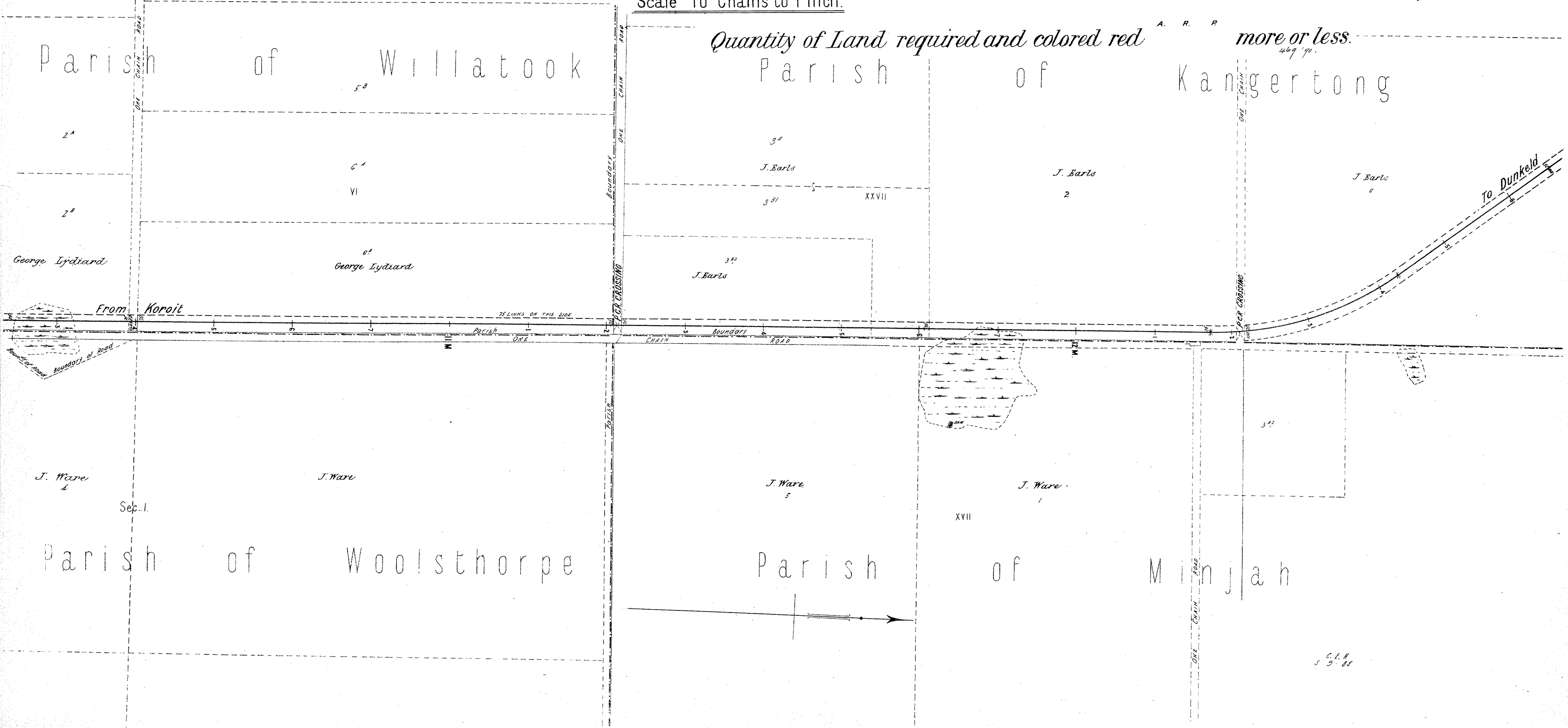

6.1.4
5.3.88

VICTORIAN RAILWAYS,
KOROIT AND DUNKELD LINE.

7

Reference Number

Plan of Land

Belonging to..... Occupied by.....

Situated in the Parish of Kangertong in the County of Villiers

Scale 10 Chains to 1 Inch.

Quantity of Land required and colored red more or less.
470' 90."

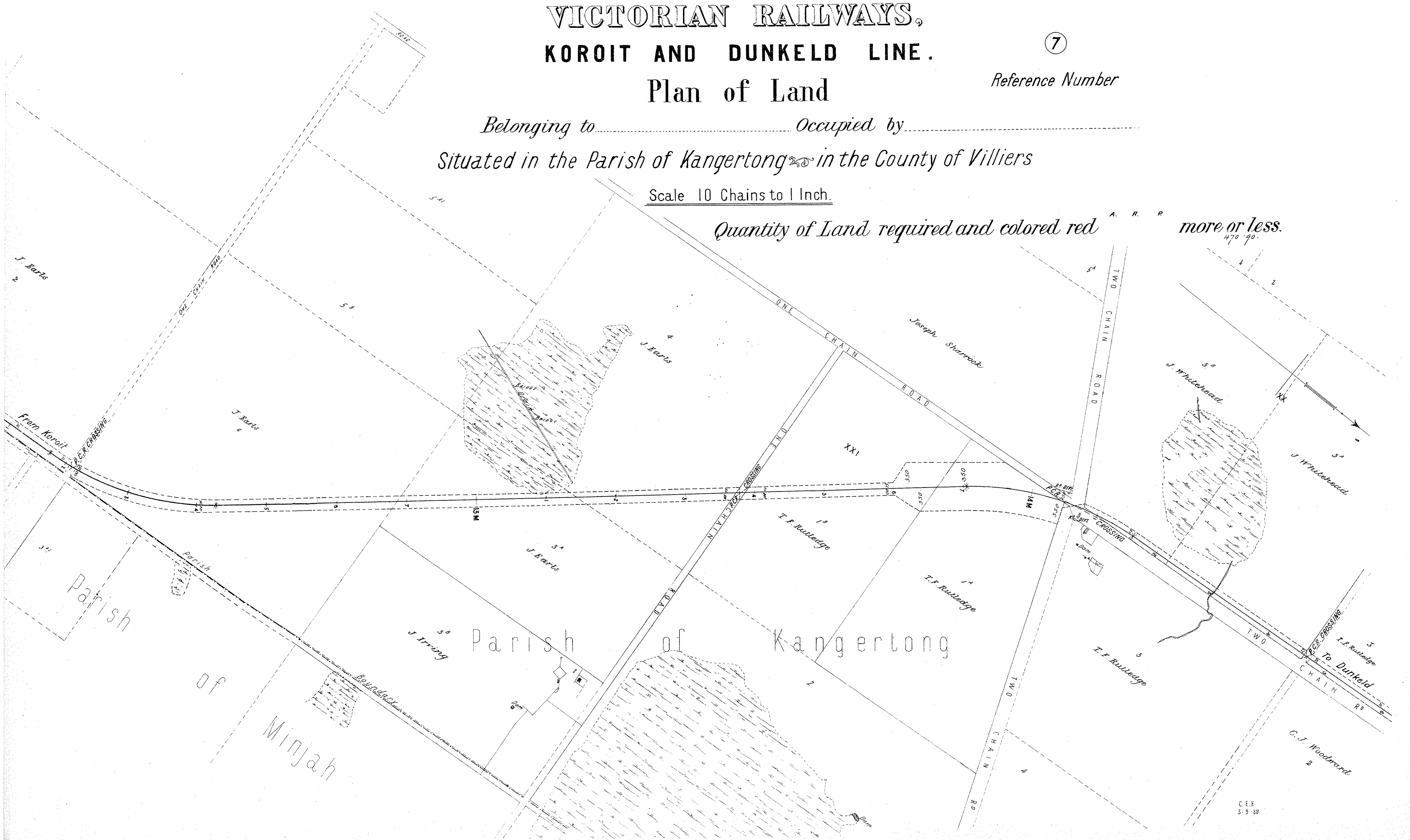

VICTORIAN RAILWAYS, KOROIT AND DUNKELD LINE Plan of Land

⑧

Reference Number

Belonging to..... Occupied by.....
Situating in the Parish of Kangertong in the County of Villiers

Scale 10 Chains to 1 Inch.

Quantity of Land required and colored red ^{A. R. P.} more or less. No 557 '90

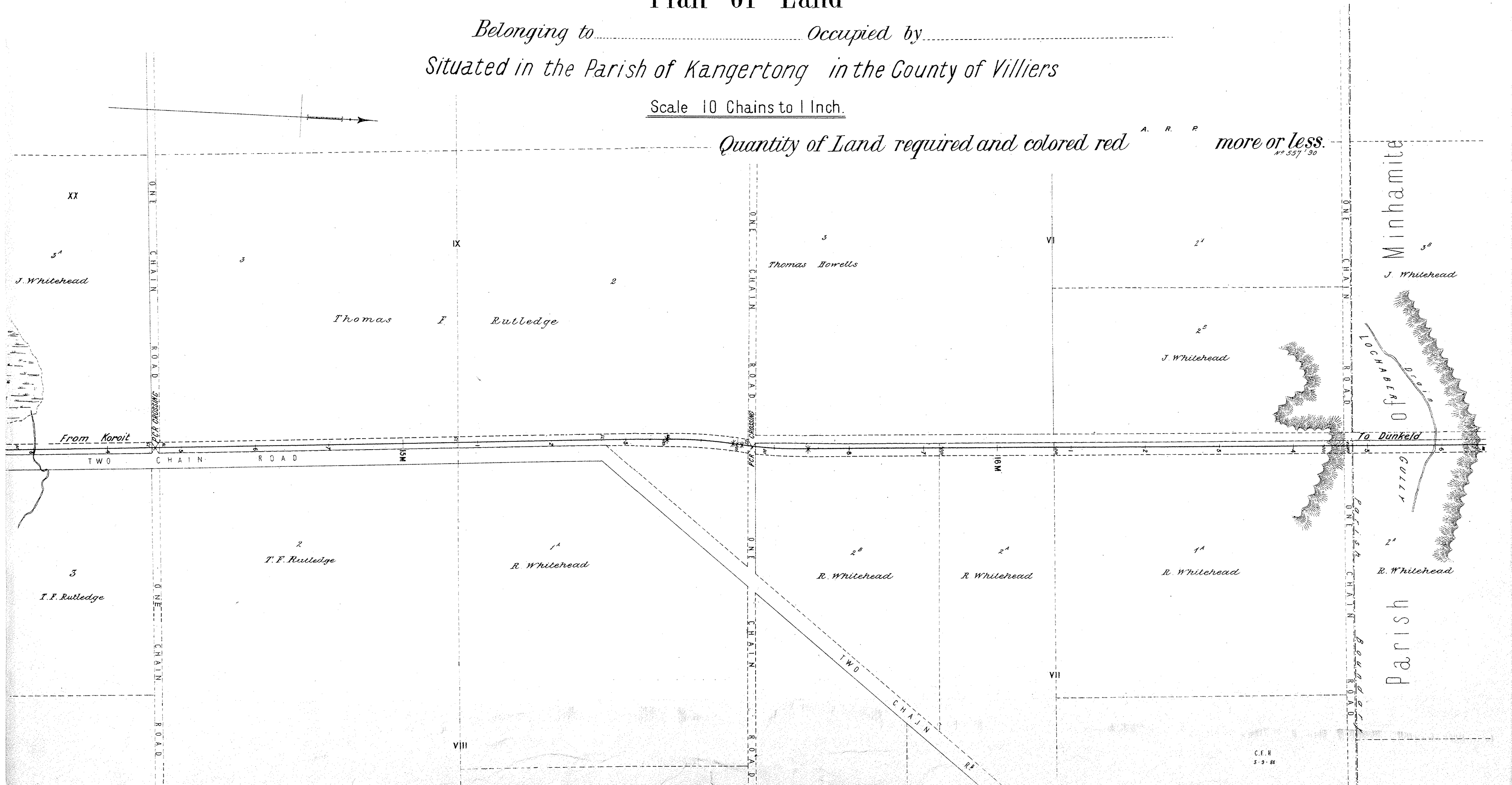

VICTORIAN RAILWAYS, KOROIT AND DUNKELD LINE .

Plan of Land

⑩

Reference Number

Belonging to..... Occupied by.....
Situating in the Parish of Minhamite in the County of Villiers

Scale 10 Chains to 1 Inch.

Quantity of Land required and colored red more or less.
561.90.

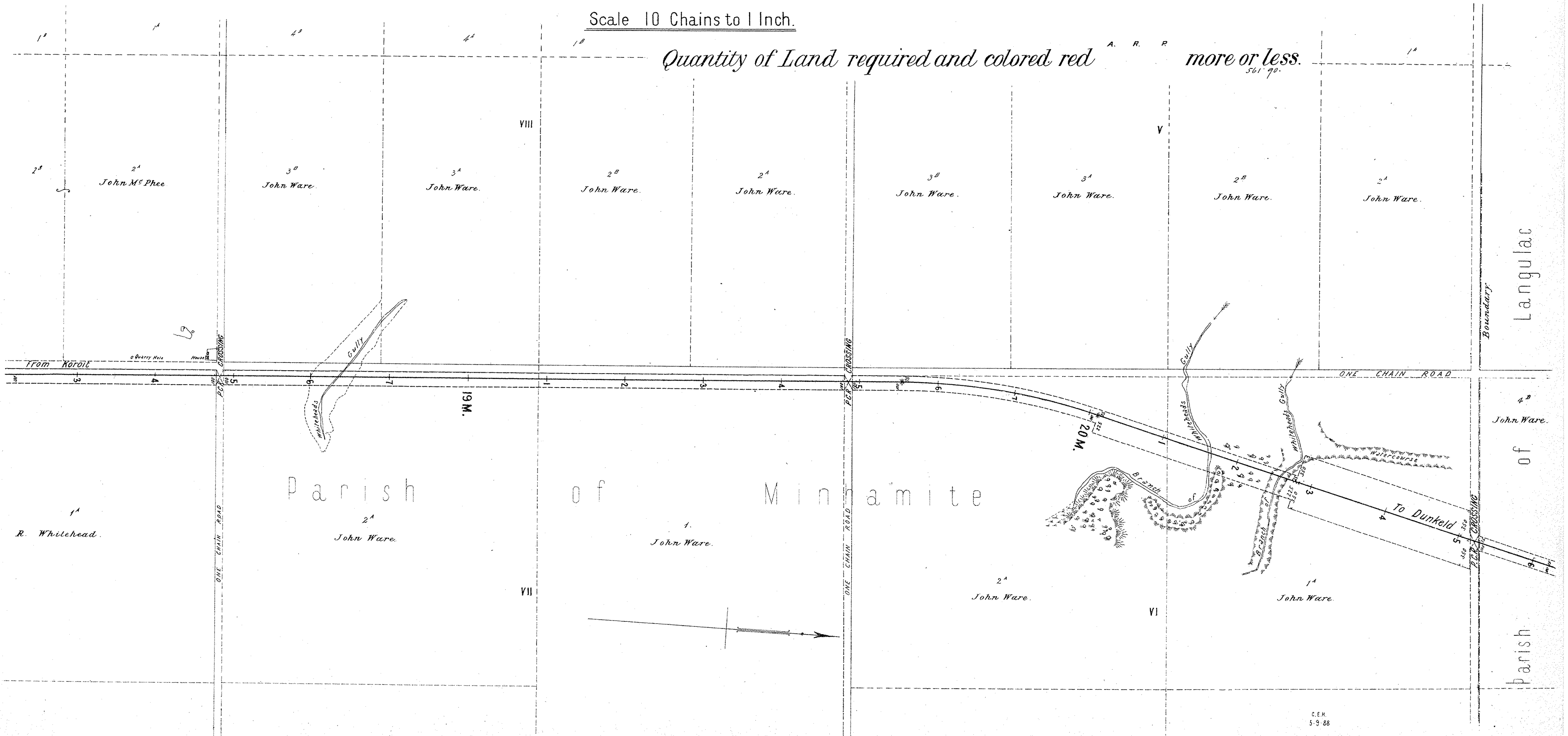

VICTORIAN RAILWAYS, KOROIT AND DUNKELD LINE. Plan of Land

(11)^x

Reference Number

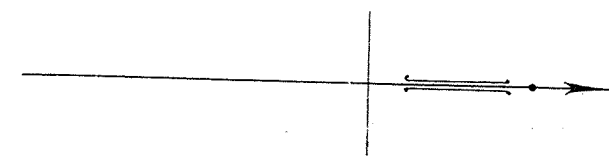

Belonging to Occupied by
Situating in the Parish of in the County of Villiers

Scale 10 Chains to 1 Inch.

Quantity of Land required and colored red ^{A. R. P.} more or less. _{560' 90.}

Parish of Minhamite

Parish of Langulac

Parish of South Caramut

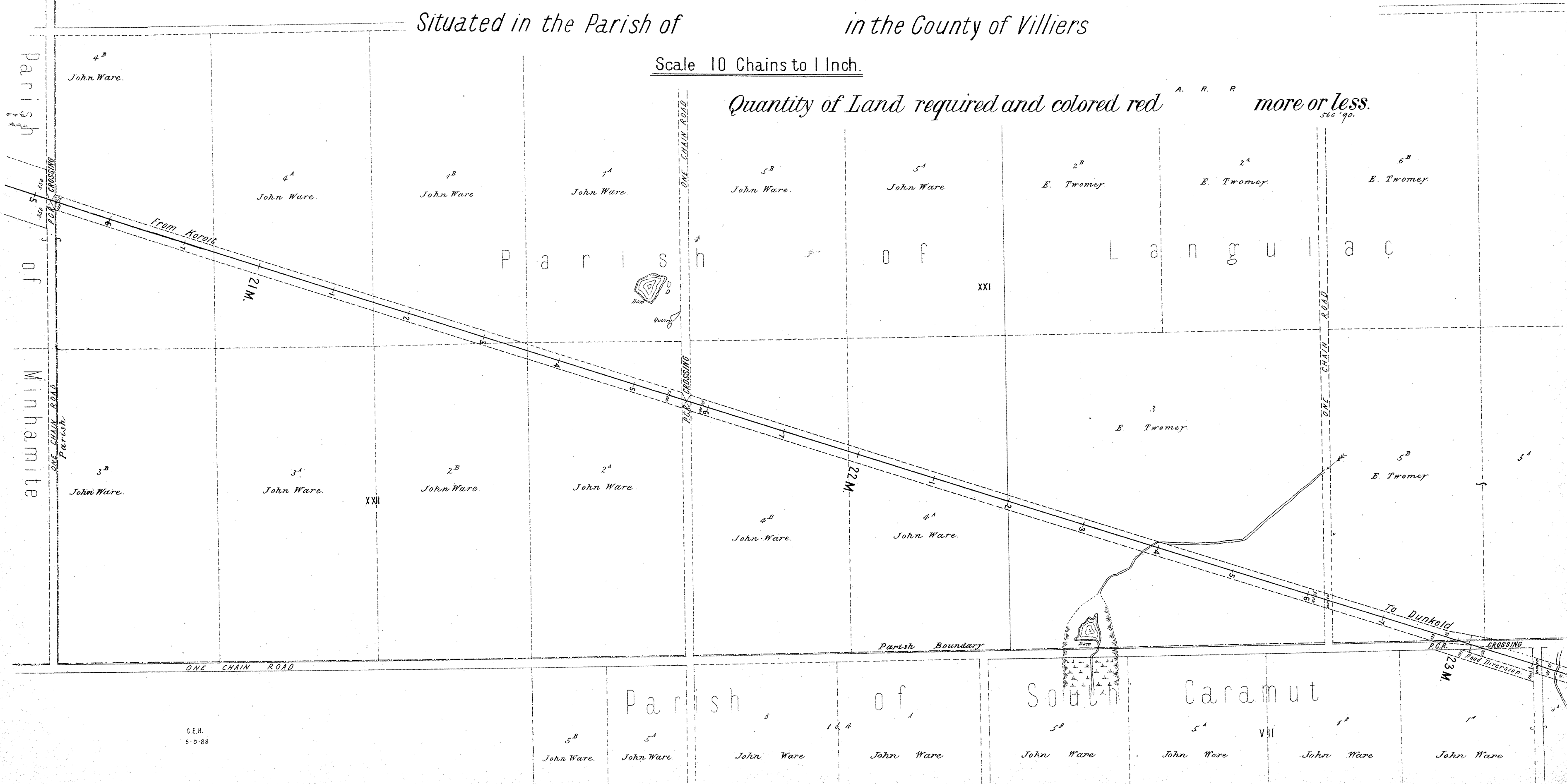

VICTORIAN RAILWAYS, KOROIT AND DUNKELD LINE. Plan of Land

(12)^x

Reference Number

Belonging to _____ Occupied by _____
Situating in the Parish of _____ in the County of Villiers

Scale 10 Chains to 1 Inch.

Quantity of Land required and colored red *A. R. P.* more or less. 587'90.

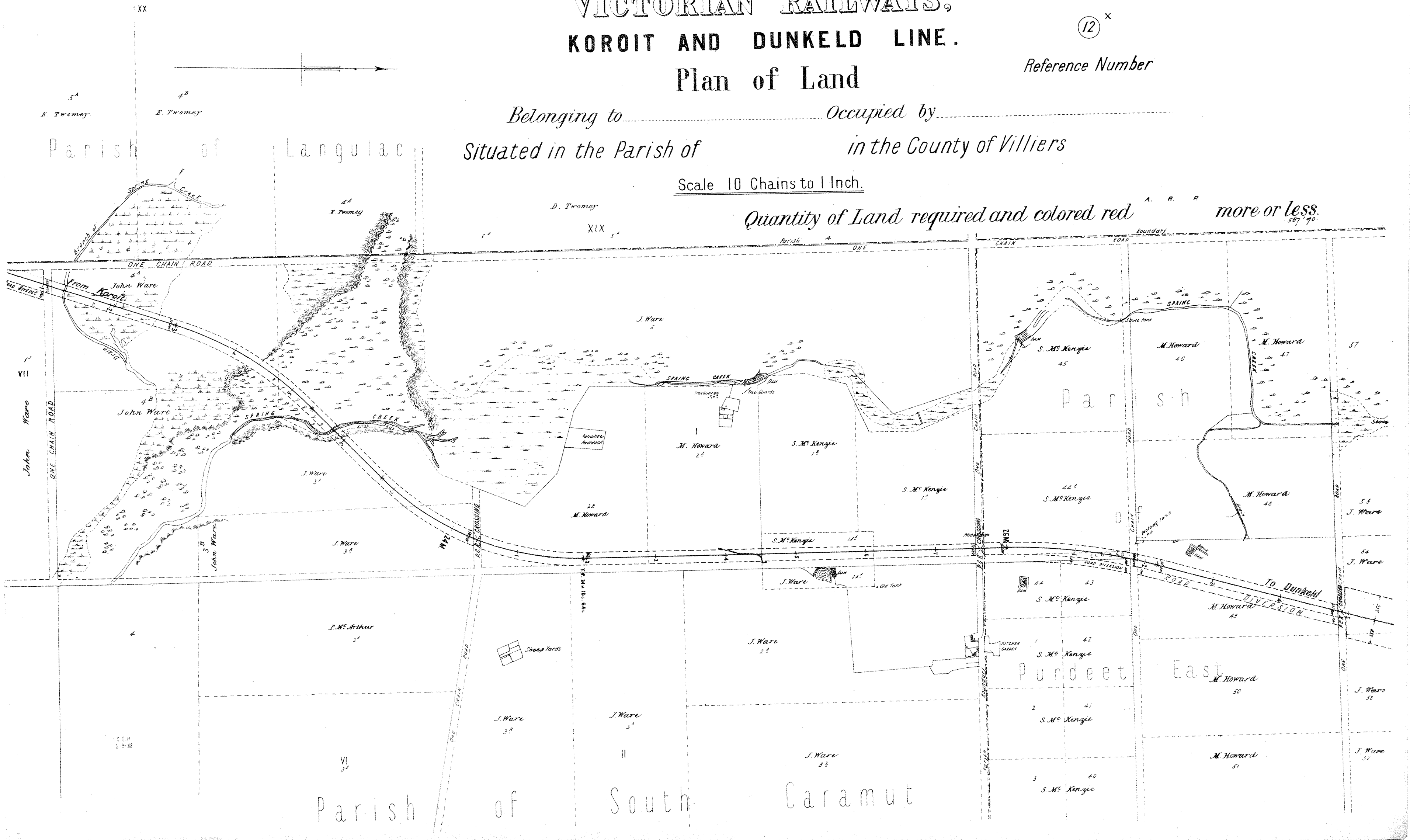

VICTORIAN RAILWAYS, KOROIT AND DUNKELD LINE Plan of Land

14

Reference Number

Belonging to Occupied by

Situated in the Parish of in the County of Villiers

Scale 10 Chains to 1 Inch.

Quantity of Land required and colored red ^{A. R. P.} more or less.
150' 90.

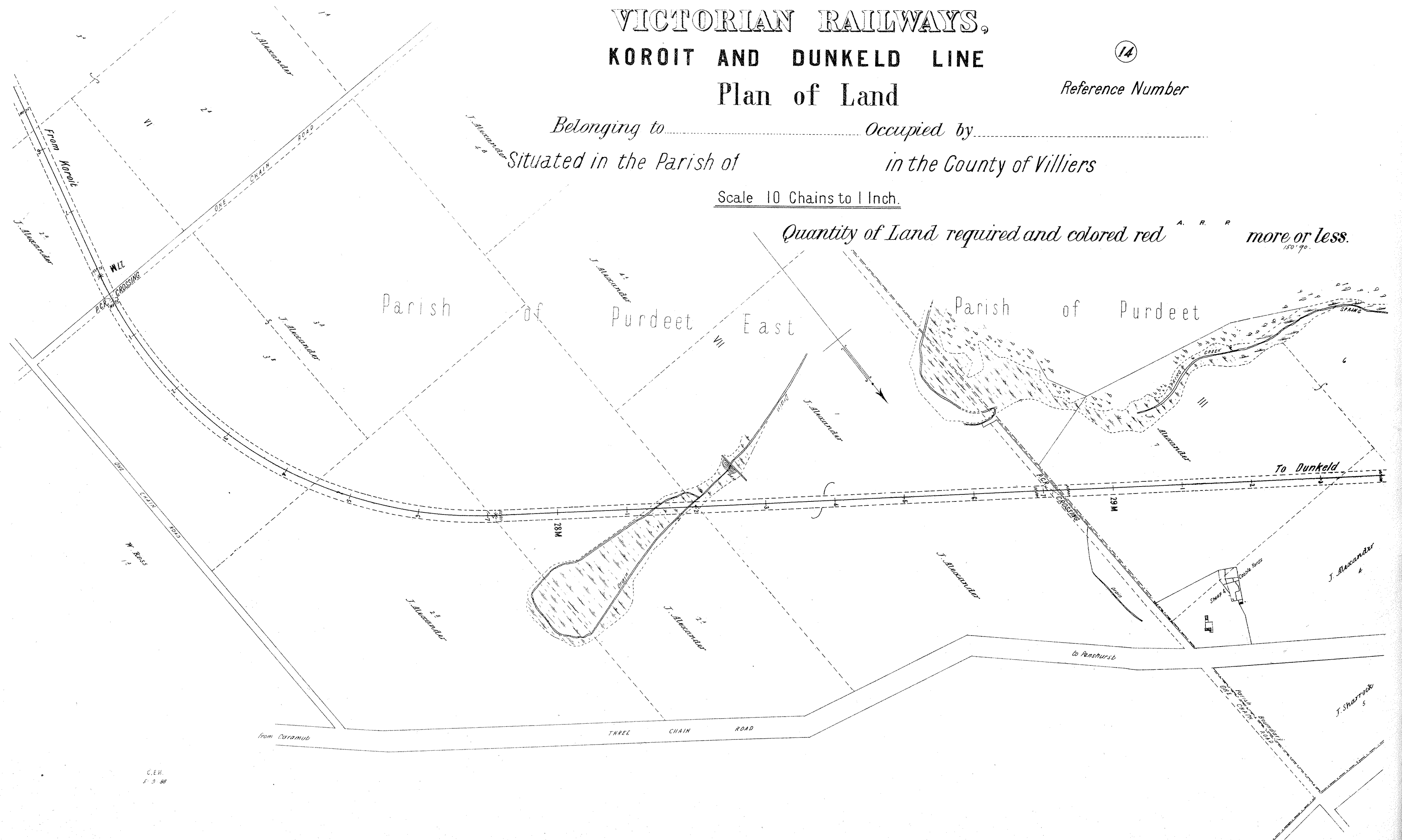

C.E.H.
5. 3. 80

VICTORIAN RAILWAYS, KOROIT AND DUNKELD LINE.

15

Reference Number

Plan of Land

Belonging to Occupied by
Situating in the Parish of in the County of Villiers

Scale 10 Chains to 1 Inch.

Quantity of Land required and colored red ^{A. R. R.} more or less. _{151.90}

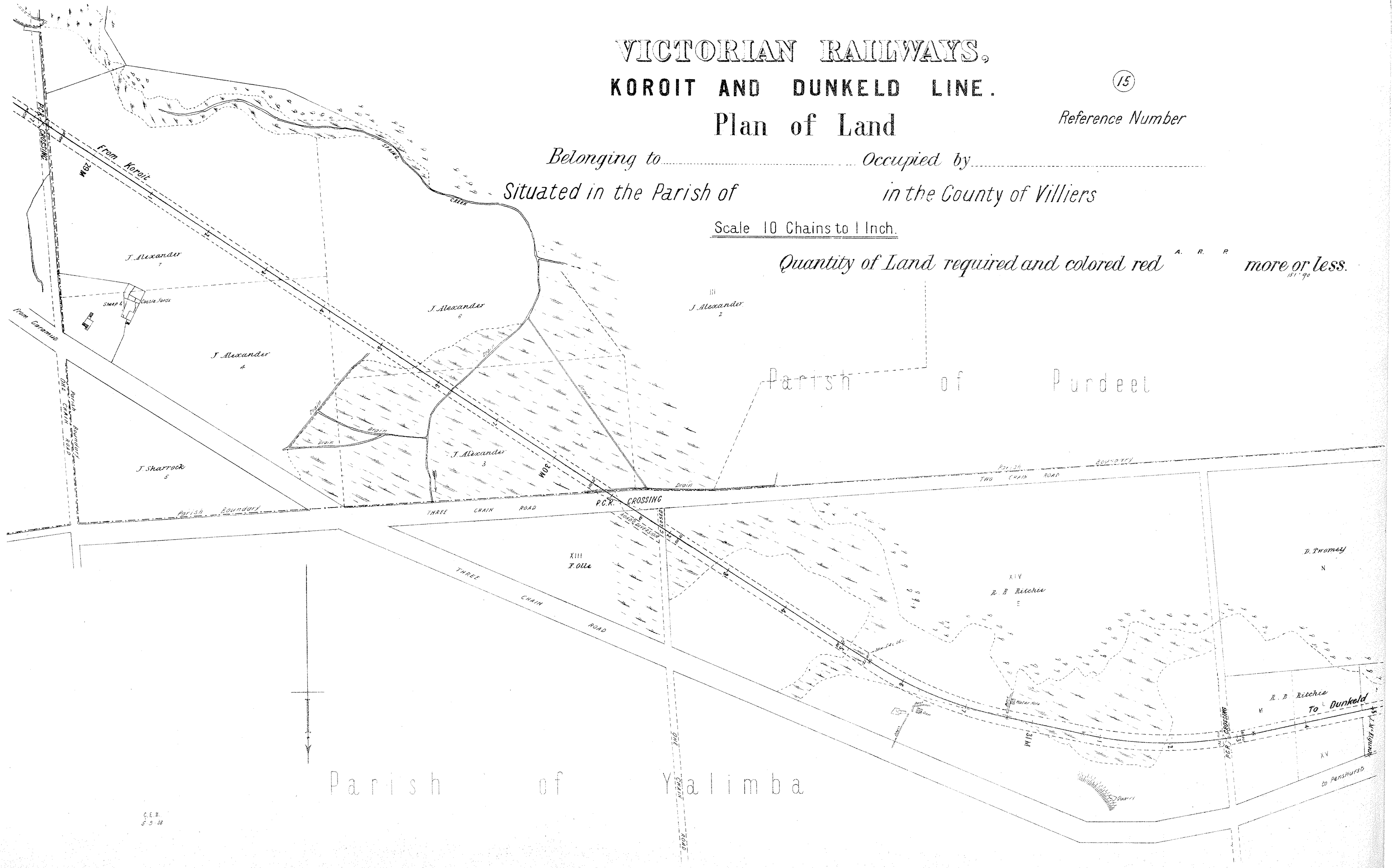

VICTORIAN RAILWAYS, KOROIT AND DUNKELD LINE.

22

Plan of Land

Reference Number

Belonging to..... Occupied by.....
Situating in the Parish of..... in the County of Villiers

Scale 10 Chains to 1 Inch.

Quantity of Land required and colored red A. R. P. more or less.

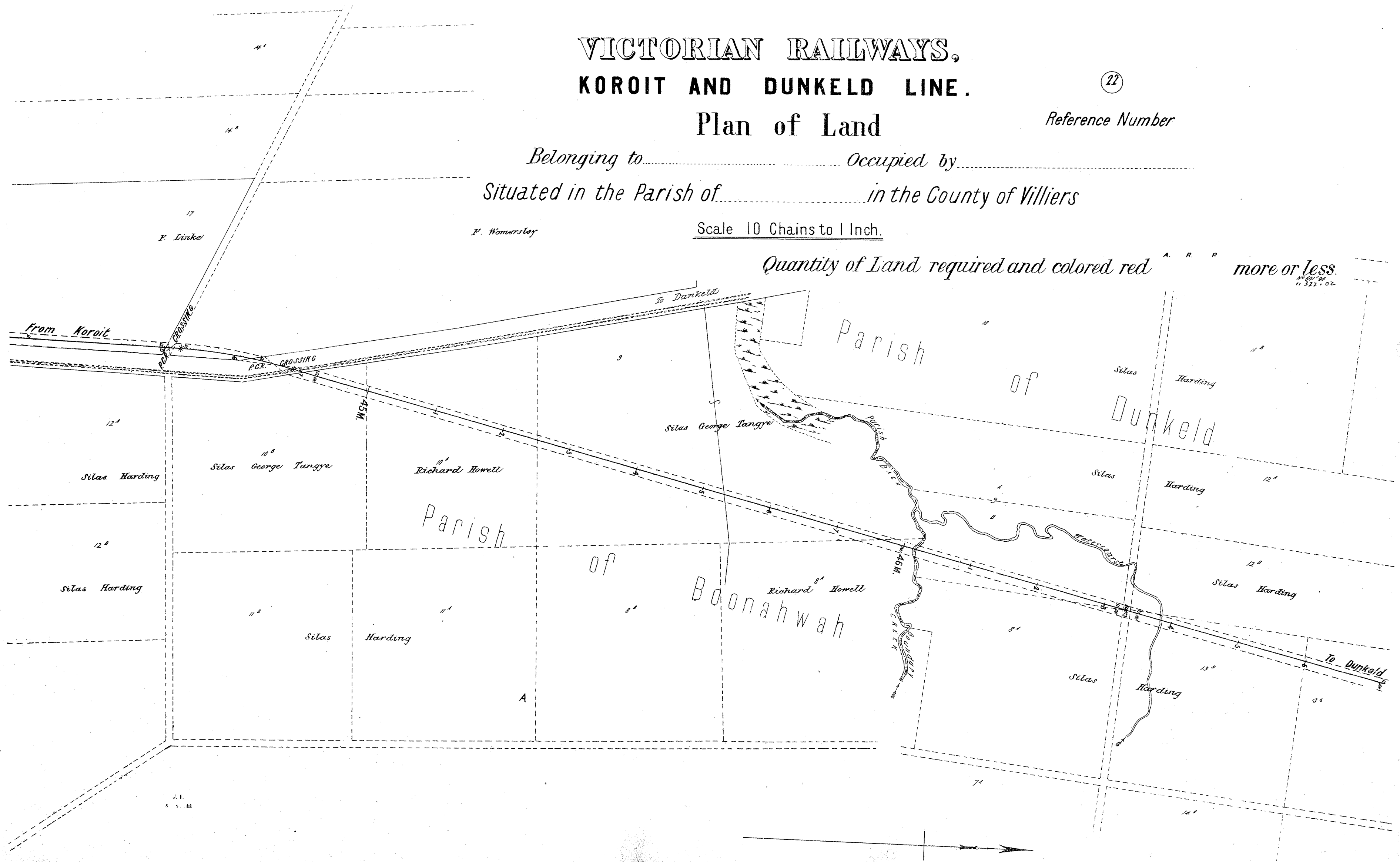

F. Linke

F. Womersley

J. H.
5. 5. 88

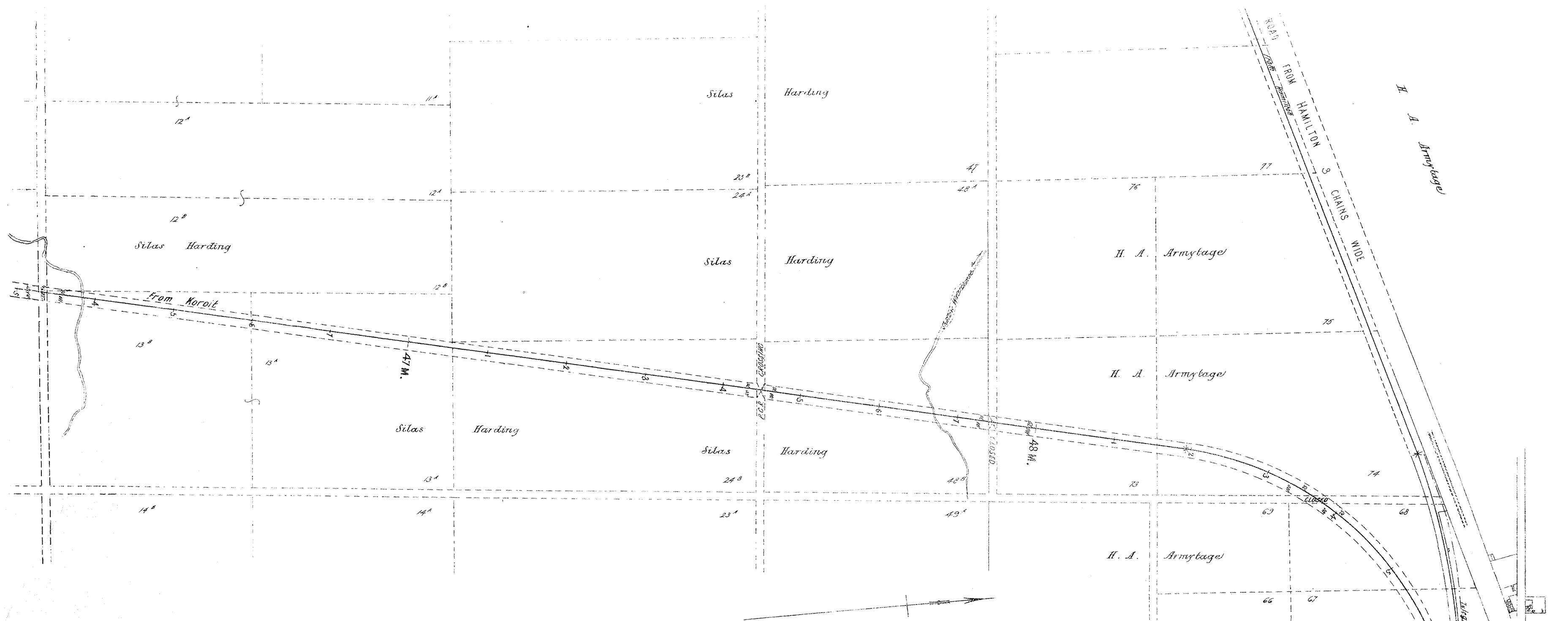

VICTORIAN RAILWAYS,
KOROIT AND DUNKELD LINE.
 Plan of Land

(23)^x

Reference Number

Belonging to Occupied by

Situated in the Parish of Dunkeld in the County of Villiers

Scale 10 Chains to 1 Inch

Quantity of Land required and colored red ^A ^R ^P more or less.