

VICTORIAN RAILWAYS.

BRIGHTON AND PICNIC POINT LINE.

SCALE. 4 CHAINS TO AN INCH.

CONTRACT N^o 2418.
N^o 1. *

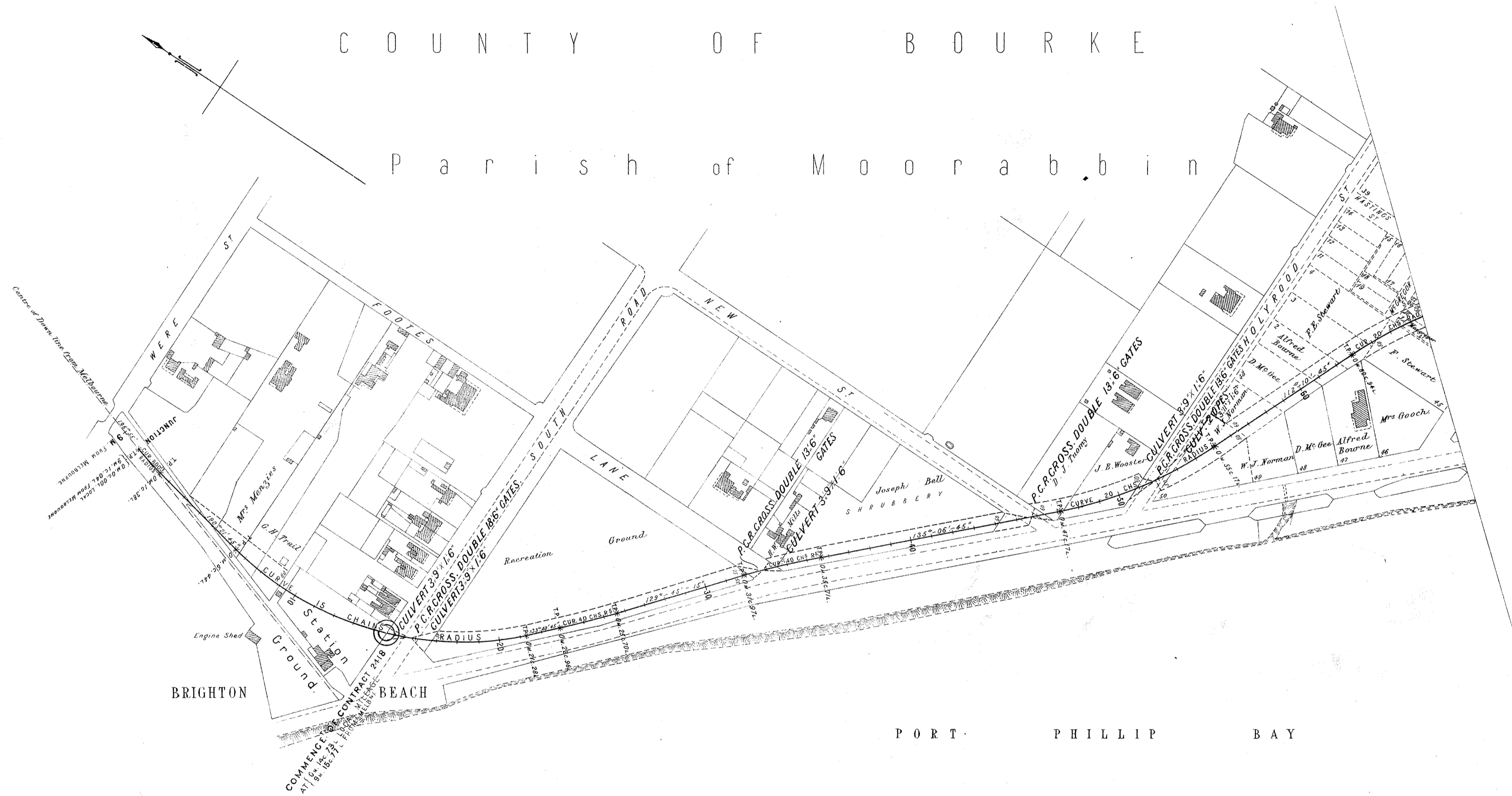

We accept this as one of the Drawings referred to in the
 Specification and Conditions upon which *we*.....based
 our Tender Dated the 3rd day of May 1886
 Signature of Contractor: *W. J. ...*
 Witness to Signature: *...*
 Date: 19/5/86

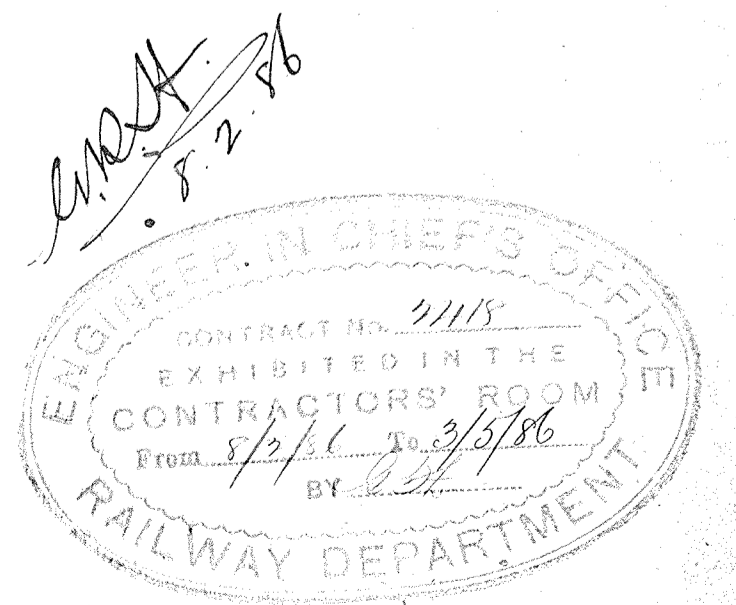

VICTORIAN RAILWAYS.

BRIGHTON AND PICNIC POINT LINE.

SCALE. 4 CHAINS TO AN INCH.

CONTRACT NO 2418.
NO 2.*

C O U N T Y O F B O U R K E

P a r i s h o f M o o r a b b i n

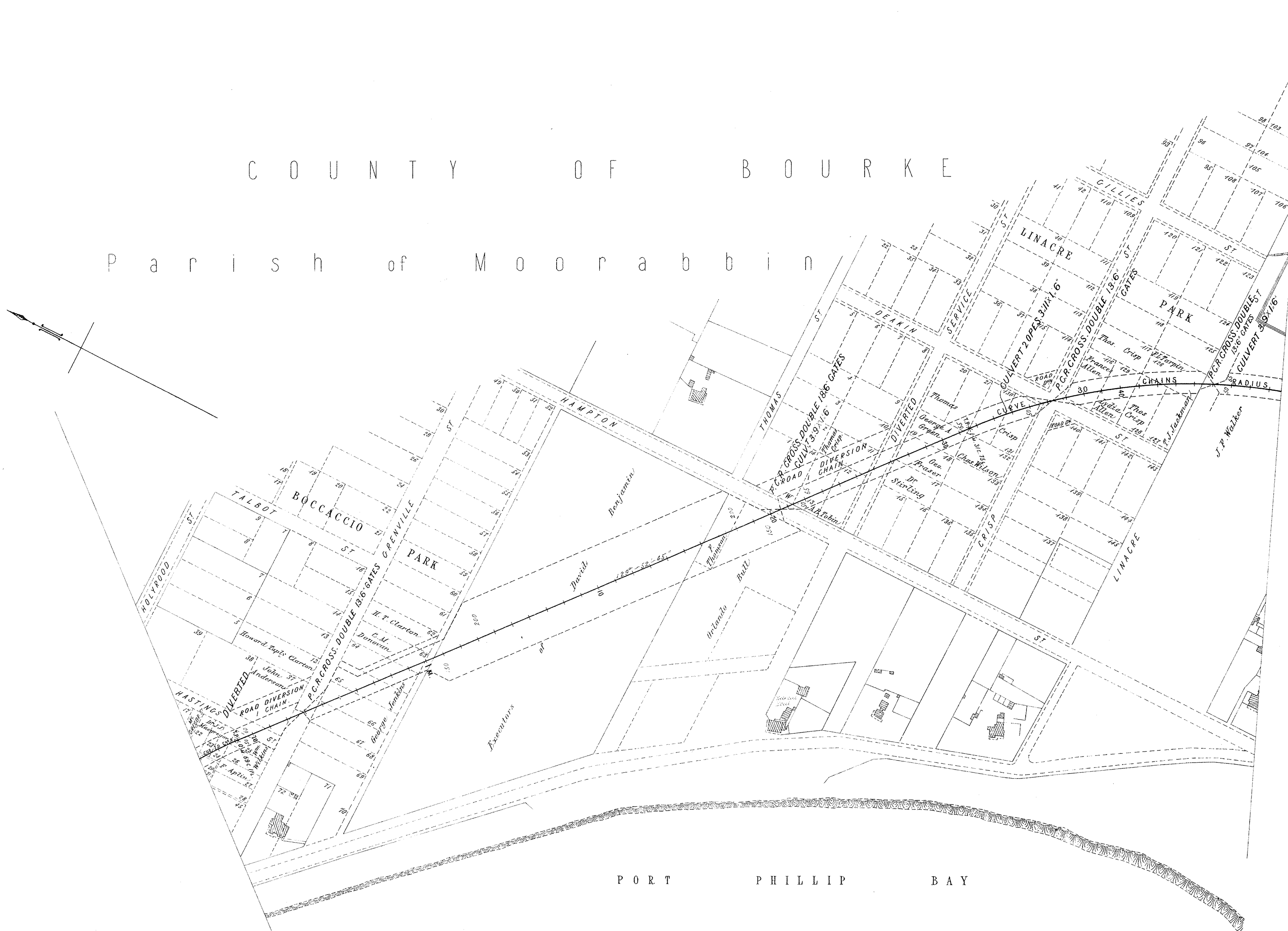

P O R T P H I L L I P B A Y

I accept this as one of the Drawings referred to in the
 Specification and Conditions upon which I am based
 and I agree to the same. Dated the 30th day of May 1886
 Signature of Contractor *W. A. Graham*
 Witness to Signature *C. Wright*
 Date 19/5/86

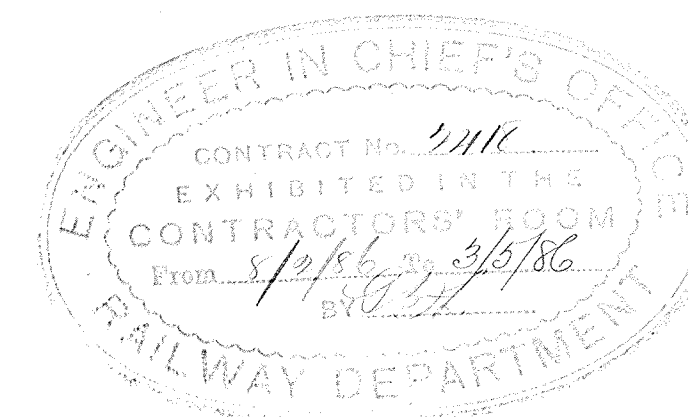

VICTORIAN RAILWAYS. BRIGHTON AND PICNIC POINT LINE.

SCALE. 4 CHAINS TO AN INCH.

CONTRACT NO 2418
NO 3.*



We accept this as one of the Drawings referred to in the Specification and Conditions upon which *we* based our Tender Dated the *30th* day of *May 1886*.
Signature of Contractor *W. J. Graham and W. J. Wicks*
Witness to Signature *W. J. Wicks*
Date *19/5/86*

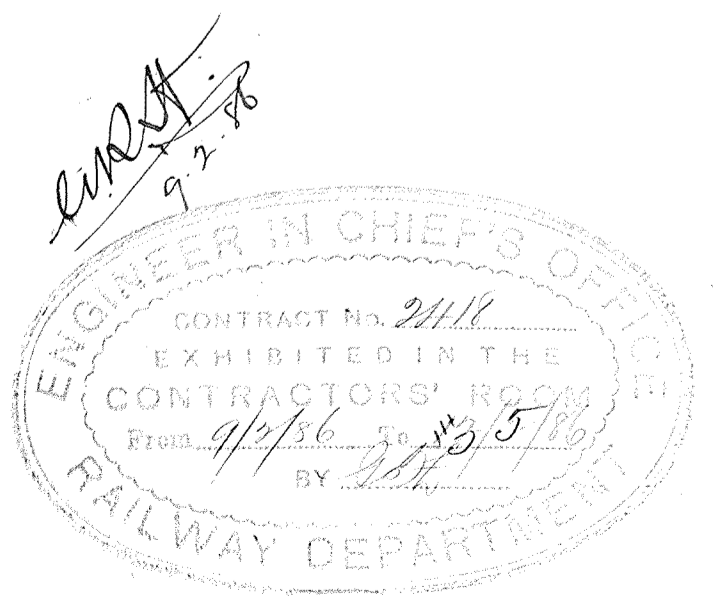

VICTORIAN RAILWAYS.

BRIGHTON AND PICNIC POINT LINE.

1. ^{xx}

Reference Number

Plan of Land

Belonging to Occupied by

Situated in the Parish of Moorabbin in the County of Bourke

Scale, 4 Chains to 1 inch.

Quantity of Land required and colored red ^{A. R. P.} more or less. _{1430 90.}

P a r i s h o f M o o r a b b i n

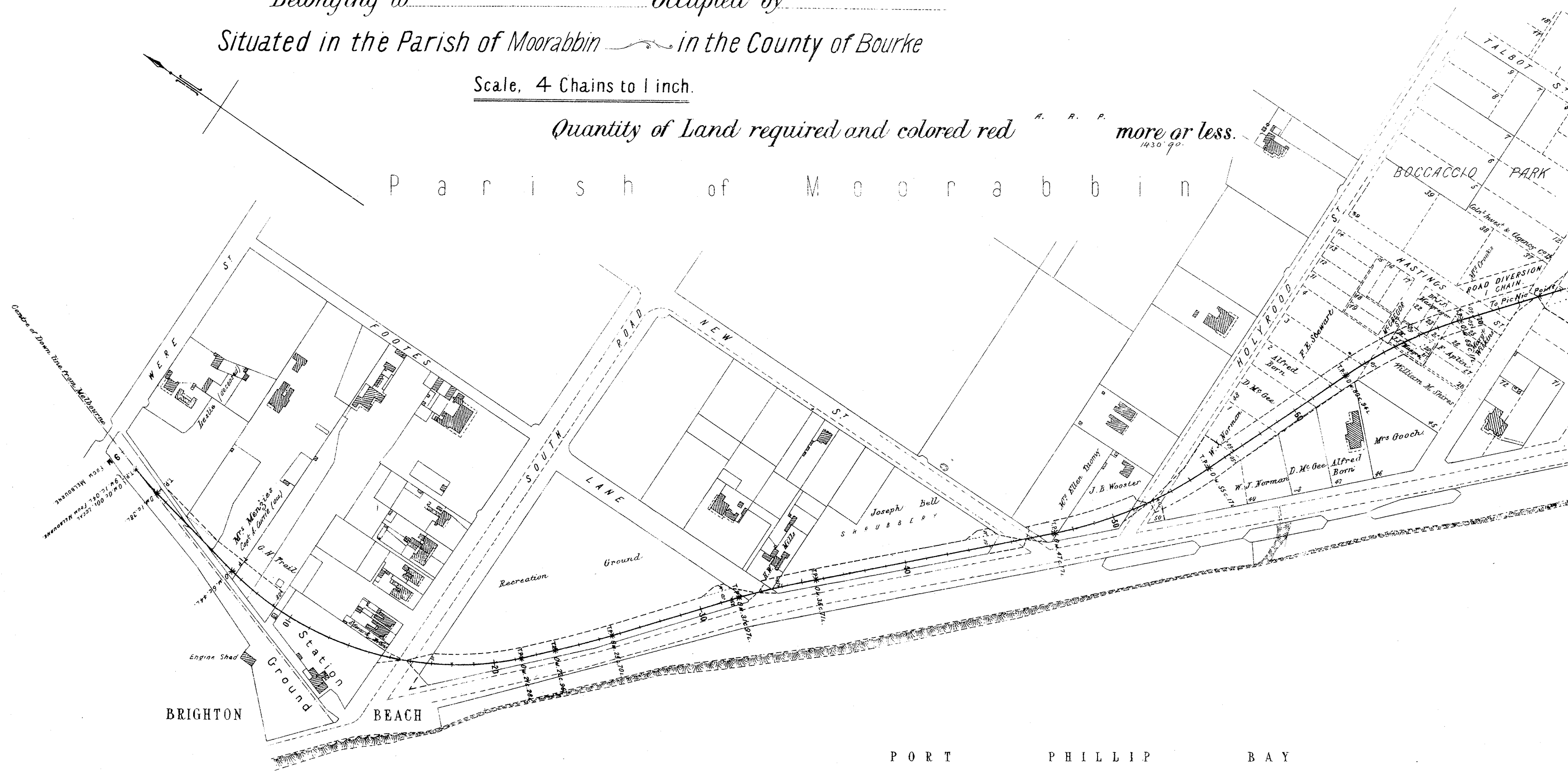

P O R T P H I L L I P B A Y

VICTORIAN RAILWAYS.

BRIGHTON AND PICNIC POINT LINE.

(2.)

Plan of Land

Reference Number

Belonging to Occupied by

Situated in the Parish of Moorabbin in the County of Bourke

Scale, 4 Chains to 1 inch.

Quantity of Land required and colored red A. P. P. more or less.

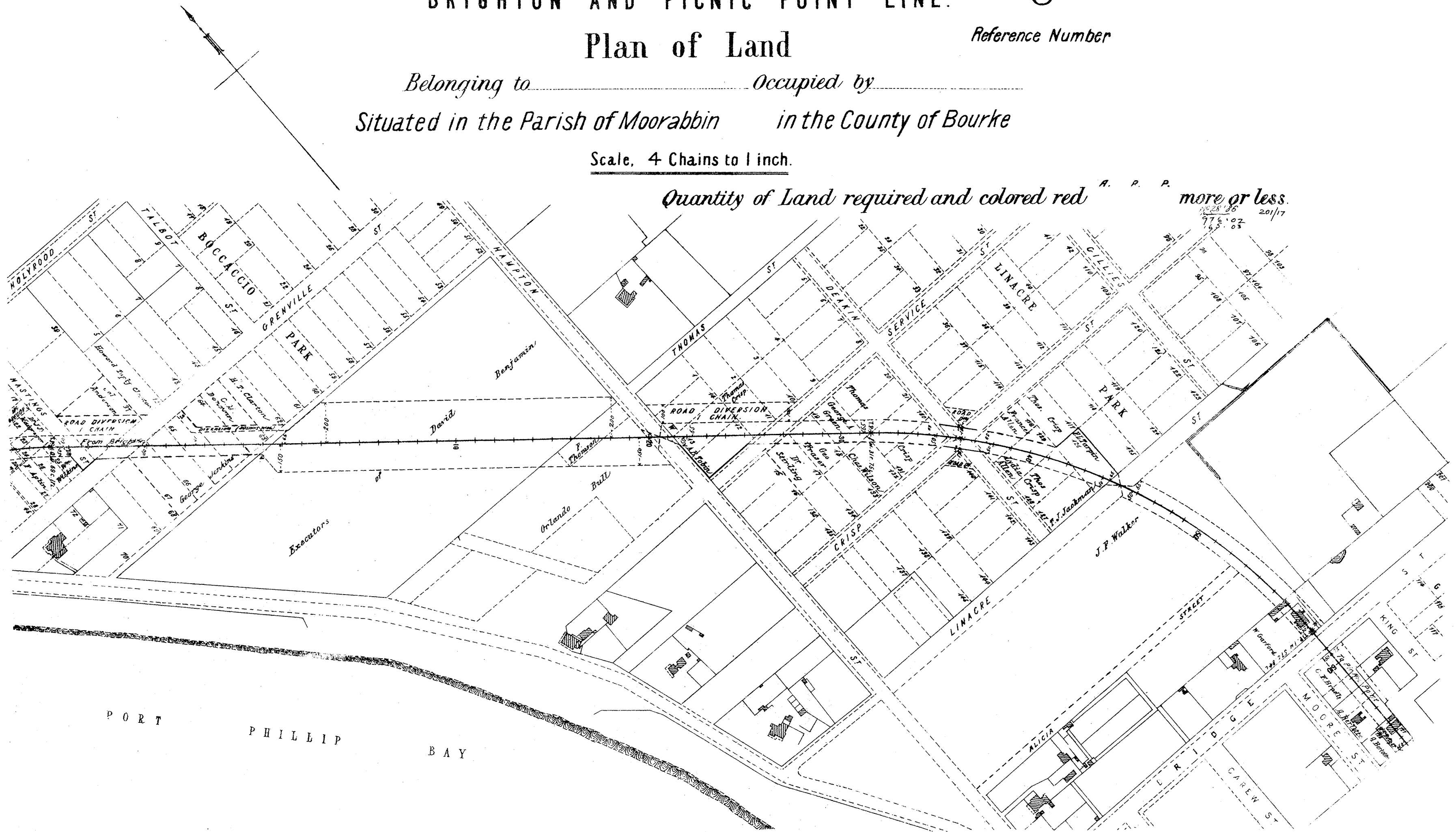

VICTORIAN RAILWAYS.

BRIGHTON AND PICNIC POINT LINE.

(3)^{++x}

Plan of Land

Reference Number

Belonging to _____ Occupied by _____

Situated in the Parish of Moorabbin — in the County of Bourke

Scale, 4 Chains to 1 inch.

Quantity of Land required and colored red more or less.

559.90
977.02

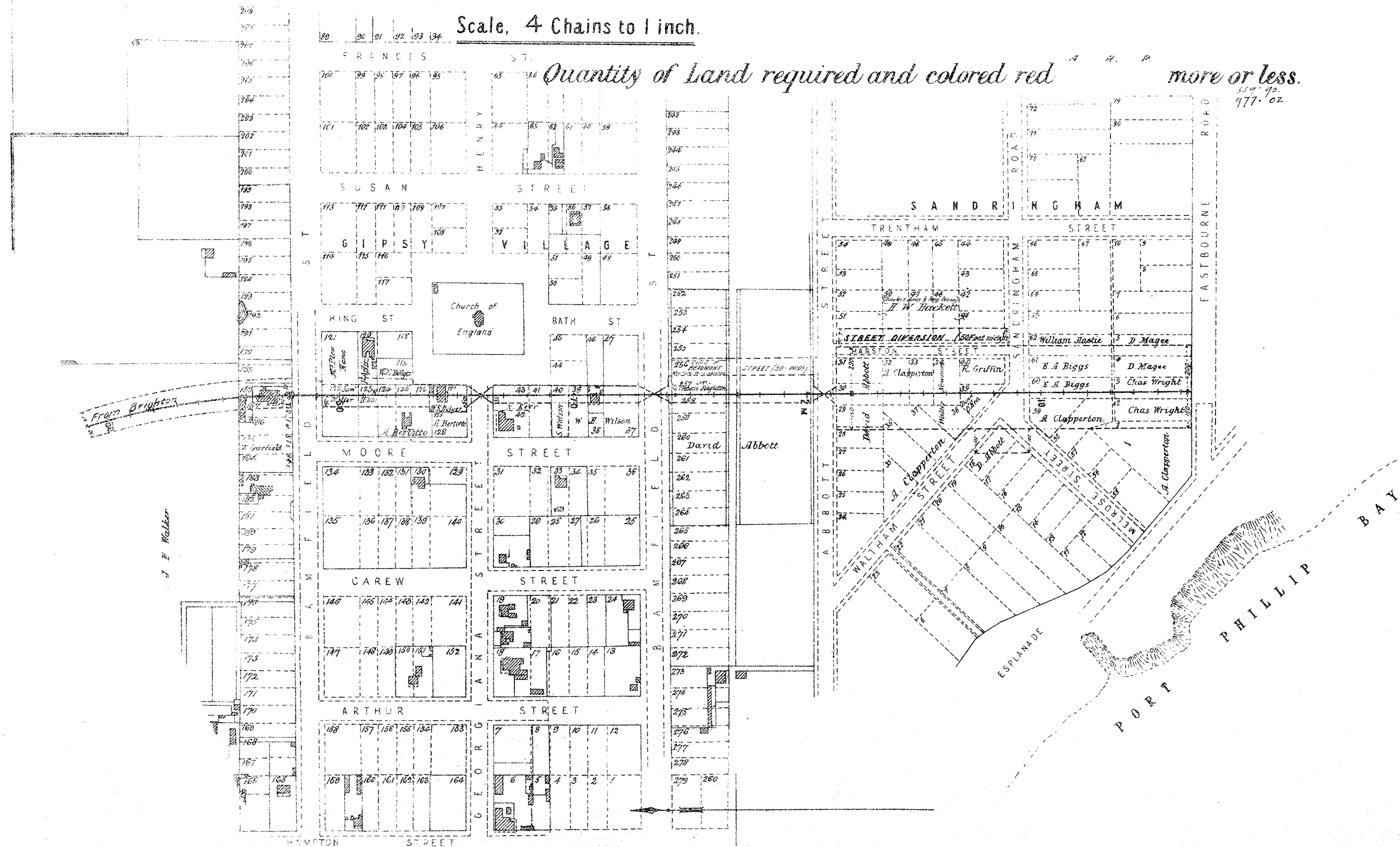
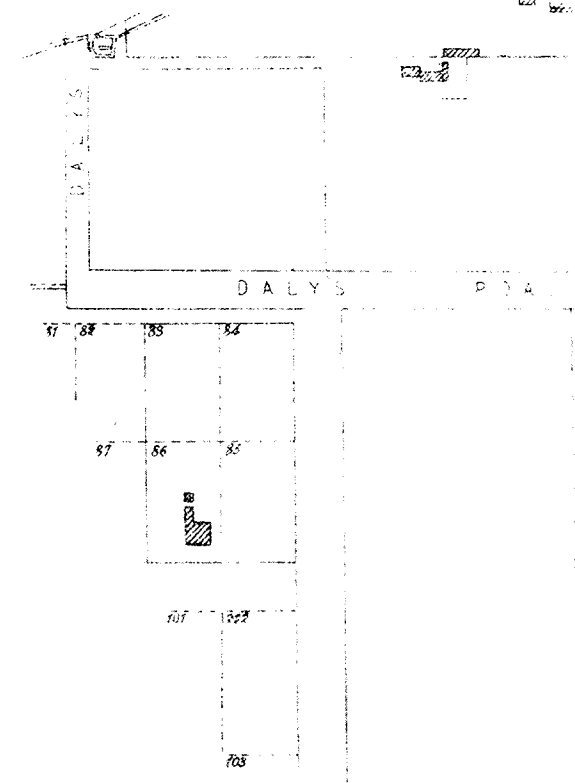

J. F. Walker

From Brighton

David Abbott

STREET DISERSION 150 feet width

ESPLANADE

PHILLIP BAY

BAY



VICTORIAN RAILWAYS, BRIGHTON AND PICNIC POINT LINE.

CONTRACT NO 2418.
NO 1.

SCALES: HORIZONTAL 4 CHAINS TO AN INCH.
VERTICAL 40 FEET TO AN INCH.

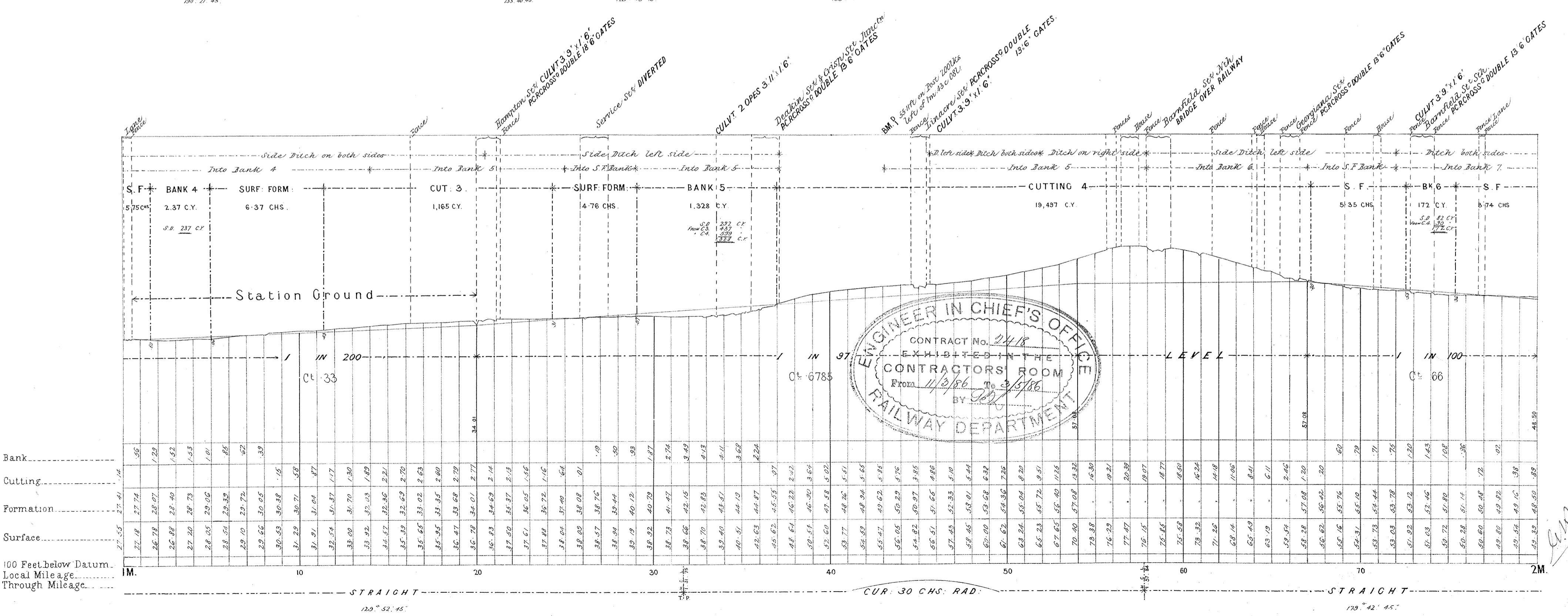
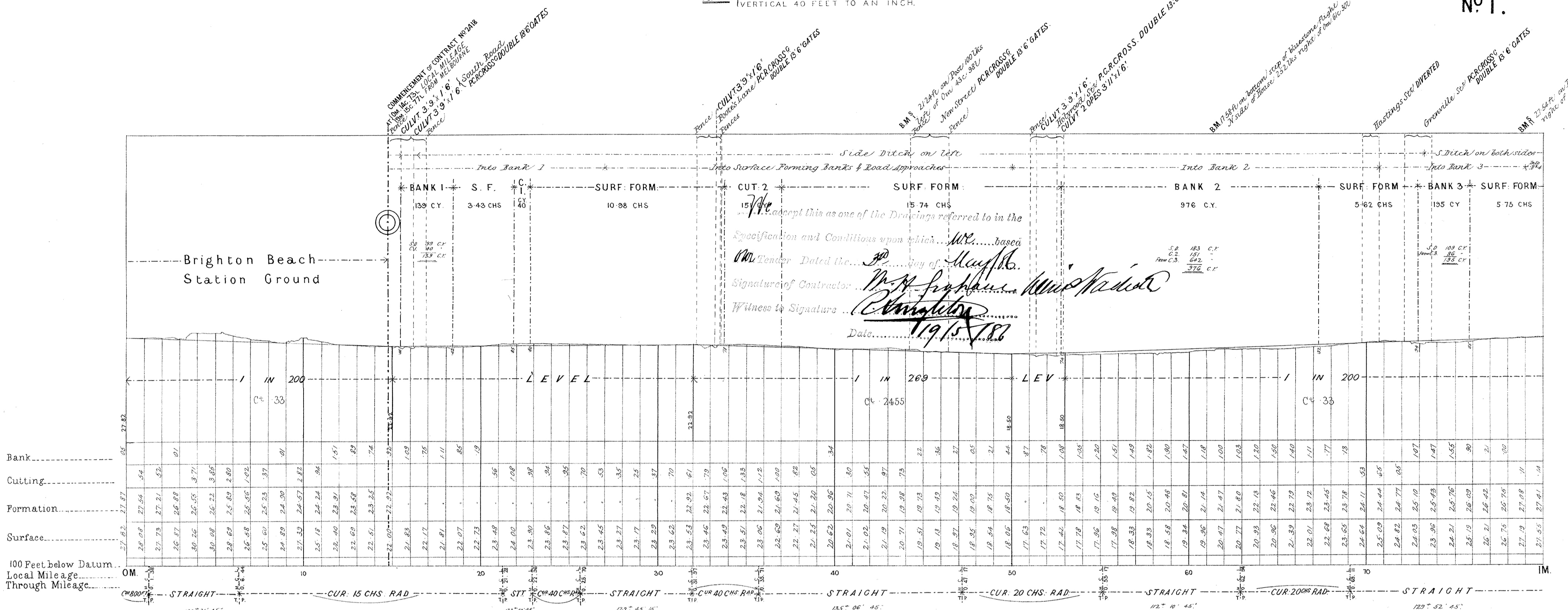

VICTORIAN RAILWAYS.

BRIGHTON AND PICNIC POINT LINE.

SCALES: HORIZONTAL 4 CHAINS TO AN INCH
VERTICAL 40 FEET TO AN INCH.

CONTRACT NO 2418
No 2.

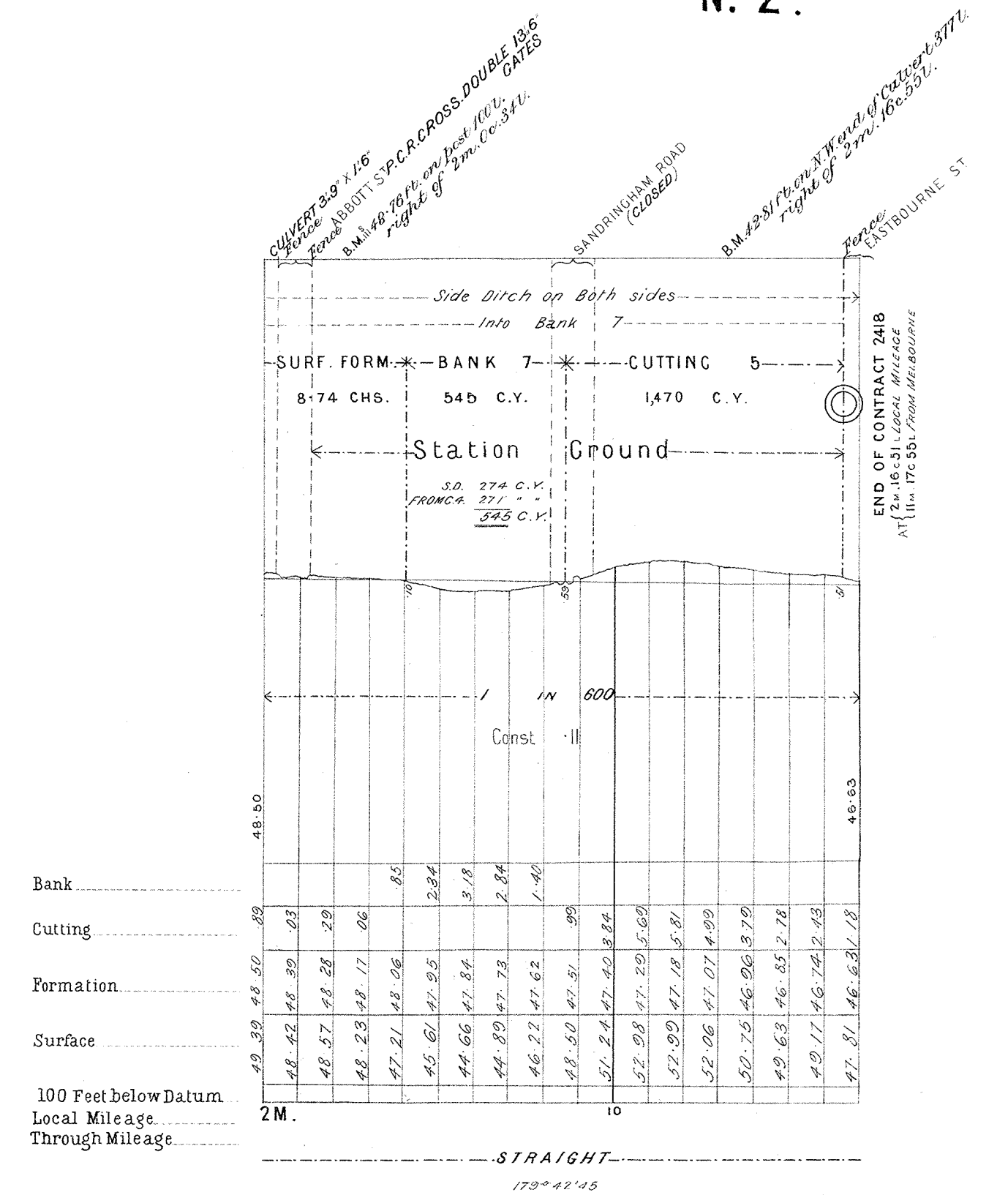

I accept this as one of the Drawings referred to in the Specification and Conditions upon which I am based.

Giver Dated the 30 day of May 1886.

Signature of Contractor *W. A. ...*

Witness to Signature *W. ...*

Date 19/5/1886

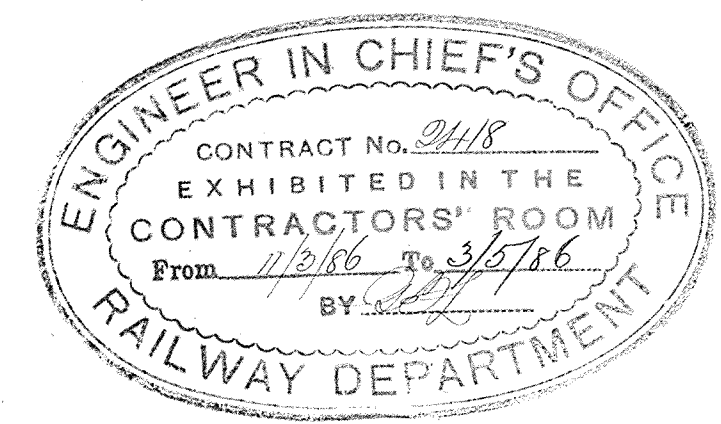

W. A.
1/3/86