

VICTORIAN RAILWAYS, YACKANDANDAH AND BEECHWORTH LINE.

SCALE. 4 CHAINS TO AN INCH

CONTRACT N^o 3650
N^o 1^A



NOTE - Boundaries of Mining Leases shown thus

I accept this as one of the Drawings referred to in the Specification and Conditions upon which.....based My Tender Dated the 2nd day of March 1899
Signature of Contractor *George Pallett*
Witness to Signature *A. Macdonald*
Date..... 20/3/99

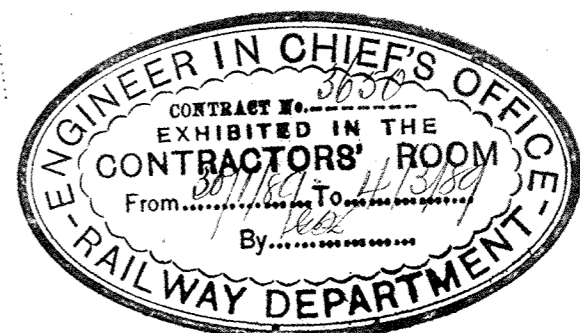

W. St. 20.1.59

VICTORIAN RAILWAYS, YACKANDANDAH AND BEECHWORTH LINE.

SCALE, 10 CHAINS TO AN INCH

CONTRACT No 3650
No 4

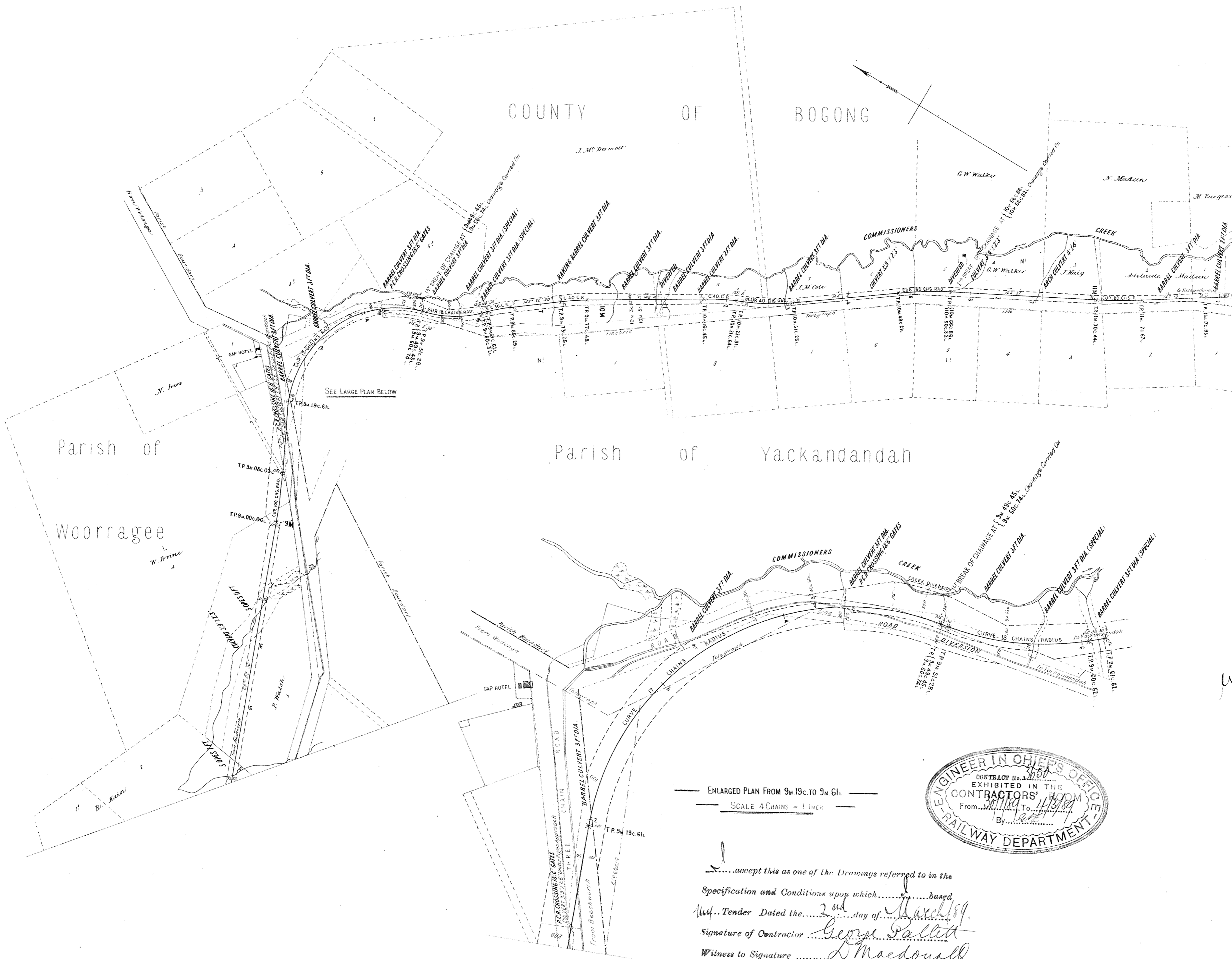

*W.H.H.
30.1.59*

VICTORIAN RAILWAYS, YACKANDANDAH AND BEECHWORTH LINE . ①^x Plan of Land Reference Number

Belonging to Occupied by

Situated in the Parish of Beechworth in the County of Bogong

Scale 10 Chains to 1 Inch.

Quantity of Land required and colored red ^{A. R. P.} more or less. _{1537 '89.}

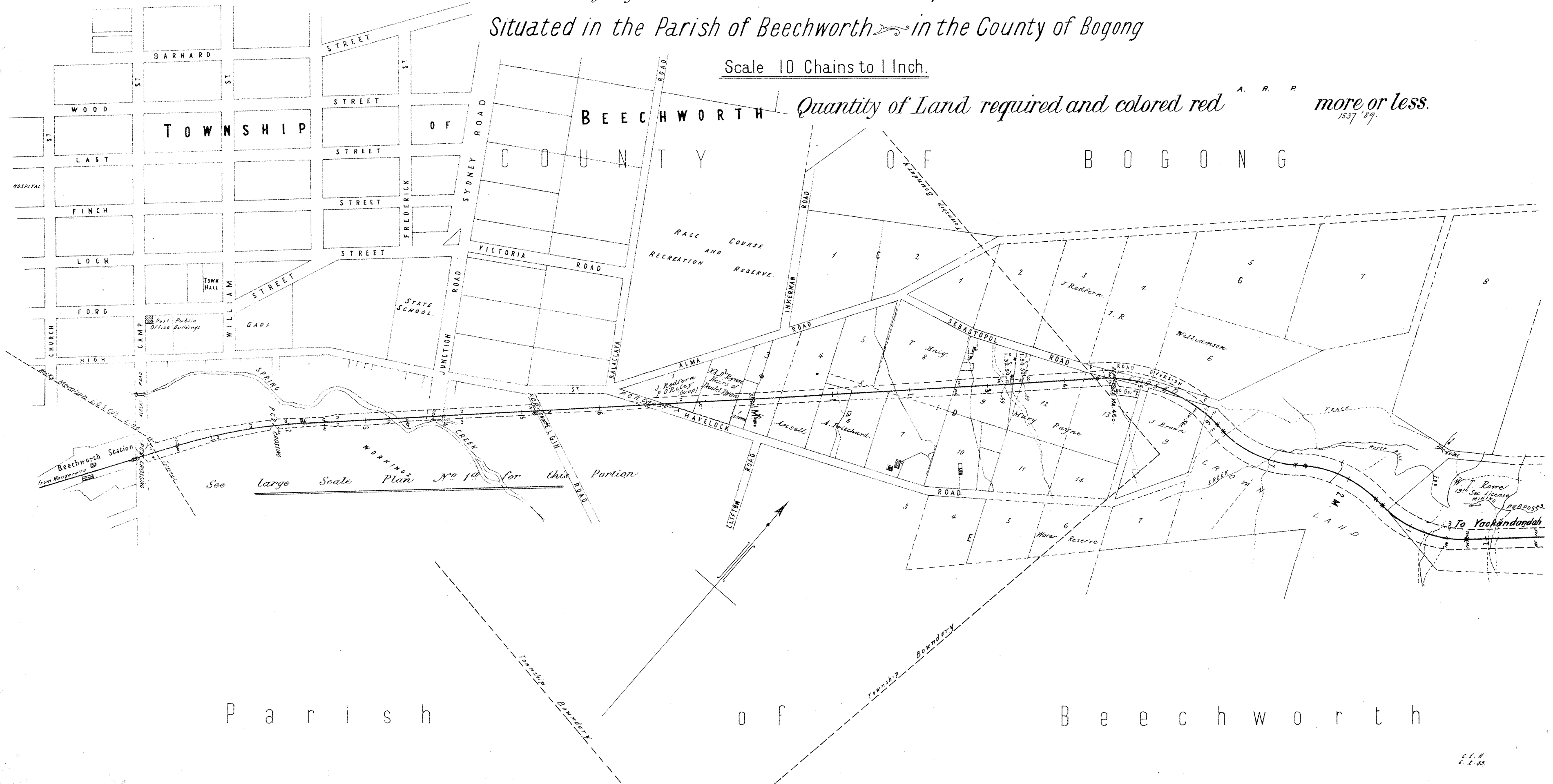

See large Scale Plan No 14 for this Portion

VICTORIAN RAILWAYS, YACKANDANDAH AND BEECHWORTH LINE.

(1A)^x

Reference Number

Plan of Land

Belonging to..... Occupied by.....

Situated in the Parish of Beechworth in the County of Bogong

BOTANICAL Scale 4 Chains to 1 Inch.

Quantity of Land required and colored red

more or less.
1544'89

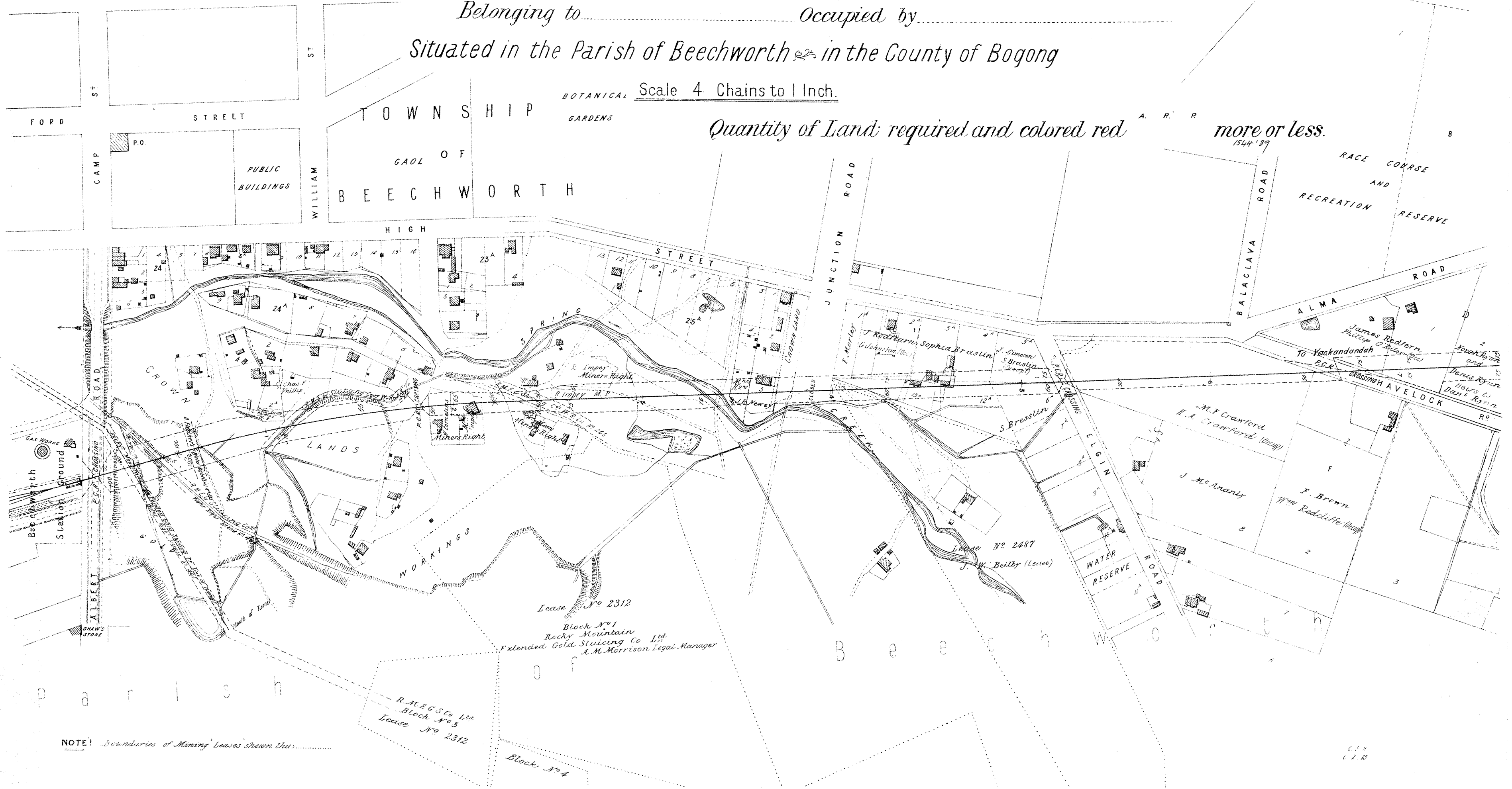

NOTE! Boundaries of Mining Leases shown thus.....

R.M.B.C. Co Ltd
Block No 5
Lease No 2312

Lease No 2312
Block No 1
Recky Mountain
Extended Gold Stamping Co Ltd
A.M. Morrison Legal Manager

Block No 4

62 1/2

VICTORIAN RAILWAYS, YACKANDANDAH AND BEECHWORTH LINE. ②^x

Plan of Land

Reference Number

Belonging to Occupied by

Situated in the Parish of in the County of Bogong

Scale 10 Chains to 1 Inch.

Quantity of Land required and colored red ^{A. R. R.} more or less.
1545 '89.

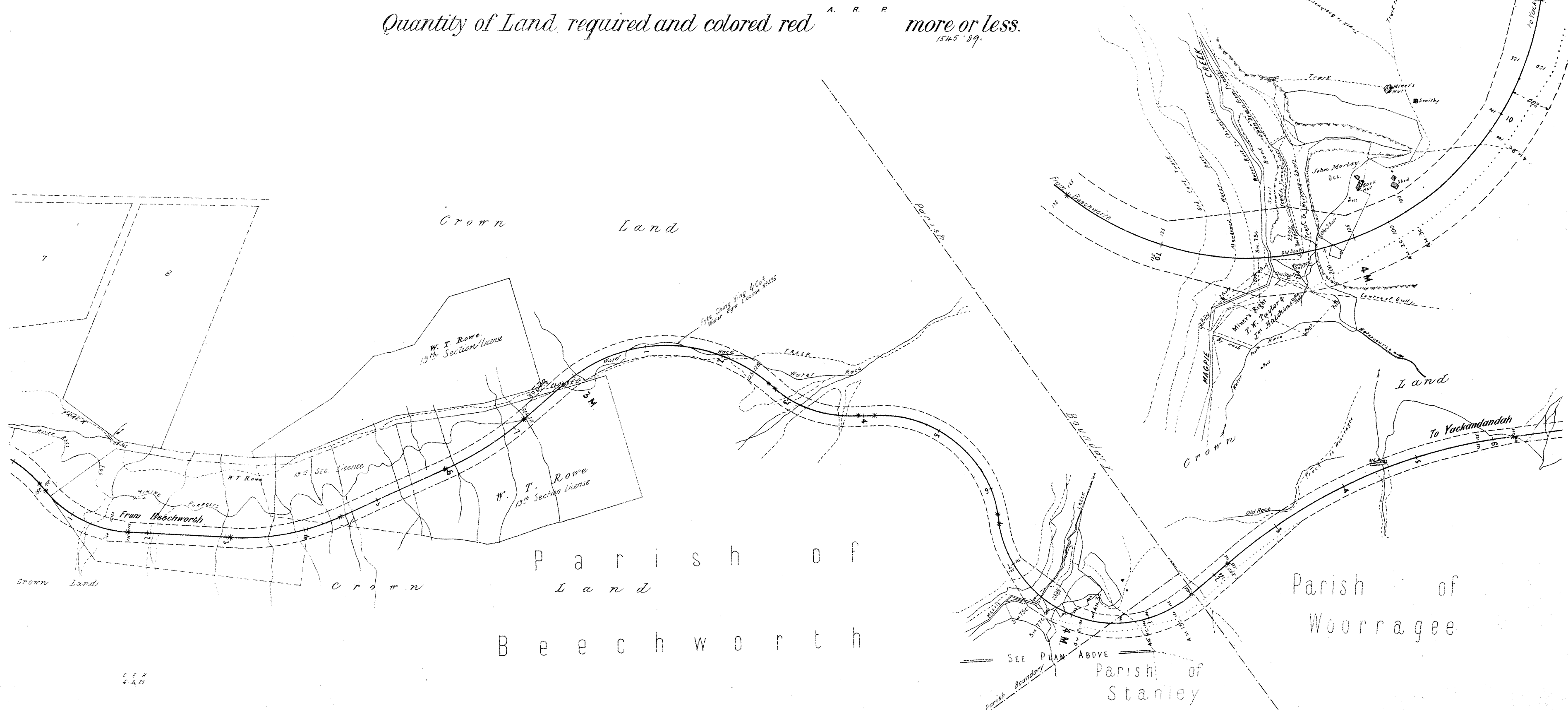
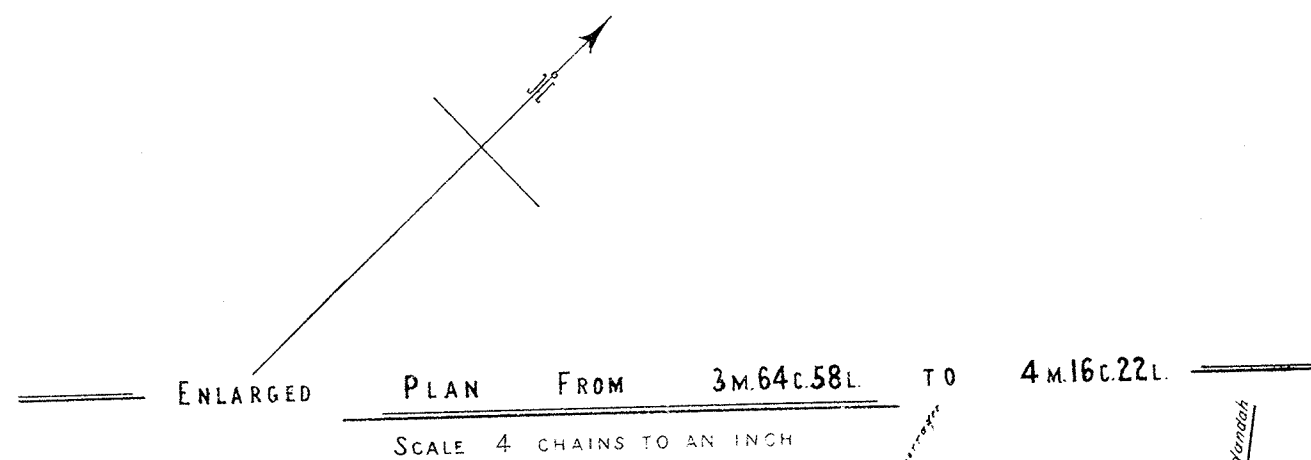

VICTORIAN RAILWAYS, YACKANDANDAH AND BEECHWORTH LINE . ②^x

Plan of Land

Reference Number

Belonging to Occupied by

Situated in the Parish of in the County of Bogong

Scale 10 Chains to 1 Inch.

Quantity of Land required and colored red ^{A. R. P.} more or less.
1545 89.

ENLARGED PLAN FROM 3M.64c.58L. TO 4M.16c.22L.
SCALE 4 CHAINS TO AN INCH

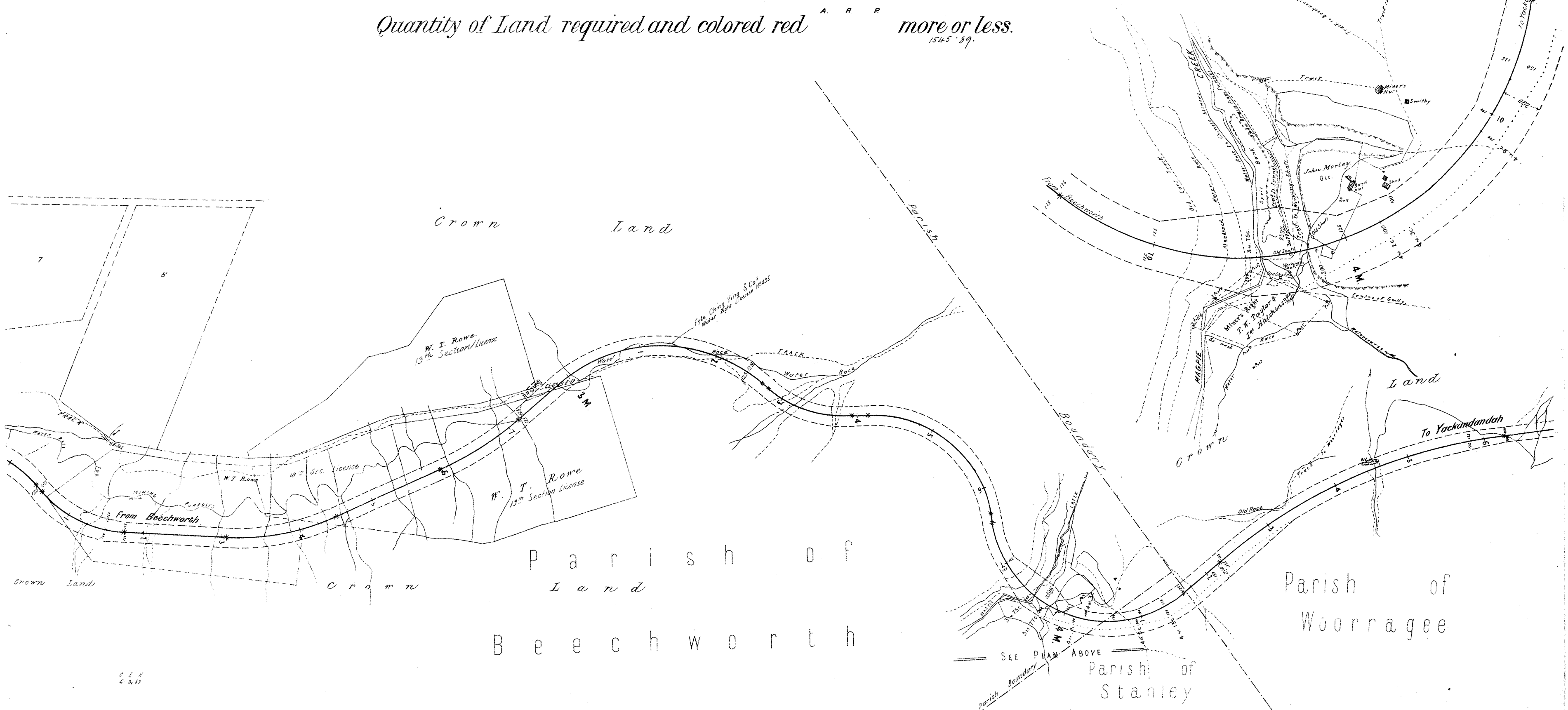

VICTORIAN RAILWAYS, YACKANDANDAH AND BEECHWORTH LINE . ③^x

Plan of Land

Reference Number

Belonging to..... Occupied by.....

Situated in the Parish of Woorragee in the County of Bogong

Scale 10 Chains to 1 Inch.

Quantity of Land required and colored red ^{A. R. P.} more or less.
1546' 89.

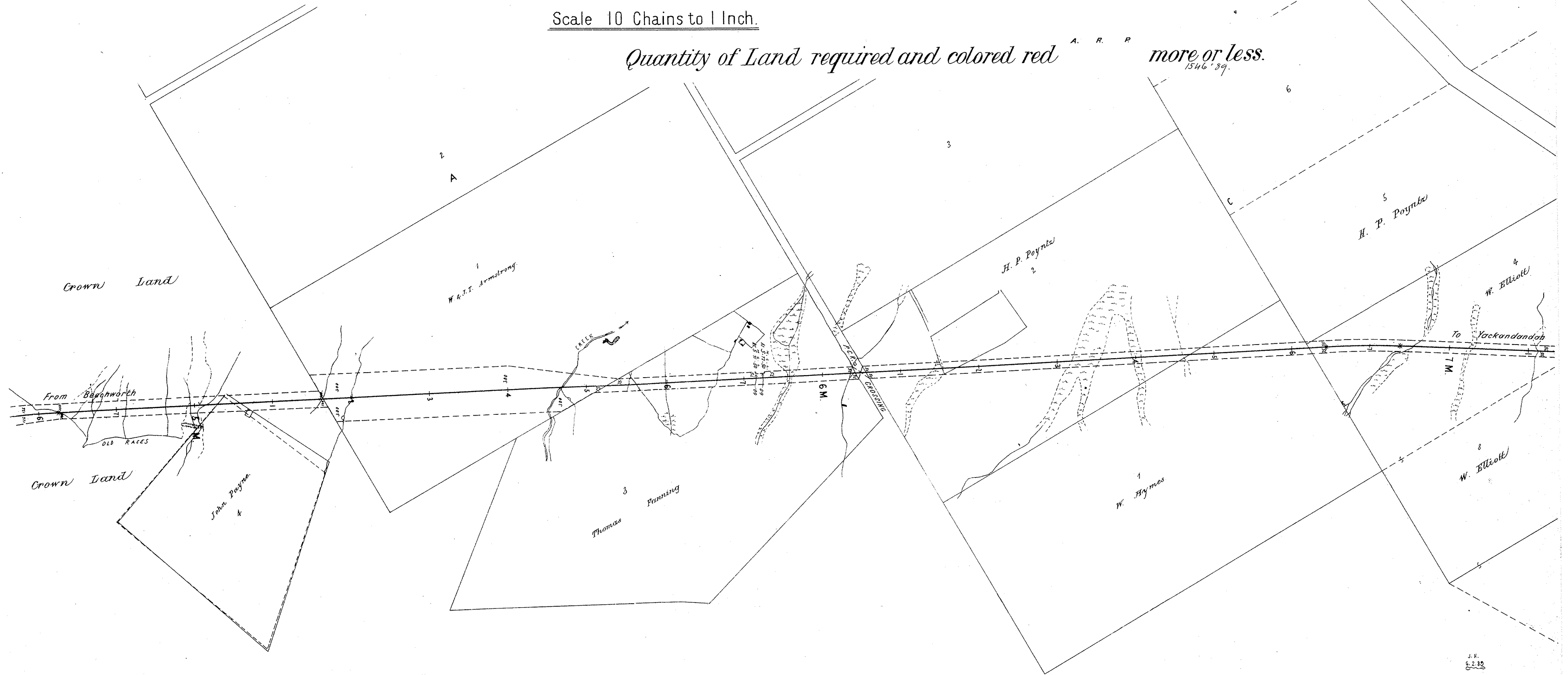

VICTORIAN RAILWAYS, YACKANDANDAH AND BEECHWORTH LINE . ④

Plan of Land

Reference Number

Belonging to..... Occupied by.....

Situated in the Parish of Woorragee in the County of Bogong

Scale 10 Chains to 1 Inch.

Quantity of Land required and colored red

more or less.
1547 '89.

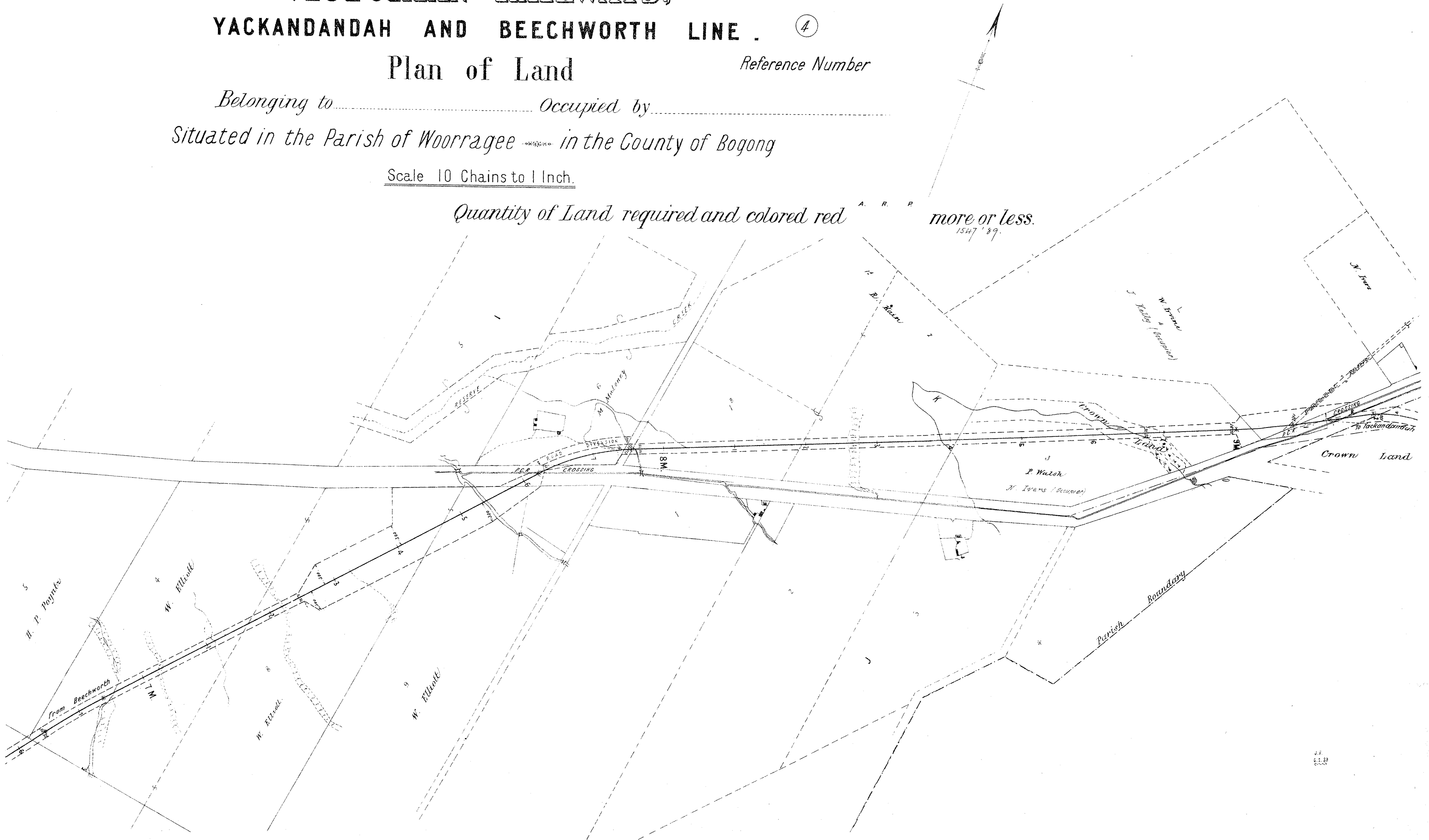

VICTORIAN RAILWAYS, YACKANDANDAH AND BEECHWORTH LINE . (5)

Plan of Land

Reference Number

Belonging to Occupied by
Situating in the Parish of in the County of Bogong

Scale 10 Chains to 1 Inch.

Quantity of Land required and colored red ^{A. R. P.} more or less.
1548' 89.

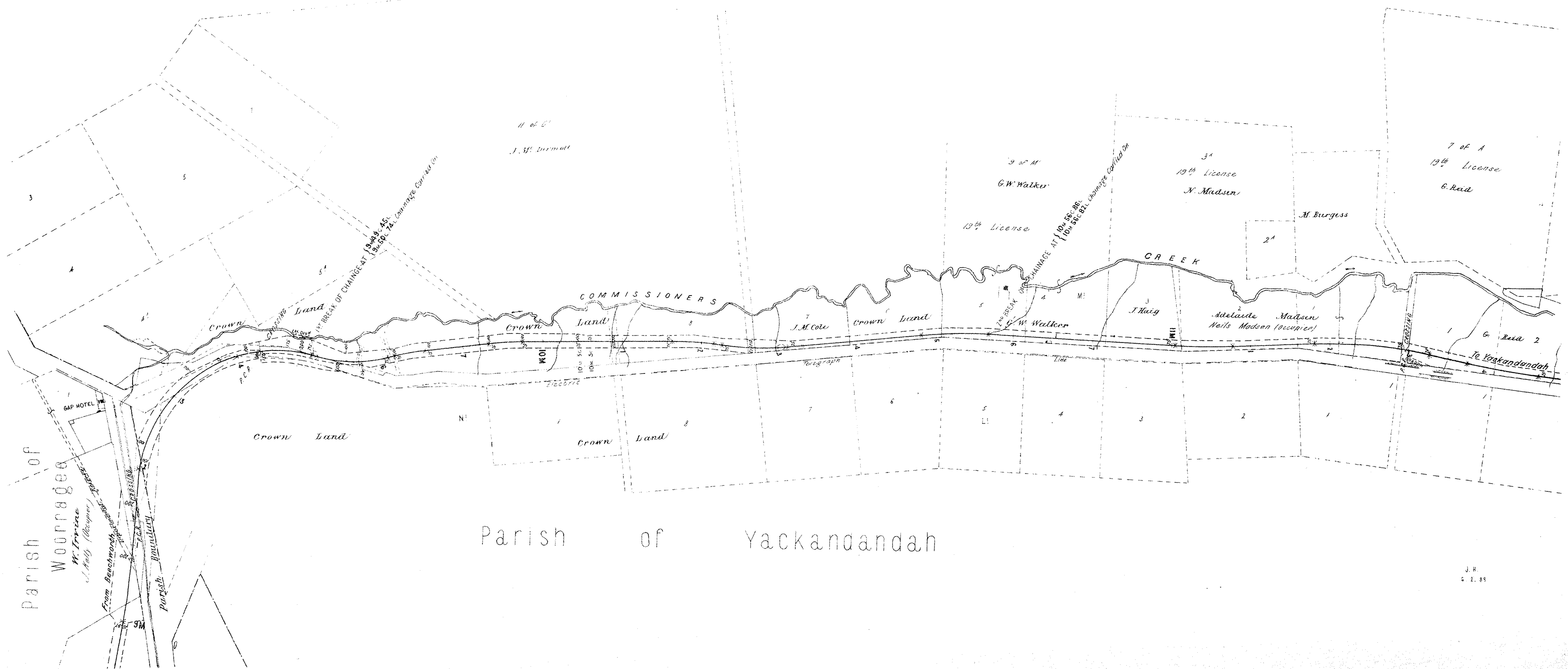
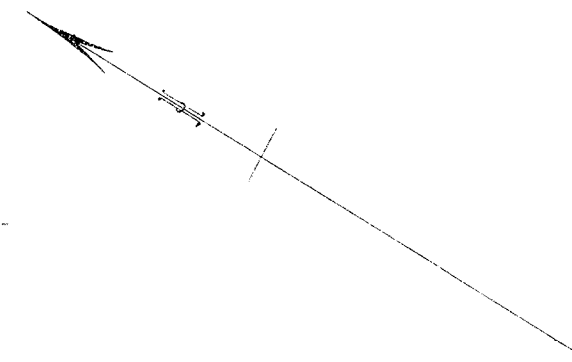

NOTE - Contractors must form their own judgment as to the nature of the excavations shown, and other information shown on these Sections are derived from the Surveyors' notes but are not guaranteed as correct, and the Corporation will not incur any responsibility in respect thereof.

The figures under the description of the Curves at the bottom of the Section denote the super-elevation of the outer rail; Speed 30 miles an hour.

VICTORIAN RAILWAYS, YACKANDANDAH AND BEECHWORTH LINE

SCALES: (HORIZONTAL) 4 CHAINS TO AN INCH.
(VERTICAL) 40 FEET TO AN INCH.

...accept this as one of the Drawings referred to in the Specification and Conditions upon which...
Tender Dated the 2nd day of July 1889
Signature of Contractor *George Pallitt*
Witness to Signature *D. Macdonald*
Date *2/10/89*
CONTRACT N° 3650
N° 1

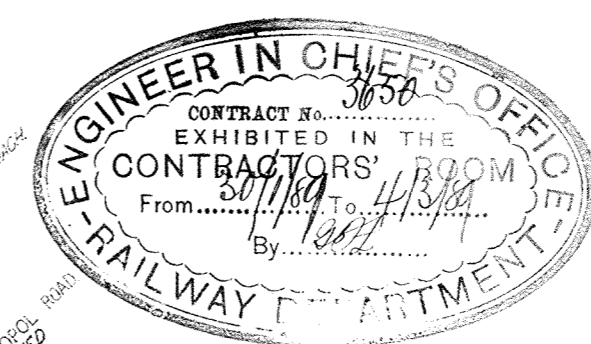
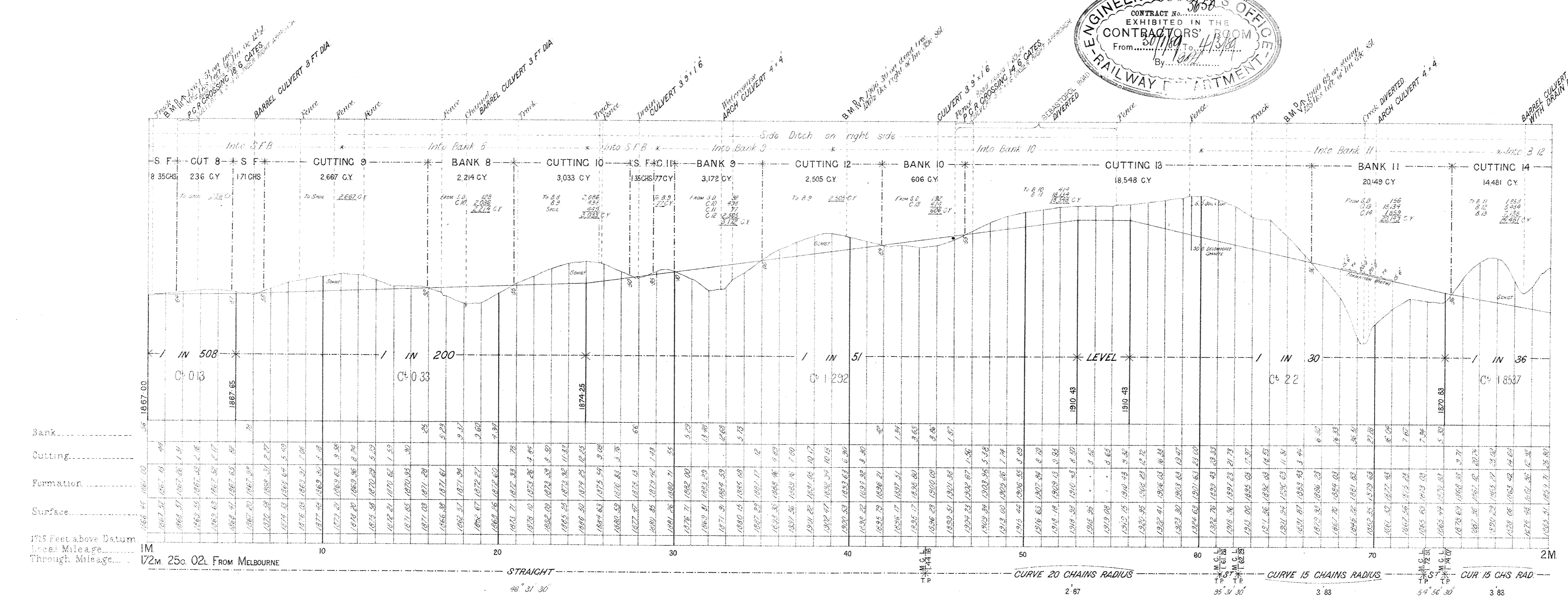
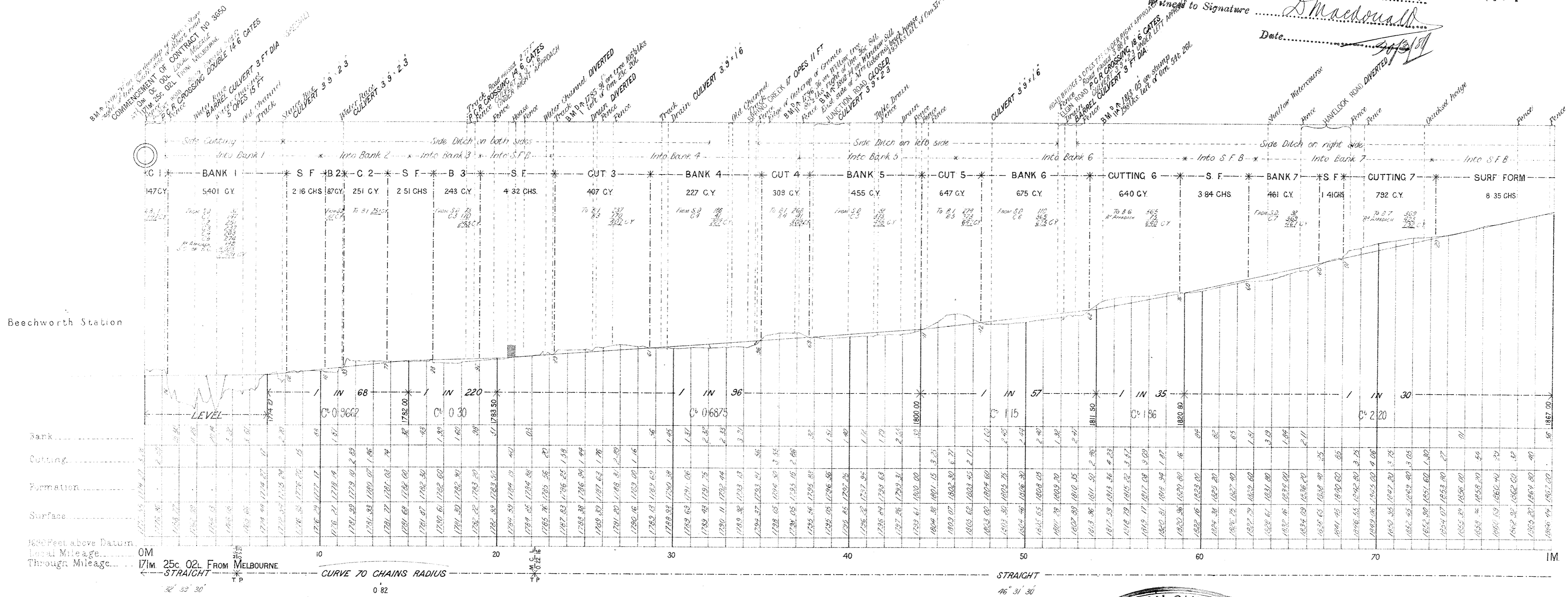

W.R.H.
20.1.59

VICTORIAN RAILWAYS, YACKANDANDAH AND BEECHWORTH LINE.

CONTRACT N^o 3650
N^o 3

SCALES (HORIZONTAL 4 CHAINS TO AN INCH.
VERTICAL 40 FEET TO AN INCH.

NOTE—Contractors must form their own judgment as to the nature of the Excavations, Borings and other information shown on these Sections are derived from the Surveyors' notes but are not guaranteed as correct, and the Corporation will not incur any responsibility in respect thereof.

The figures under the description of the Curves at the bottom of the Section denote the super-elevation of the outer rail; Speed 30 miles an hour.

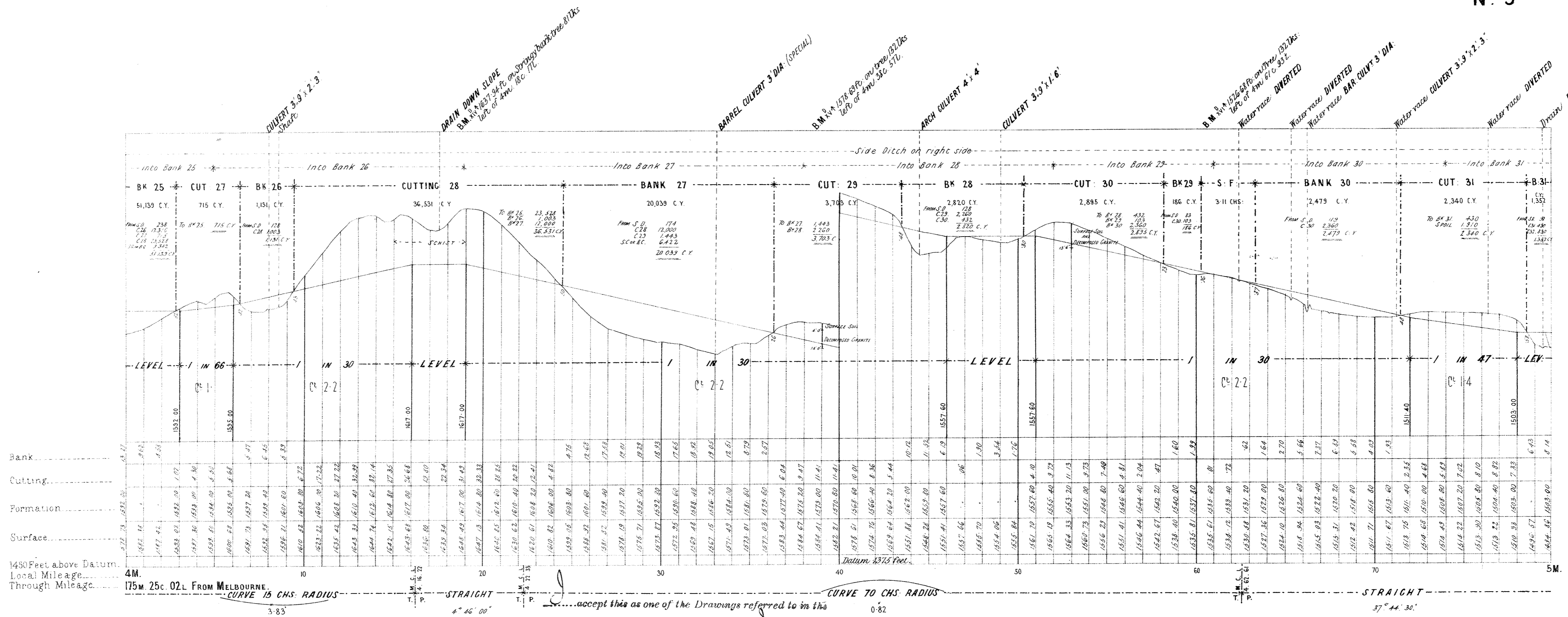

.....accept this as one of the Drawings referred to in the

Specification and Conditions upon which.....based

M. J. Temple Dated the 2nd day of March 1899

Signature of Contractor *George Pallott*

Witness to Signature *J. M. McDonald*

Date..... 30/3/99

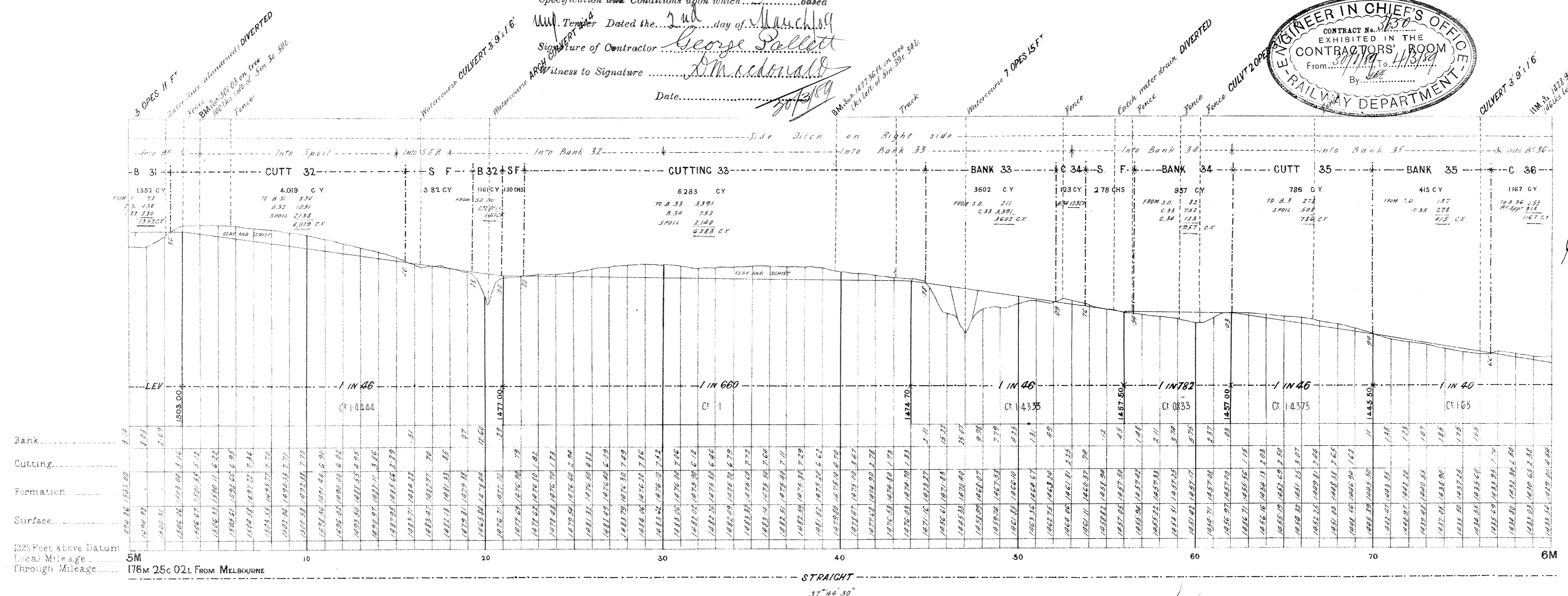

Handwritten signature and date: 30.1.99

Contractors must form their own judgment as to the nature of the Excavations, Springs and other information shown on these Sections are derived from the Surveyors' notes but are not guaranteed as correct, and the Corporation will not incur any responsibility in respect thereof.

The figures under the description of the Curves at the bottom of the Section denote the super-elevation of the outer rail; Speed 30 miles an hour.

VICTORIAN RAILWAYS, YACKANDANDAH AND BEECHWORTH LINE.

SCALES: HORIZONTAL 4 CHAINS TO AN INCH.
VERTICAL 40 FEET TO AN INCH.

CONTRACT N^o 3650
N^o 4

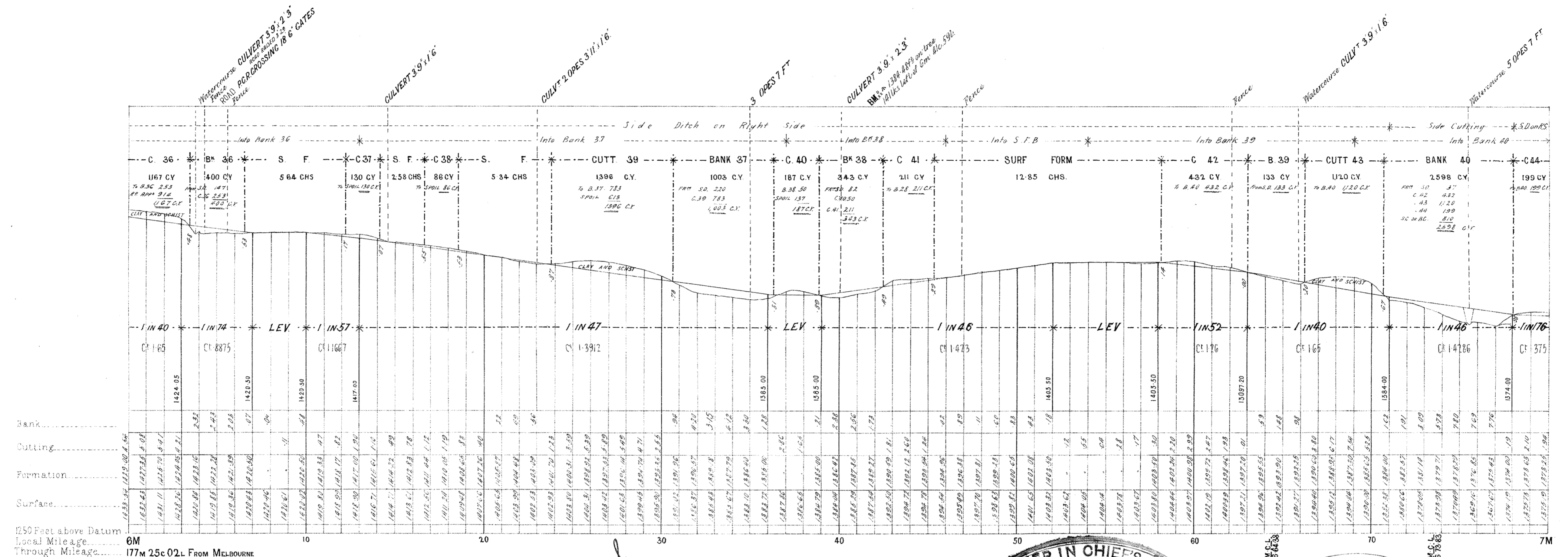

1250 Feet above Datum
Local Mileage..... 6M
Through Mileage..... 177m 25c 02L FROM MELBOURNE

I accept this as one of the Drawings referred to in the Specification and Conditions upon which..... based

My Tender Dated the 2nd day of March 1889

Signature of Contractor *George Pallett*

Witness to Signature *George Pallett*

Date *10/3/89*

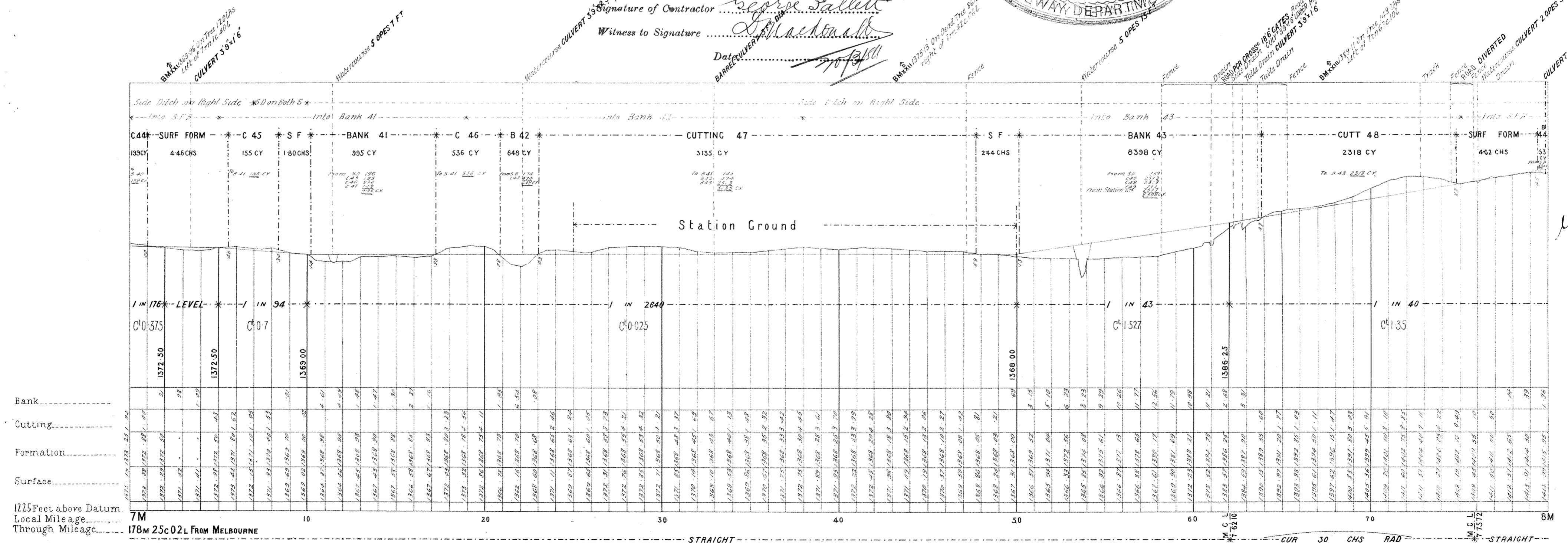

1225 Feet above Datum
Local Mileage..... 7M
Through Mileage..... 178m 25c 02L FROM MELBOURNE

STRAIGHT 43' 2' 30"

CUR 30 CHS RAD 119'

*W.P.T.
30.1.89*

VICTORIAN RAILWAYS, YACKANDANDAH AND BEECHWORTH LINE

**CONTRACT N^o 3650
N^o 5**

NOTE: Contractors must form their own judgment as to the nature of the Excavations, Springs and other information shown on these Sections are derived from the Surveyors notes but are not guaranteed as correct, and the Corporation will not incur any responsibility in respect thereof.

The figures under the description of the Curves at the bottom of the Section denote the super-elevation of the outer rail; Speed 30 miles an hour.

SCALES: (HORIZONTAL 4 CHAINS TO AN INCH.
VERTICAL 40 FEET TO AN INCH.

Specification and Conditions upon which... based
 My Tender Dated the 2nd day of March 1894
 Signature of Contractor *George Pallett*
 Witness to Signature *R. Macdonald*
 Date 5/3/94

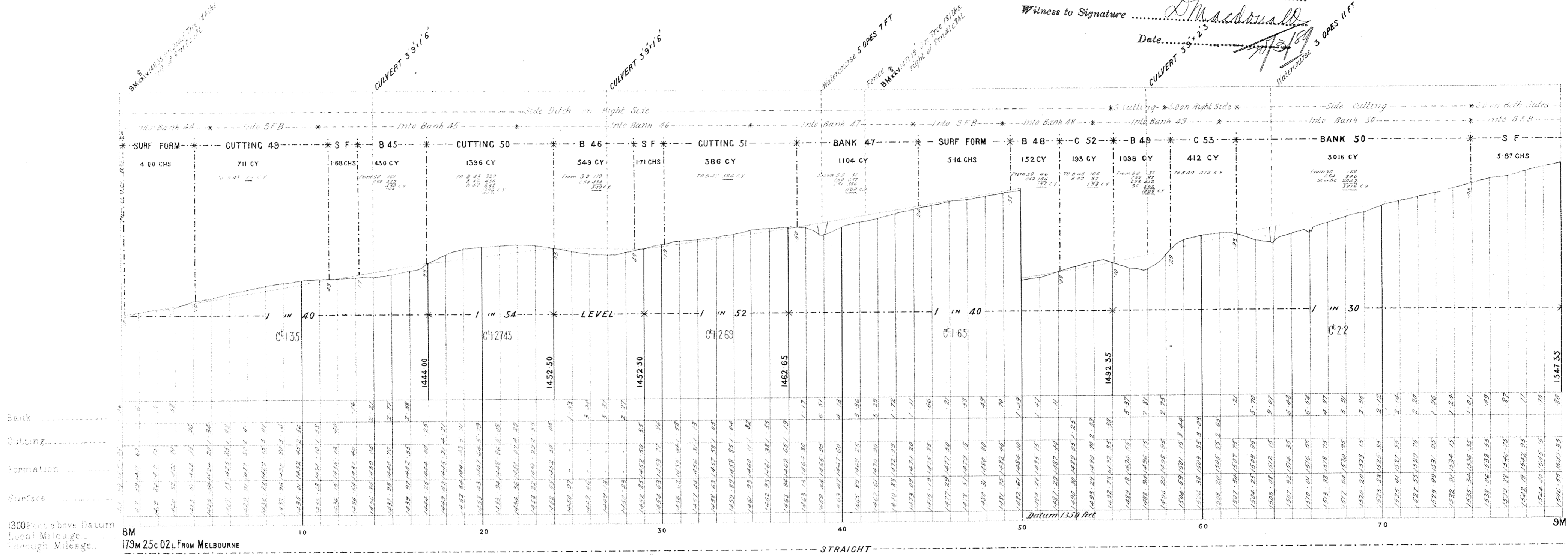

1300 Feet above Datum
 Local Mileage
 Through Mileage

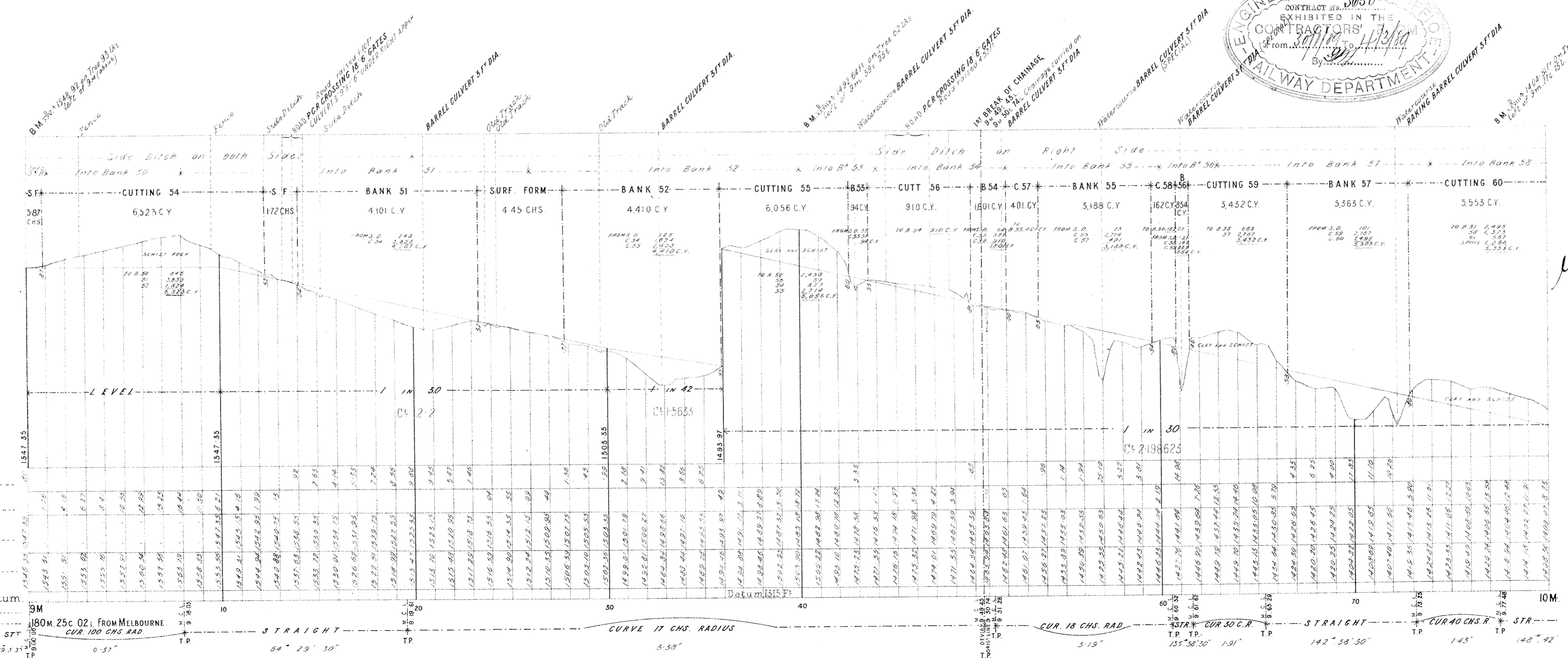

1375 Feet above Datum
 Local Mileage
 Through Mileage

*W.R.A.
30-1-99*

VICTORIAN RAILWAYS, YACKANDANDAH AND BEECHWORTH LINE.

**CONTRACT N^o 3650
N^o 6**

NOTE: Contractors must form their own judgment as to the nature of the Excavations. Borings and other information shown on these Sections are derived from the Surveyors' notes but are not guaranteed as correct, and the Corporation will not incur any responsibility in respect thereof.

The figures under the description of the Curves at the bottom of the Section denote the super-elevation of the outer rail; Speed 30 miles an hour.

SCALES: (HORIZONTAL 4 CHAINS TO AN INCH.
VERTICAL 40 FEET TO AN INCH)

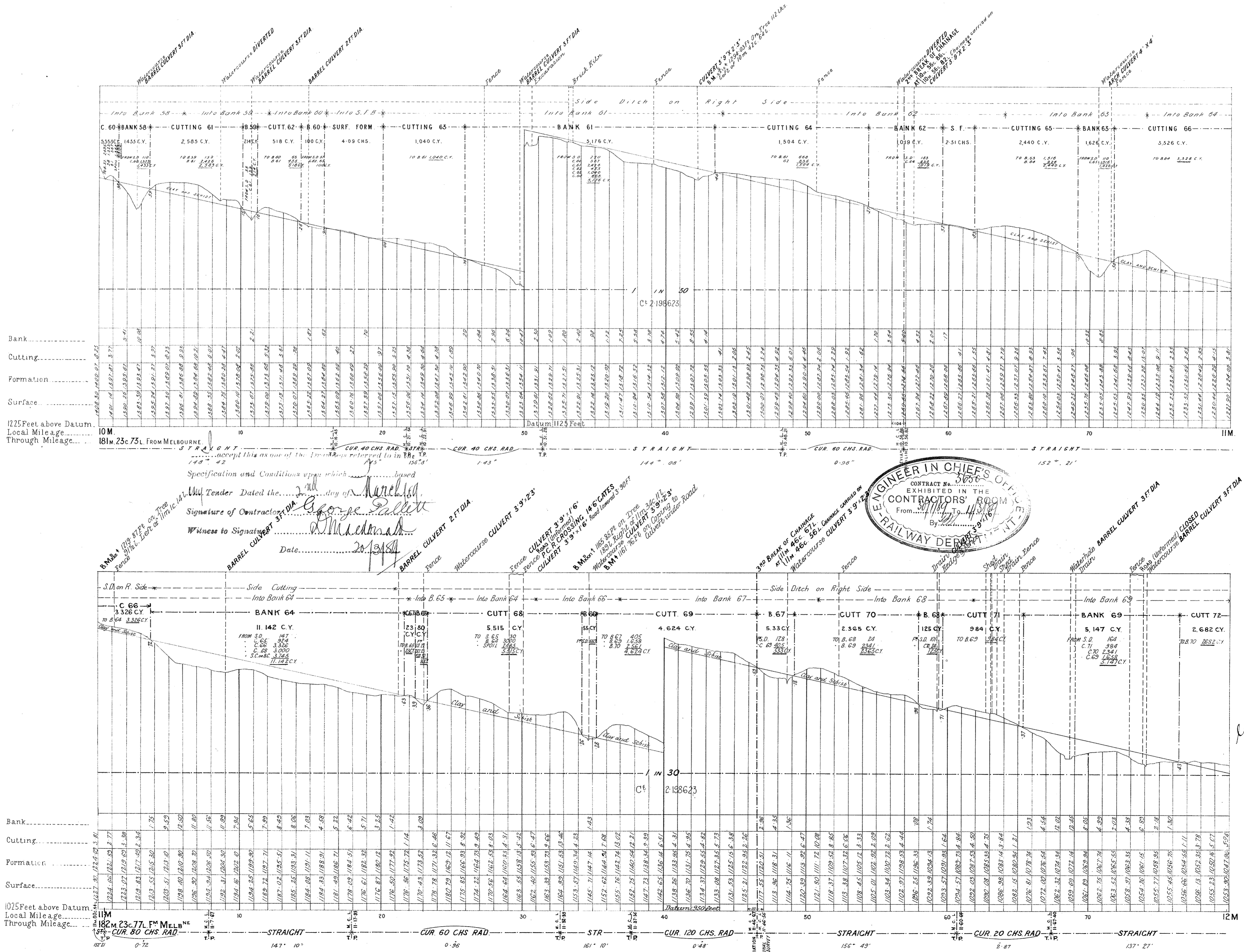

NOTE:-Contractors must form their own judgment as to the nature of the Excavations. Borings and other information shown on these Sections are derived from the Surveyors' notes but are not guaranteed as correct, and the Corporation will not incur any responsibility in respect thereof.

The figures under the description of the Curves at the bottom of the Section denote the super-elevation of the outer rail; Speed 30 miles an hour.

VICTORIAN RAILWAYS, YACKANDANDAH AND BEECHWORTH LINE.

SCALES: HORIZONTAL 4 CHAINS TO AN INCH.
VERTICAL 40 FEET TO AN INCH.

CONTRACT No 3560
No 7

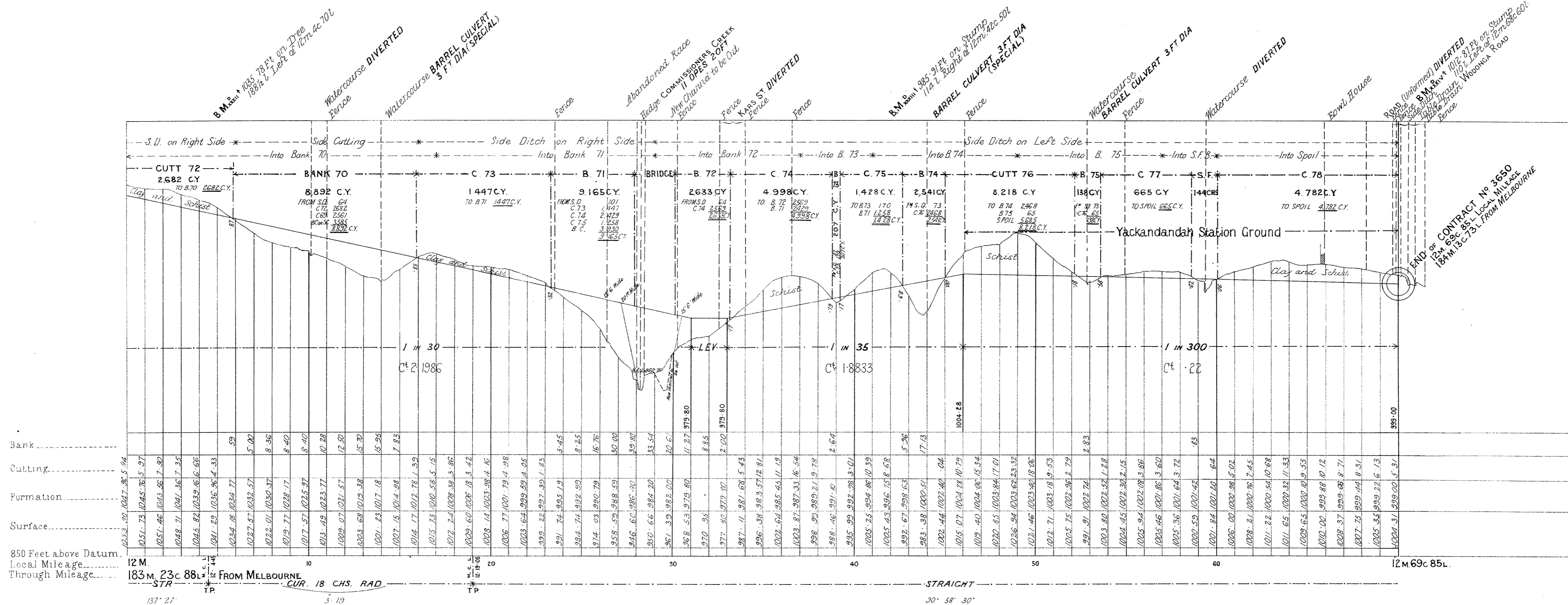

EWK
30.1.89