

VICTORIAN RAILWAYS,  
 BURNLEY AND OAKLEIGH LINE.  
 BURNLEY TO JUNCTION WITH LINE FROM OAKLEIGH, TO ALPHINGTON RAILWAY.

SCALE. 2 CHAINS TO AN INCH.

CONTRACT N<sup>o</sup> 3168.  
 N<sup>o</sup> 1.

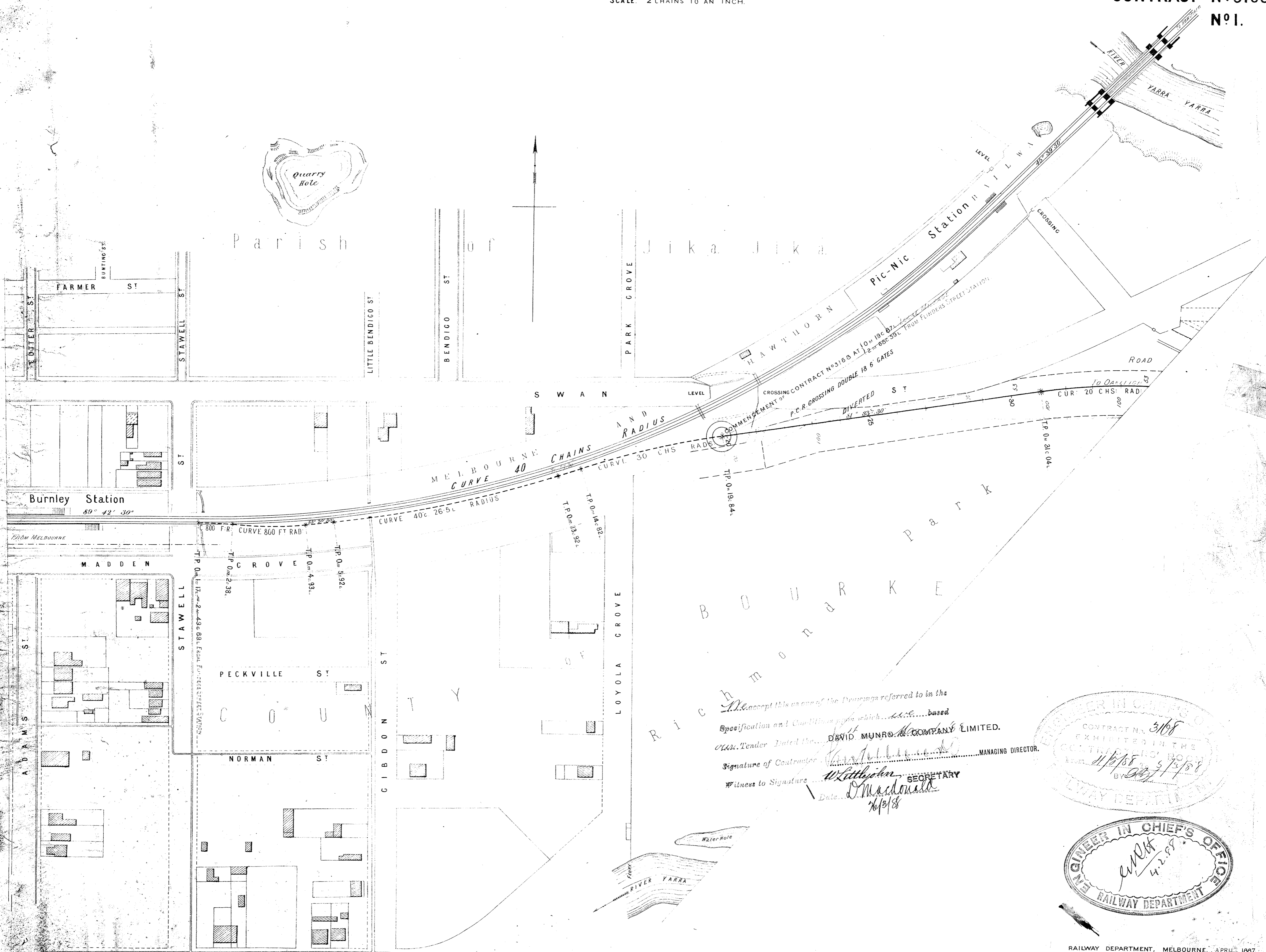

I accept this as one of the drawings referred to in the  
 Specification and Conditions upon which... based  
 my Tender Dated the...  
 Signature of Contractor...  
 Witness to Signature...  
 Date...  
 MANAGING DIRECTOR.  
 SECRETARY

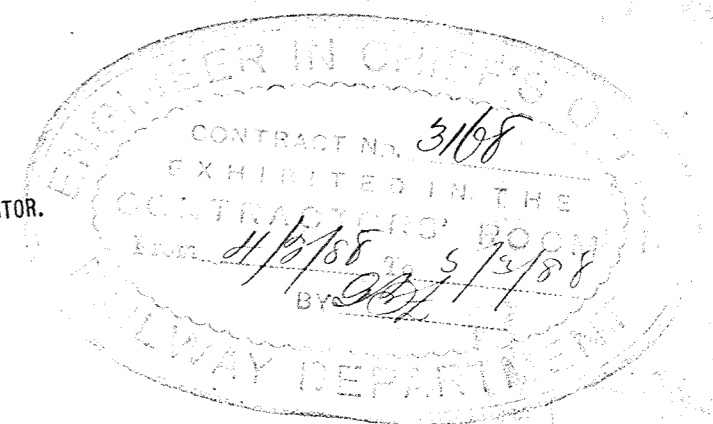

VICTORIAN RAILWAYS,  
 BURNLEY AND OAKLEIGH LINE.  
 BURNLEY TO JUNCTION WITH LINE FROM OAKLEIGH, TO ALPHINGTON RAILWAY.

CONTRACT N<sup>o</sup> 3168.  
 N<sup>o</sup> 10.

SCALE. 2 CHAINS TO AN INCH.

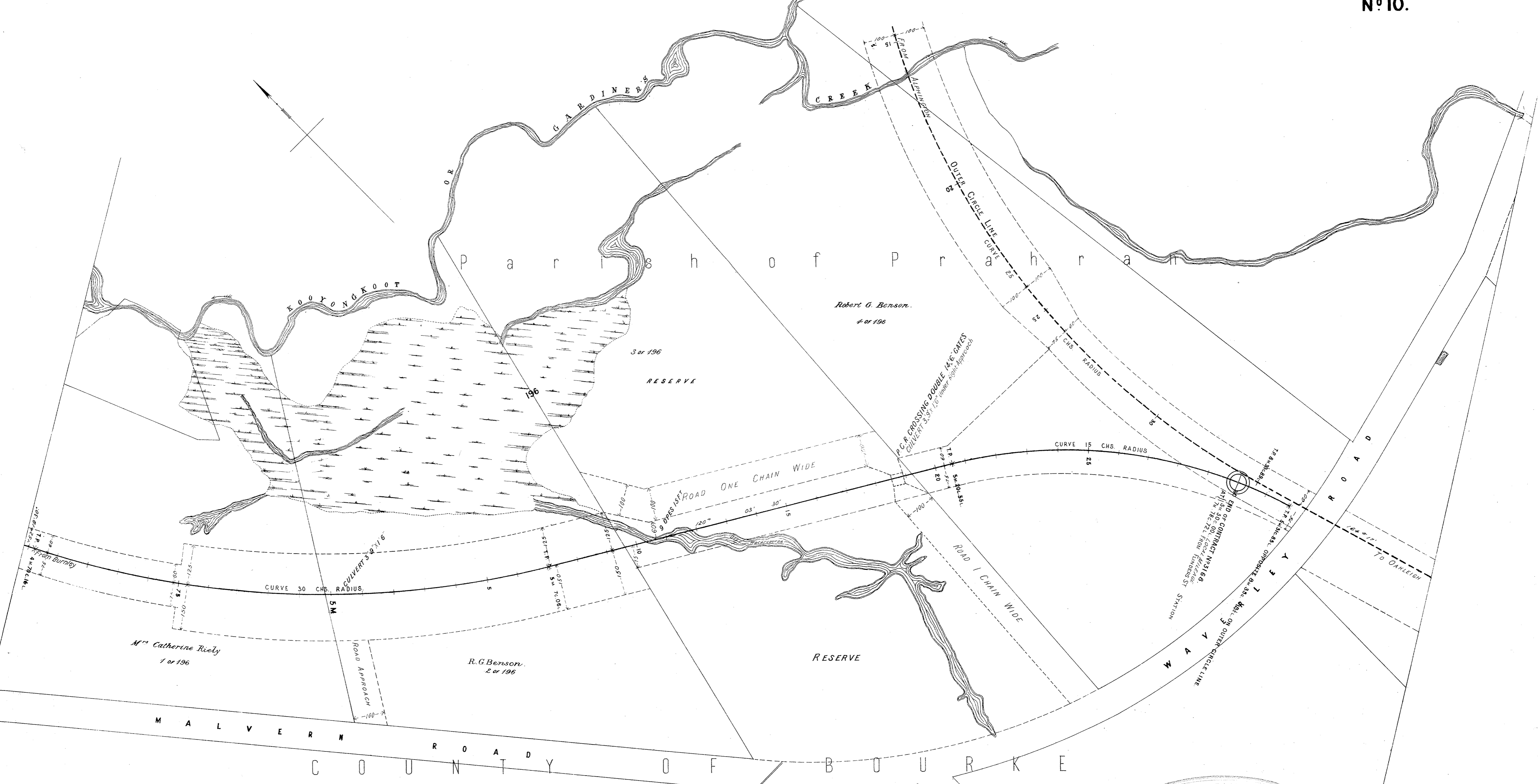

I hereby accept this as one of the Drawings referred to in the  
 Specification and Conditions upon which... based  
 of Tender Dated the... day of...  
 Signature of Contractor *[Signature]*  
 Witness to Signatures *[Signature]* SECRETARY  
 Date *[Date]*

DAVID MUNRO & COMPANY LIMITED  
 MANAGING DIRECTOR

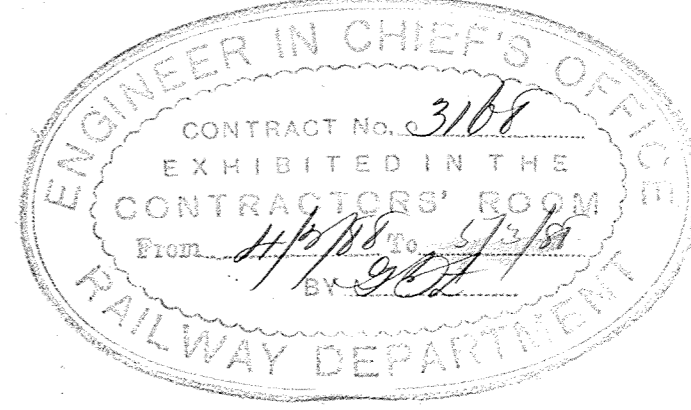

*[Handwritten signature]*  
 4.2.88

VICTORIAN RAILWAYS,  
 BURNLEY AND OAKLEIGH LINE.  
 BURNLEY TO JUNCTION WITH LINE FROM OAKLEIGH, TO ALPHINGTON RAILWAY.

CONTRACT No 3168.  
 No 2.

SCALE. 2 CHAINS TO AN INCH.



I hereby certify this as one of the Drawings referred to in the  
 Specification and Conditions upon which... based  
 our Tender Dated the...  
 Signature of Contractor...  
 Witness to Signature...  
 Date...

DAVID MUNRO & COMPANY LIMITED.  
 MANAGING DIRECTOR  
 SECRETARY

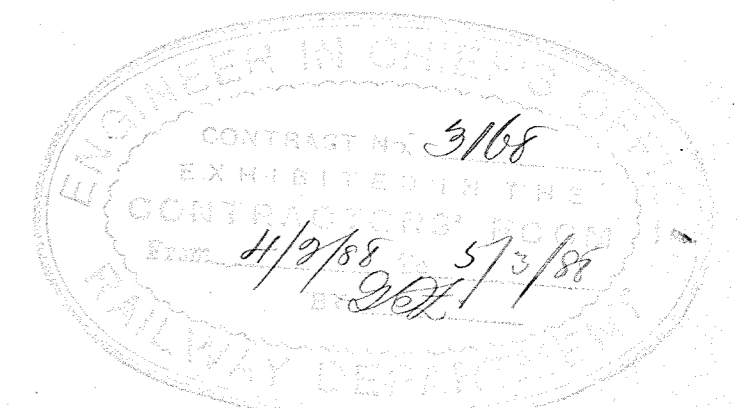

**VICTORIAN RAILWAYS,  
BURNLEY AND OAKLEIGH LINE.  
BURNLEY TO JUNCTION WITH LINE FROM OAKLEIGH, TO ALPHINGTON RAILWAY.**

SCALE 2 CHAINS TO AN INCH

**CONTRACT N<sup>o</sup> 3168.  
N<sup>o</sup> 3.**

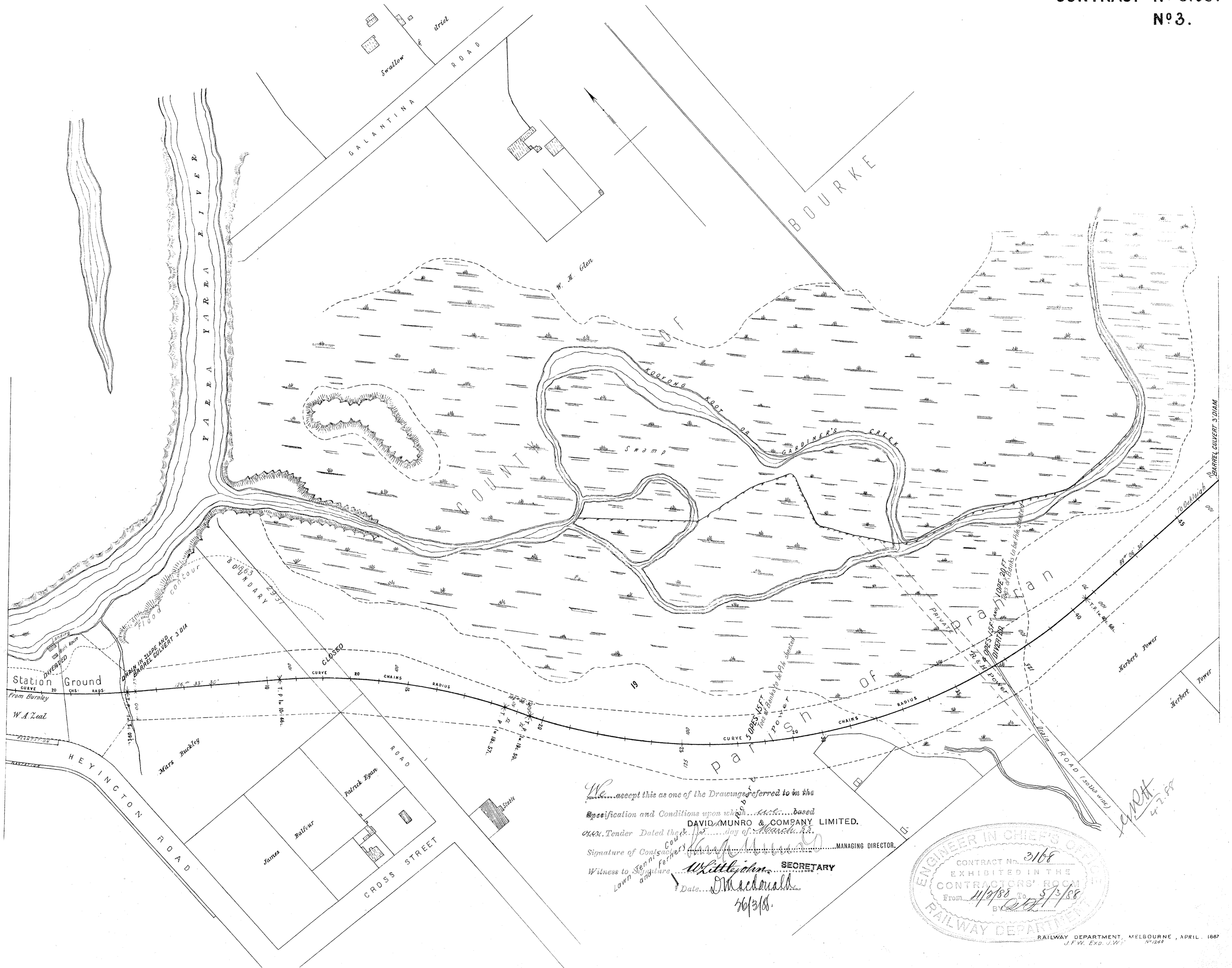

I hereby accept this as one of the Drawings referred to in the Specification and Conditions upon which... based  
 my Tender Dated the 1st day of March 1888.  
 Signature of Contractor... *David Munro*... MANAGING DIRECTOR.  
 Witness to Signature... *Whittlejohn*... SECRETARY  
 Date... *5/3/88*

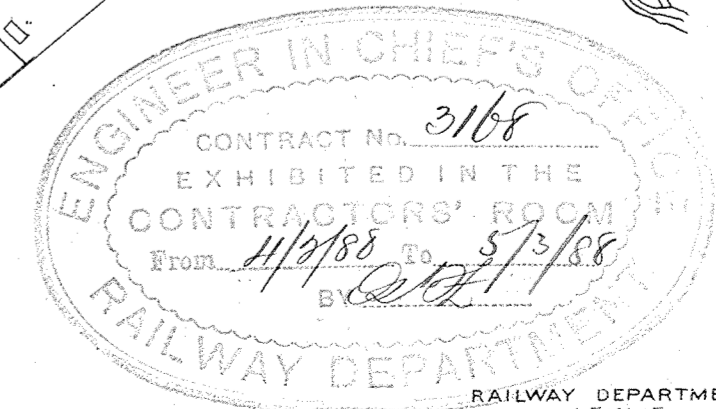

# VICTORIAN RAILWAYS, BURNLEY AND OAKLEIGH LINE.

BURNLEY TO JUNCTION WITH LINE FROM OAKLEIGH, TO ALPHINGTON RAILWAY.

SCALE: 2 CHAINS TO AN INCH.

CONTRACT N<sup>o</sup> 3168.  
N<sup>o</sup> 4

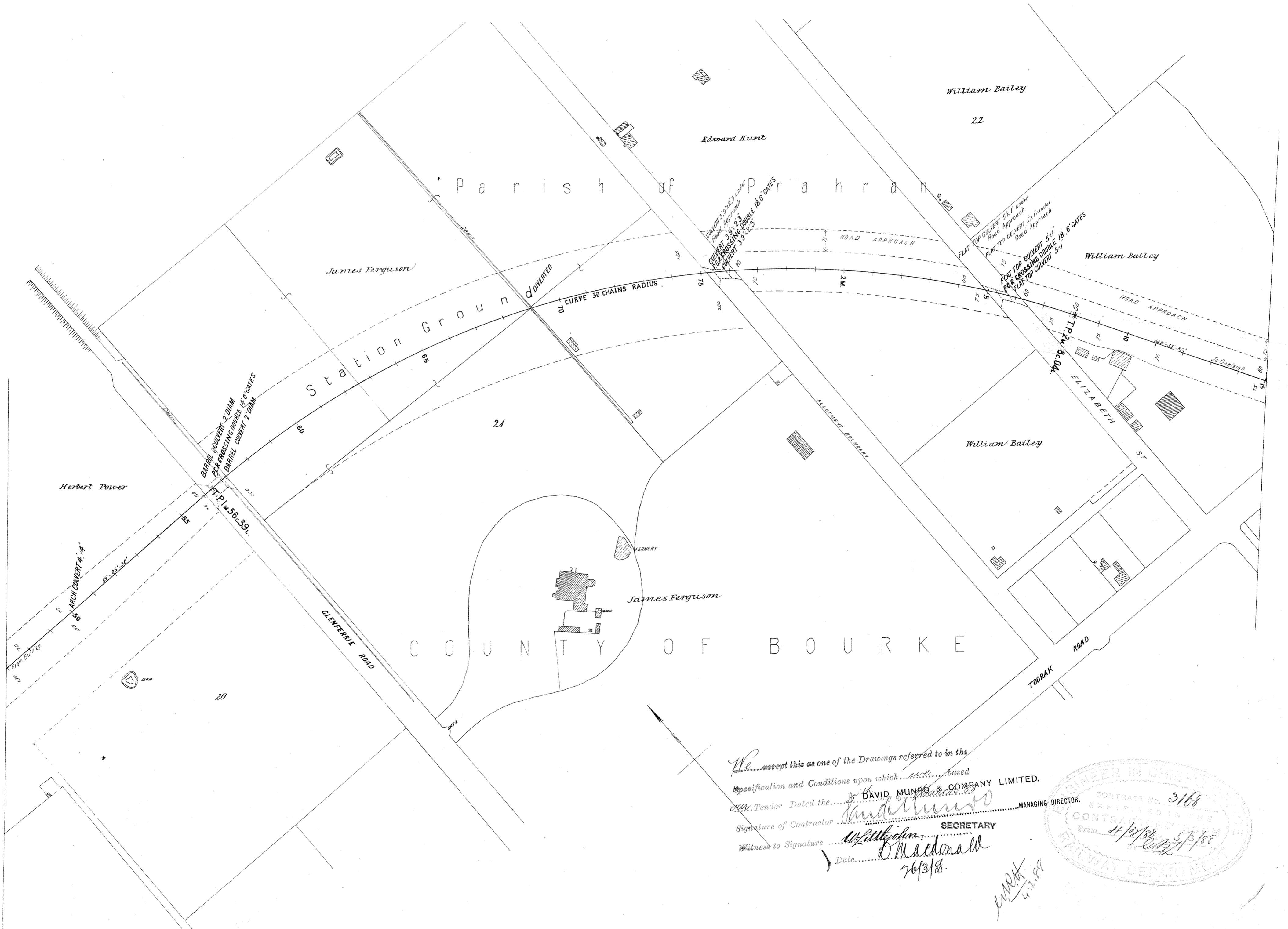

I accept this as one of the Drawings referred to in the  
Specification and Conditions upon which... based  
Tender Dated the... 3. DAVID MUNRO & COMPANY LIMITED.  
Signature of Contractor...  
Witness to Signature... SECRETARY  
Date... 26/3/88.

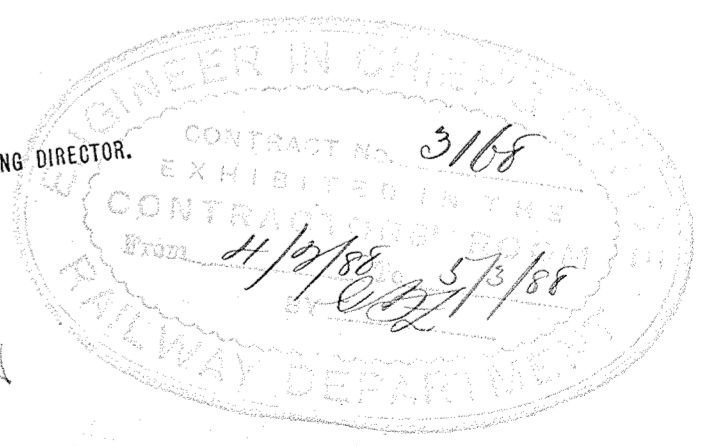

VICTORIAN RAILWAYS,  
 BURNLEY AND OAKLEIGH LINE.  
 BURNLEY TO JUNCTION WITH LINE FROM OAKLEIGH, TO ALPHINGTON RAILWAY.

SCALE: 2 CHAINS TO AN INCH.

CONTRACT N<sup>o</sup> 3168.  
 N<sup>o</sup> 5



J.H. Young  
 I accept this as one of the Drawings referred to in the  
 Specification and Conditions upon which... based  
 my Tender Dated the...  
 Signature of Contractor... DAVID MURPHY & COMPANY LIMITED.  
 Witness to Signature... W. Littlejohn... MANAGING DIRECTOR.  
 Date... 26/3/88  
 W. Littlejohn  
 4/2/88

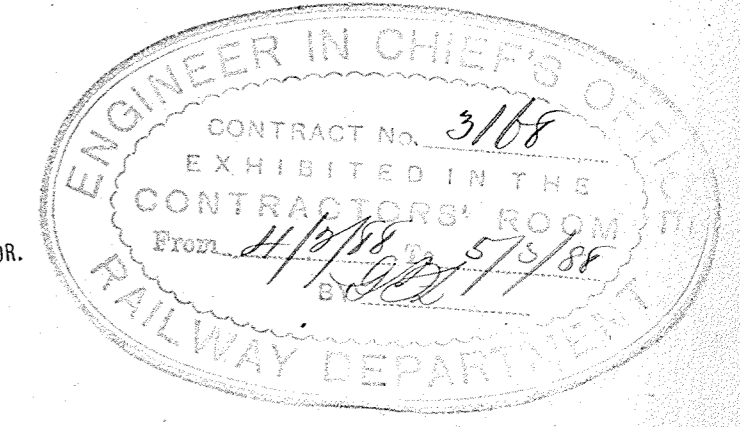

VICTORIAN RAILWAYS,  
 BURNLEY AND OAKLEIGH LINE.  
 BURNLEY TO JUNCTION WITH LINE FROM OAKLEIGH, TO ALPHINGTON RAILWAY.

SCALE. 2 CHAINS TO AN INCH.

CONTRACT N<sup>o</sup> 3168.  
 N<sup>o</sup> 6.

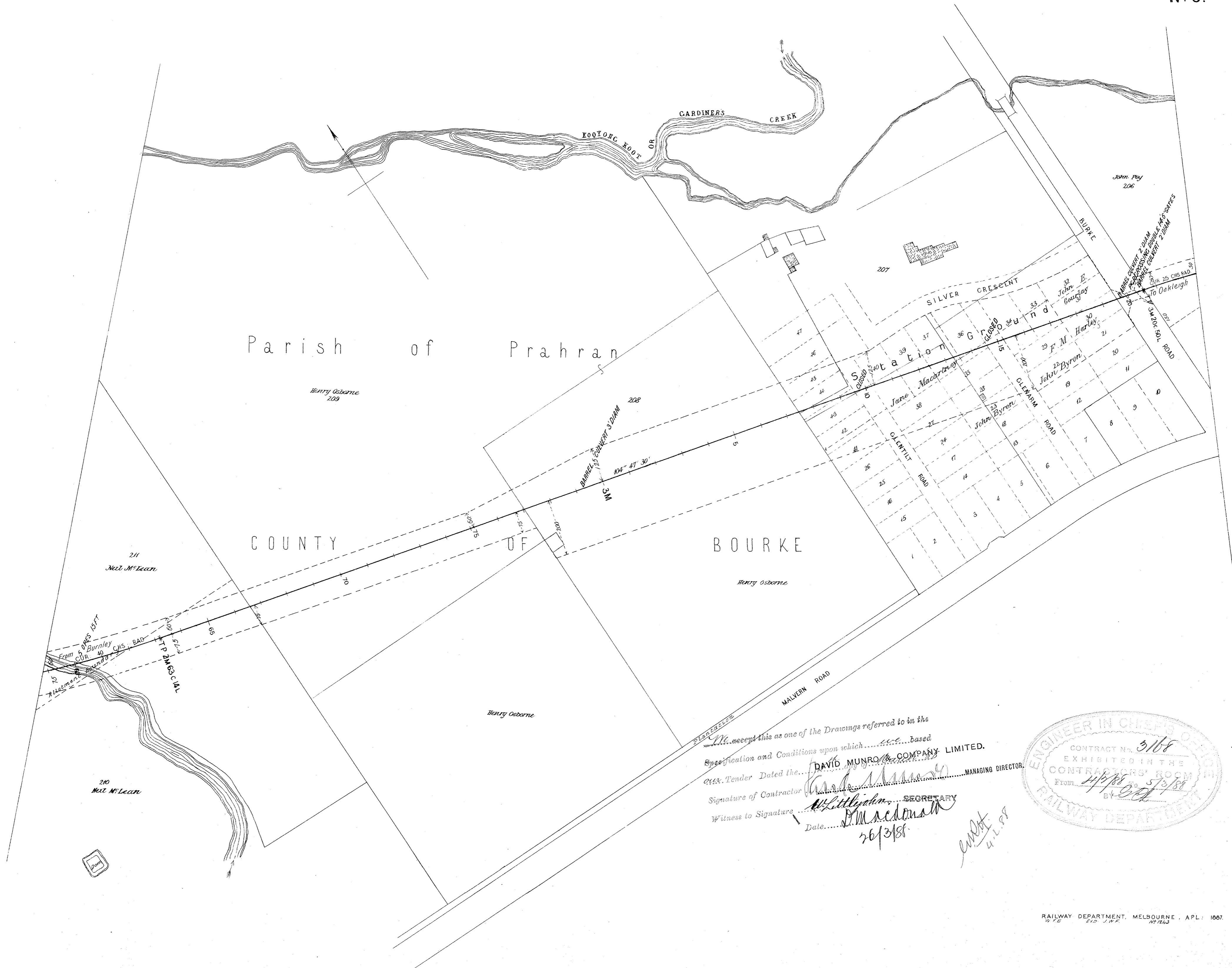

I accept this as one of the Drawings referred to in the  
 Specification and Conditions upon which... based  
 My Tender Dated the...  
 Signature of Contractor *David Munro*  
 Witness to Signature *W. Littlejohn* SECRETARY  
 Date... *26/3/88*  
 MANAGING DIRECTOR

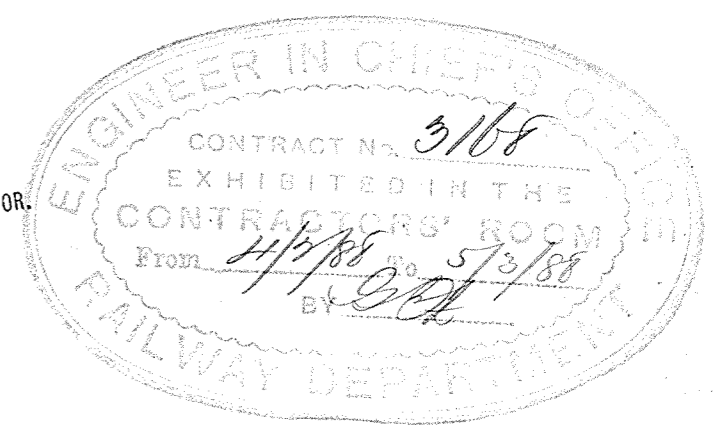

VICTORIAN RAILWAYS,  
 BURNLEY AND OAKLEIGH LINE.  
 BURNLEY TO JUNCTION WITH LINE FROM OAKLEIGH, TO ALPHINGTON RAILWAY.

SCALE. 2 CHAINS TO AN INCH.

CONTRACT N<sup>o</sup> 3168.  
 N<sup>o</sup> 7.

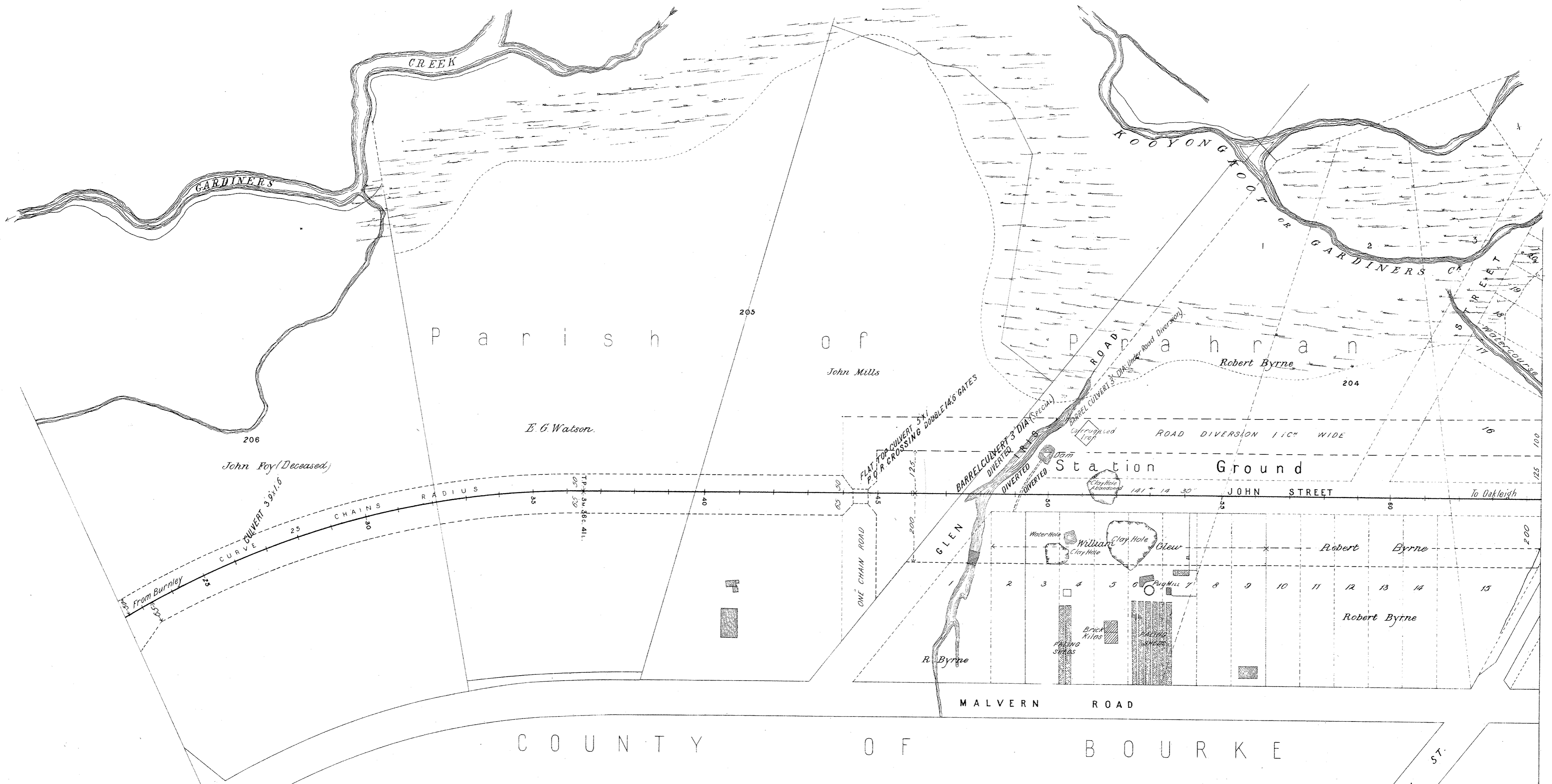

I accept this as one of the Drawings referred to in the  
 Specification and Conditions upon which... based  
 my Tender Dated the... day of...  
 Signature of Contractor...  
 Witness to Signature...  
 Date...  
 DAVID MUNRO & COMPANY LIMITED,  
 MANAGING DIRECTOR.  
 SECRETARY

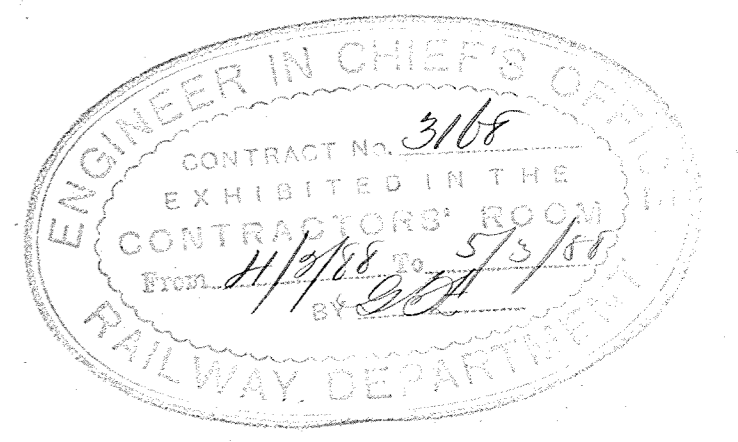



VICTORIAN RAILWAYS,  
 BURNLEY AND OAKLEIGH LINE.  
 BURNLEY TO JUNCTION WITH LINE FROM OAKLEIGH, TO ALPHINGTON RAILWAY.

SCALE. 2 CHAINS TO AN INCH.

CONTRACT N<sup>o</sup> 3168.  
 N<sup>o</sup> 8.

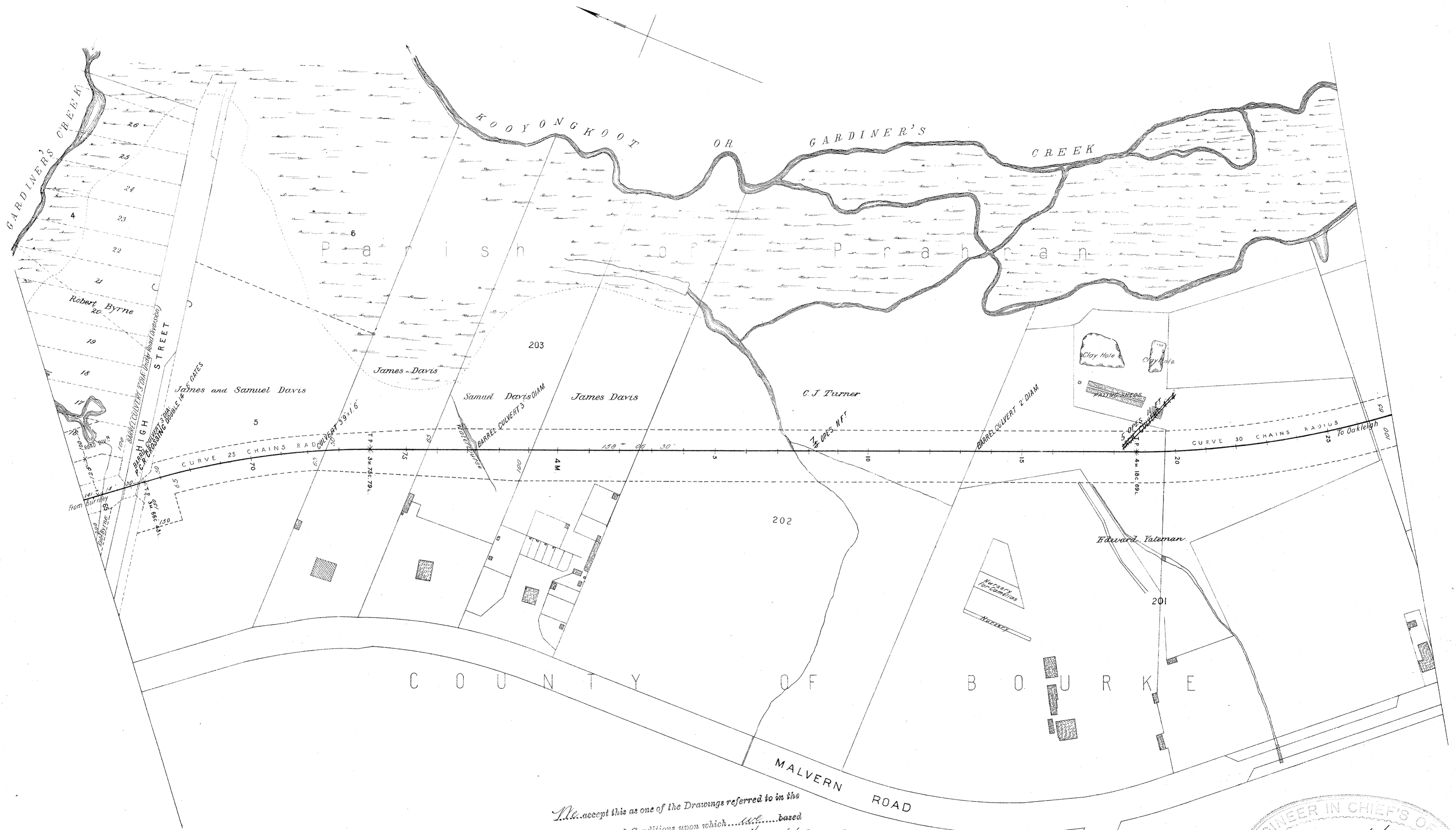

I accept this as one of the Drawings referred to in the  
 Specification and Conditions upon which... based  
 Tender Dated the... DAVID MURRO & COMPANY LIMITED.  
 Signature of Contractor *[Signature]* MANAGING DIRECTOR.  
 Witness to Signature *[Signature]* SECRETARY  
 Date *20/3/88*

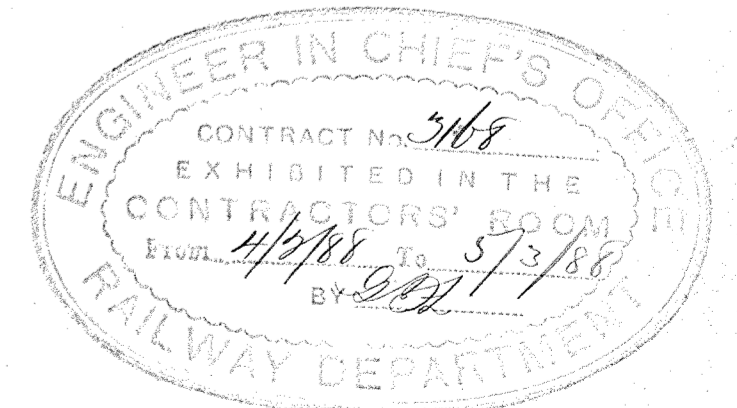

# VICTORIAN RAILWAYS, BURNLEY AND OAKLEIGH LINE.

BURNLEY TO JUNCTION WITH LINE FROM OAKLEIGH, TO ALPHINGTON RAILWAY.

## Plan of Land

Belonging to \_\_\_\_\_ Occupied by \_\_\_\_\_  
Situating in the Parish of Prahran — in the County of Bourke

Scale. 2 Chains to 1 inch.

(13)<sup>XX</sup>

Reference Number

Quantity of Land required and colored red <sup>A. R. P.</sup> more or less.  
142.6 '90.

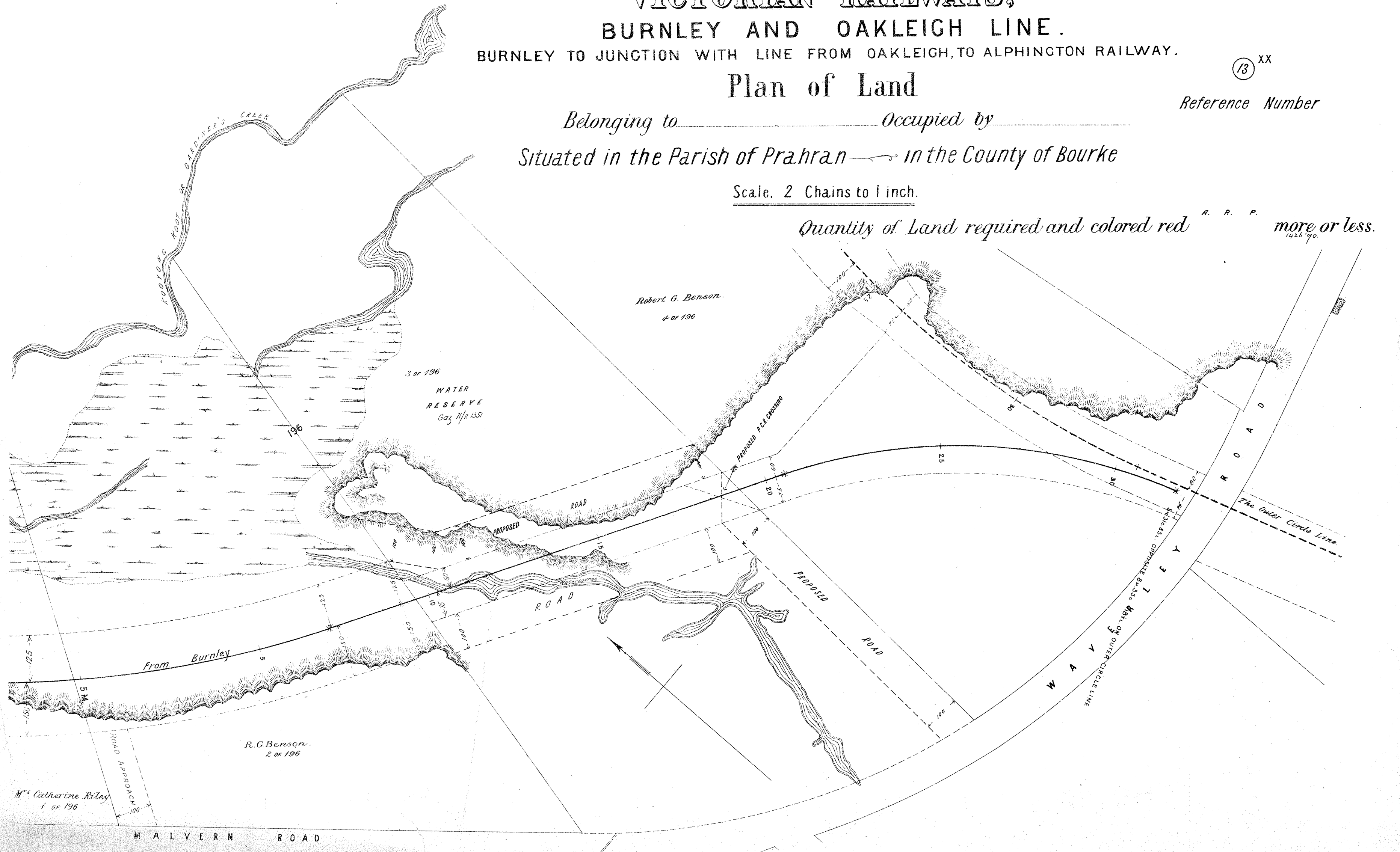



**NOTE**:-Contractors must form their own judgment as to the nature of the Excavations, Borrowings and other information shown on these Sections are derived from the Surveyors' notes but are not guaranteed as correct, and the Corporation will not incur any responsibility in respect thereof.

The figures under the description of the Curves at the bottom of the Section denote the super-elevation of the outer rail; Speed 30 miles an hour.

# VICTORIAN RAILWAYS, BURNLEY AND OAKLEIGH LINE.

BURNLEY TO JUNCTION WITH LINE FROM OAKLEIGH, TO ALPHINGTON RAILWAY.

SCALES (HORIZONTAL 4 CHAINS TO AN INCH  
VERTICAL 40 FEET TO AN INCH)

CONTRACT NO 3168  
No 1

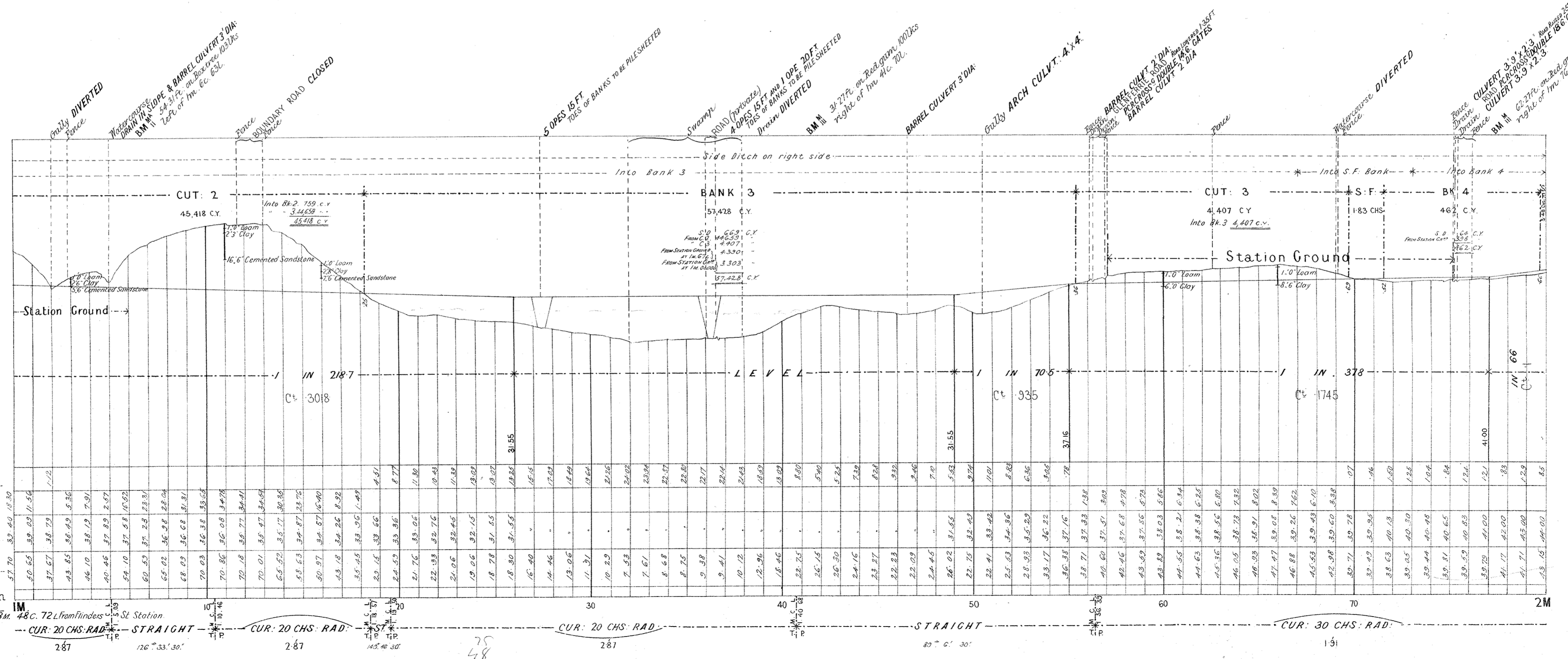
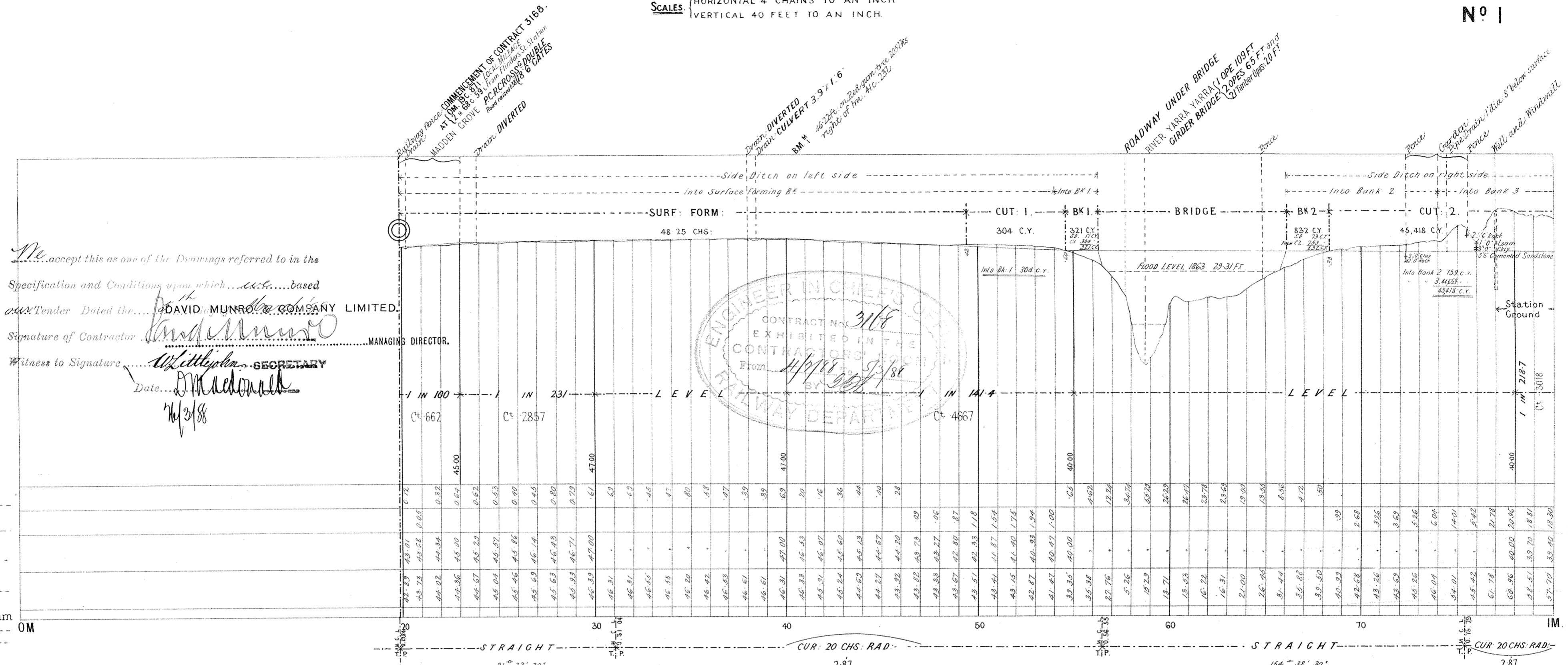

**NOTE**—Contractors must form their own judgment as to the nature of the Excavations, Borings and other information shown on these Sections are derived from the Surveyors' notes but are not guaranteed as correct, and the Corporation will not incur any responsibility in respect thereof.

The figures under the description of the Curves at the bottom of the Section denote the super-elevation of the outer rail; Speed 30 miles an hour.

# VICTORIAN RAILWAYS, BURNLEY AND OAKLEIGH LINE. BURNLEY TO JUNCTION WITH LINE FROM OAKLEIGH, TO ALPHINGTON RAILWAY.

SCALES (HORIZONTAL 4 CHAINS TO AN INCH  
VERTICAL 40 FEET TO AN INCH)

CONTRACT N<sup>o</sup> 3168.  
N<sup>o</sup> 2

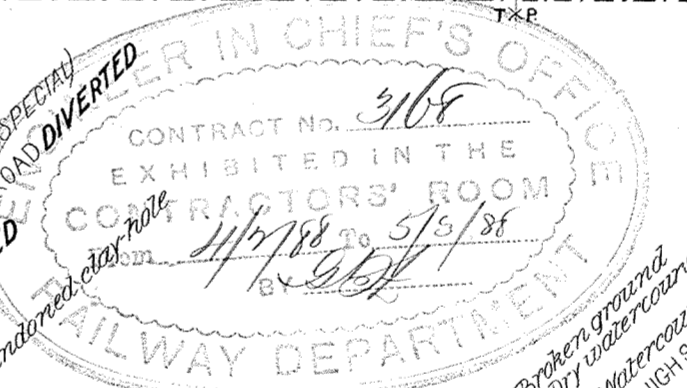
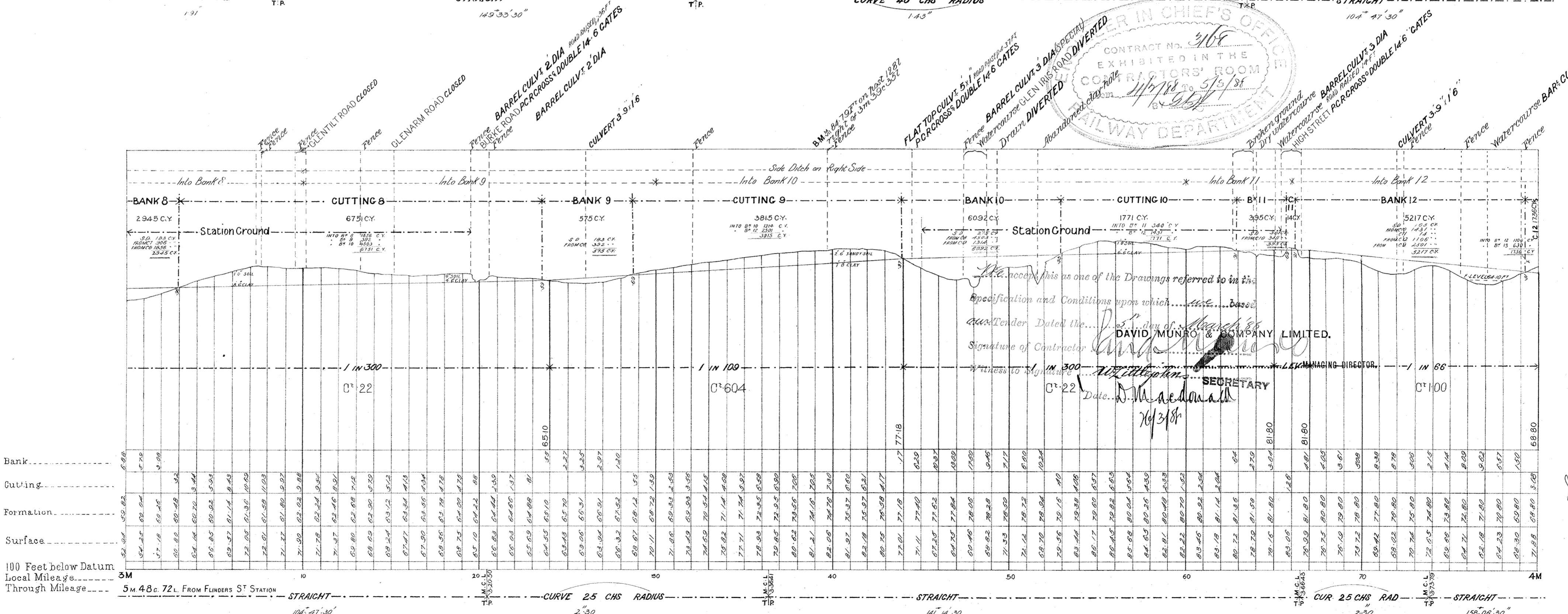
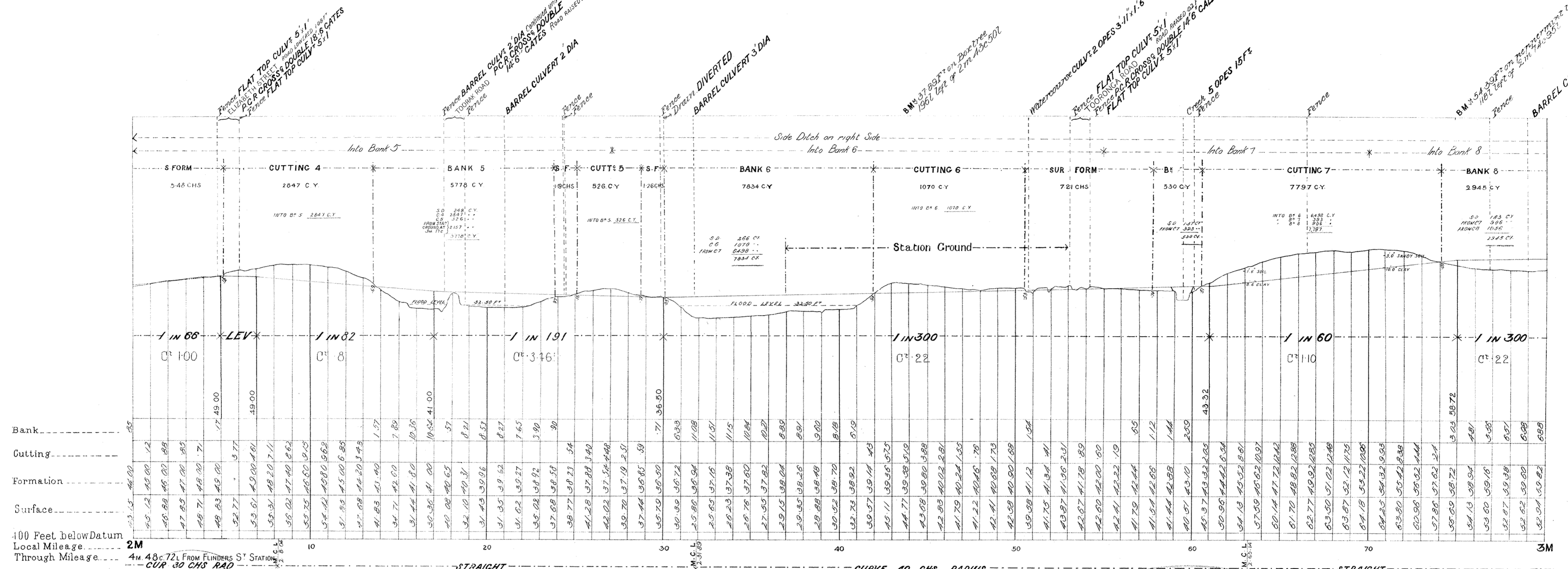

I hereby accept this as one of the Drawings referred to in the Specification and Conditions upon which... based  
 and Tender Dated the...  
 Signature of Contractor *David Munro & Co. Limited*  
 Witness to Signature *D. M. Macdonald*  
 Date *2/3/88*  
 SECRETARY

*W.M.H.*  
4.2.88

**NOTE** - Contractors must form their own judgment as to the nature of the Excavations, Borings and other information shown on these Sections are derived from the Surveyors' notes but are not guaranteed as correct, and the Corporation will not incur any responsibility in respect thereof.

The figures under the description of the Curves at the bottom of the Section denote the super-elevation of the outer rail; Speed 30 miles an hour.

# VICTORIAN RAILWAYS, BURNLEY AND OAKLEIGH LINE. BURNLEY TO JUNCTION WITH LINE FROM OAKLEIGH TO ALPHINGTON RAILWAY.

**CONTRACT N<sup>o</sup> 3168.  
N<sup>o</sup> 3.**

SCALES (HORIZONTAL 4 CHAINS TO AN INCH  
VERTICAL 40 FEET TO AN INCH.

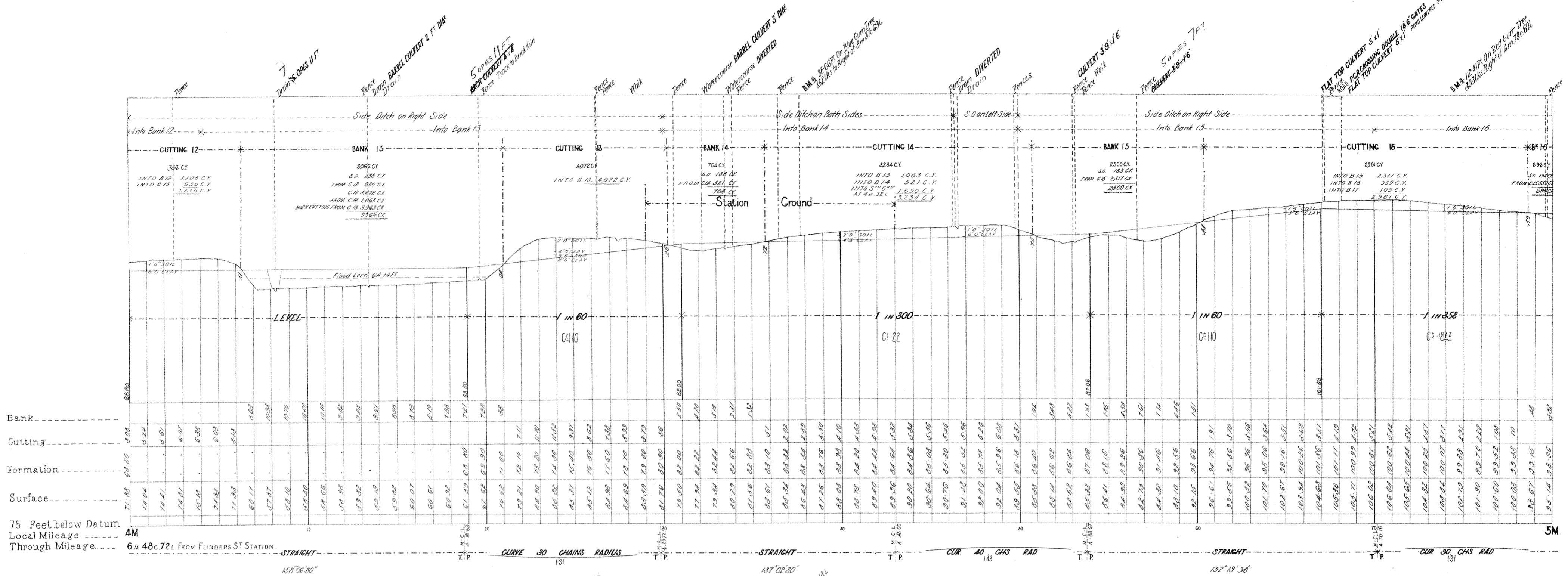

I do accept this as one of the Drawings referred to in the Specification and Conditions upon which... based  
 our Tender Dated the... **DAVID MUNRO & COMPANY LIMITED.**  
 Signature of Contractor *[Signature]* MANAGING DIRECTOR.  
 Witness to Signature *[Signature]* SECRETARY  
 Date *[Signature]* 7/3/88.

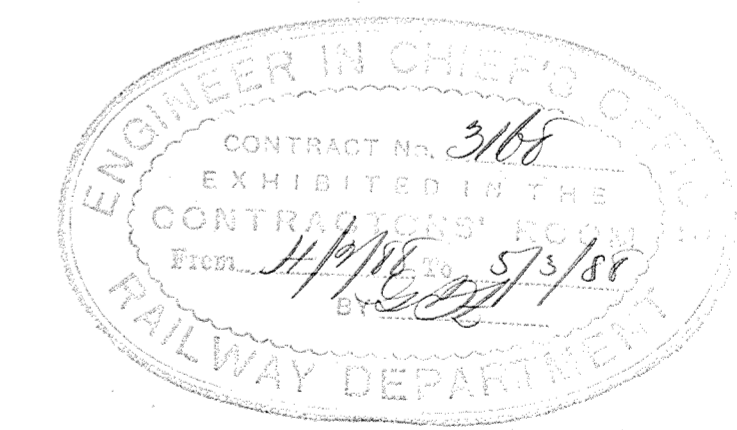

*[Handwritten signature]*  
4.2.88