

# VICTORIAN RAILWAYS. GIPPS LAND LINE, SOUTH YARRA TO OAKLEIGH

Scale, 10 Chains to 1 Inch

CONTRACT N<sup>o</sup> III7  
N<sup>o</sup> 1<sup>st</sup>

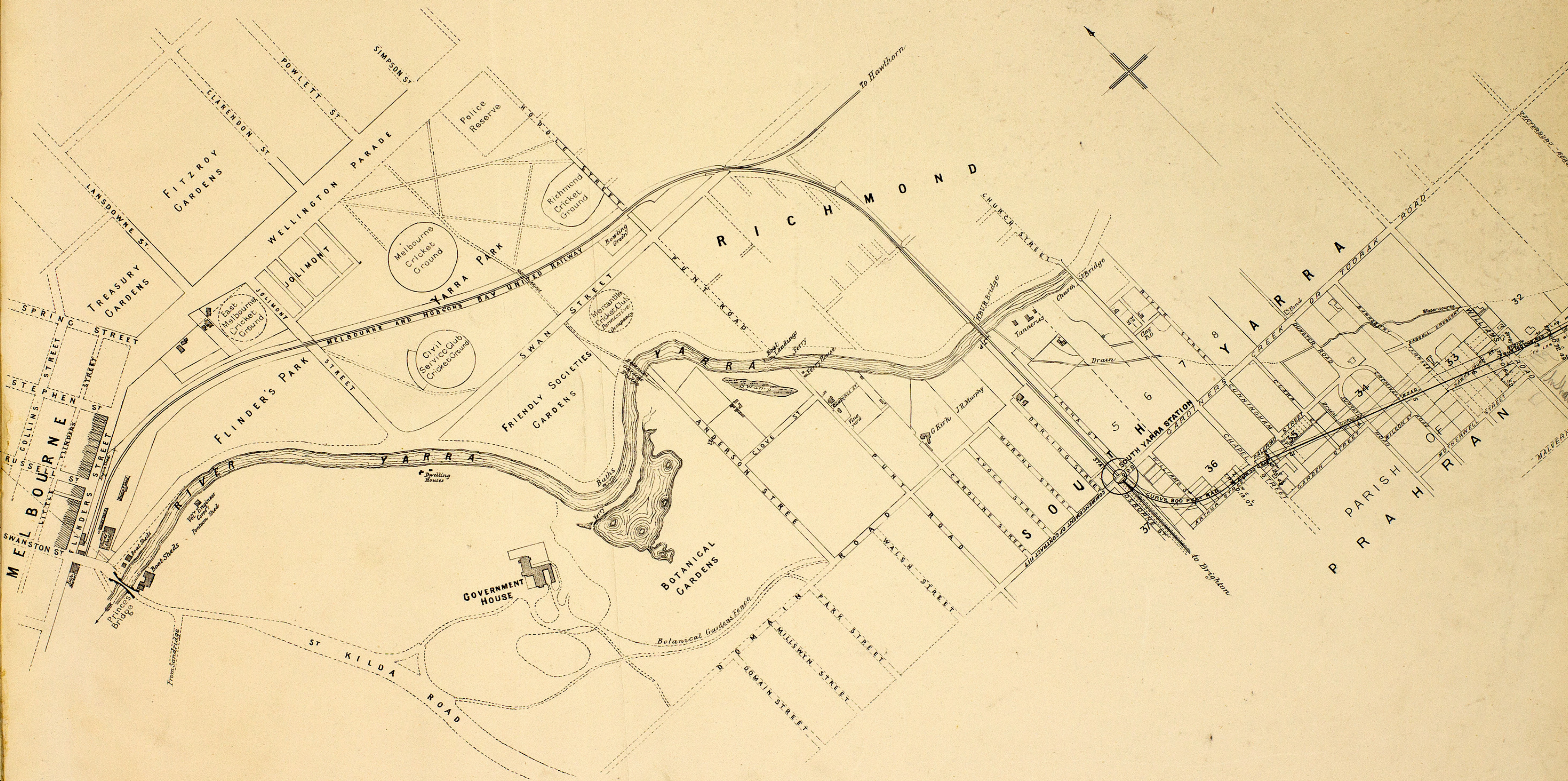



# VICTORIAN RAILWAYS, GIPPS LAND LINE, SOUTH YARRA TO OAKLEIGH

Scale, 10 Chains to 1 Inch

CONTRACT N<sup>o</sup> III7.  
N<sup>o</sup> 2.

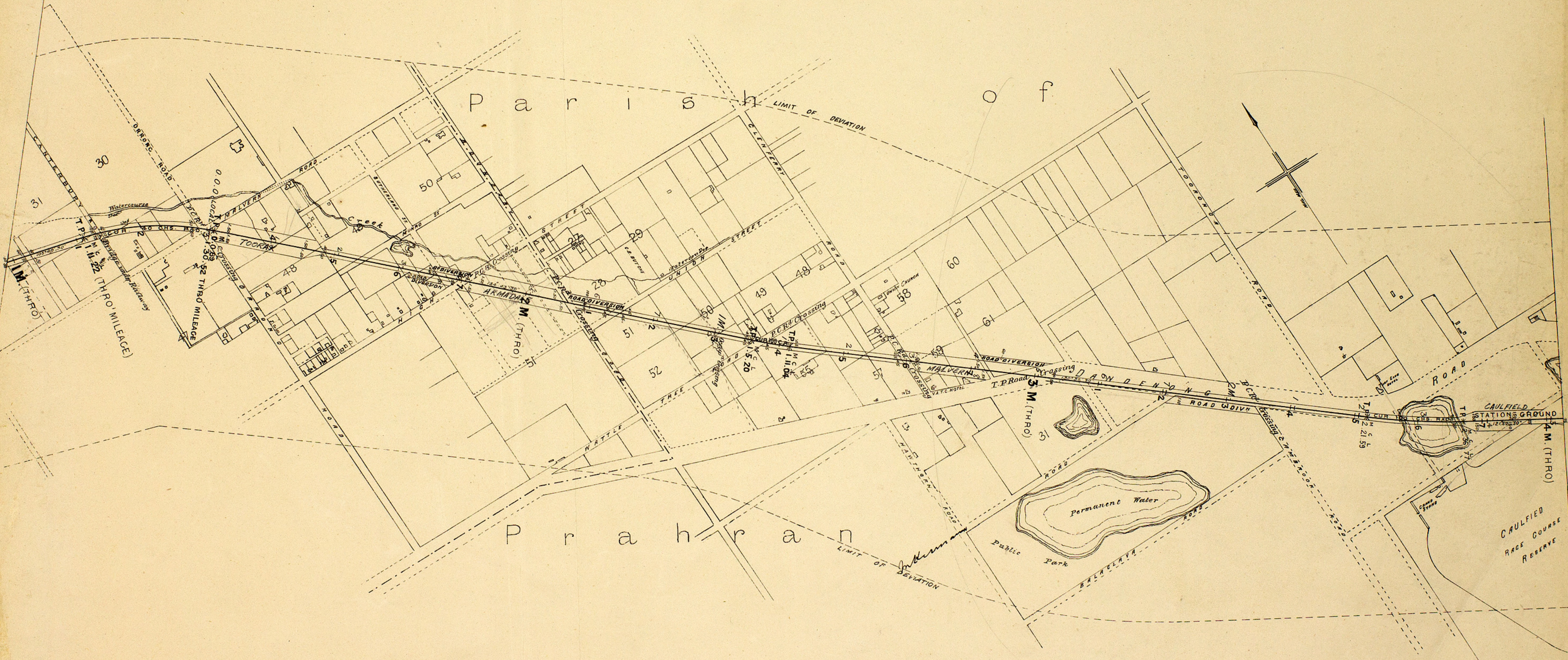

Cedding Lane



VICTORIAN RAILWAYS,  
GIPPS LAND LINE, SOUTH YARRA TO OAKLEIGH

Scale, 10 Chains to 1 Inch

CONTRACT No 1117  
No 3

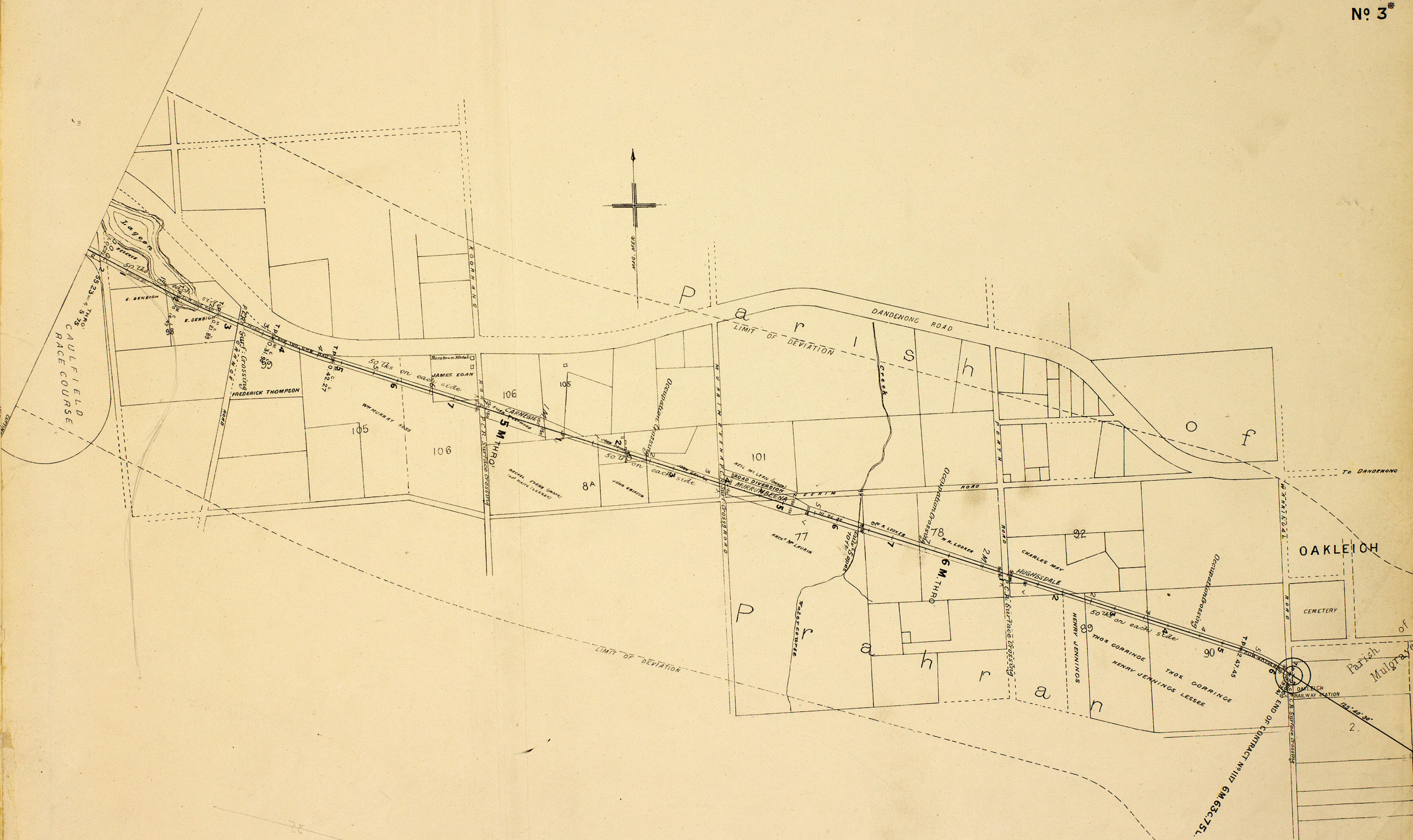



# VICTORIAN RAILWAYS, GIPPS LAND LINE, "SOUTH YARRA TO OAKLEIGH"

SCALES HORIZONTAL 4 CHAINS TO AN INCH  
VERTICAL - 40 FEET TO AN INCH

CONTRACT N<sup>o</sup> 1117.  
N<sup>o</sup> 1.

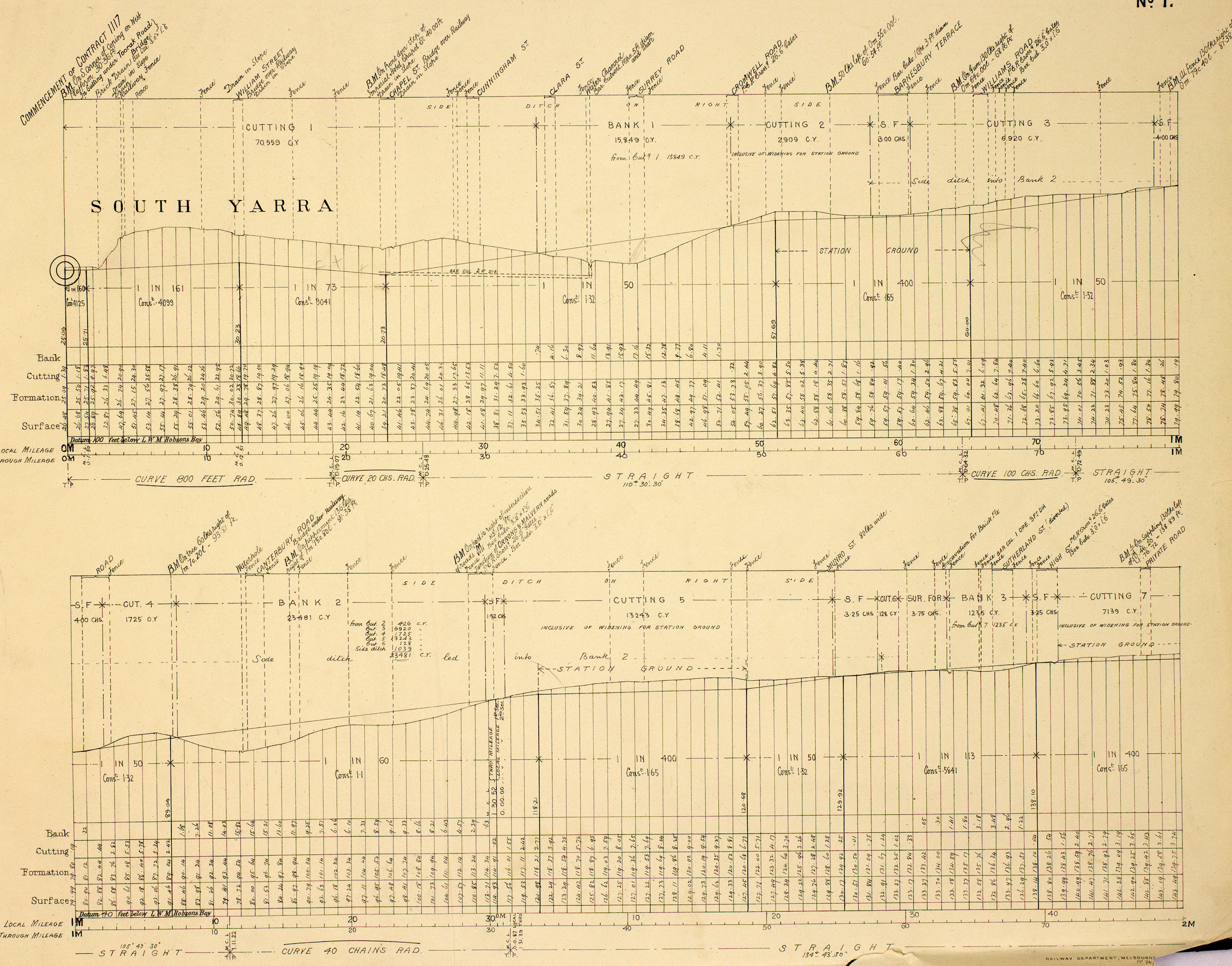



# VICTORIAN RAILWAYS. GIPPS LAND LINE, "SOUTH YARRA TO OAKLEIGH."

SCALES. HORIZONTAL 4 CHAINS TO AN INCH  
VERTICAL, - 40 FEET TO AN INCH

CONTRACT N<sup>o</sup> III7.  
N<sup>o</sup> 2.

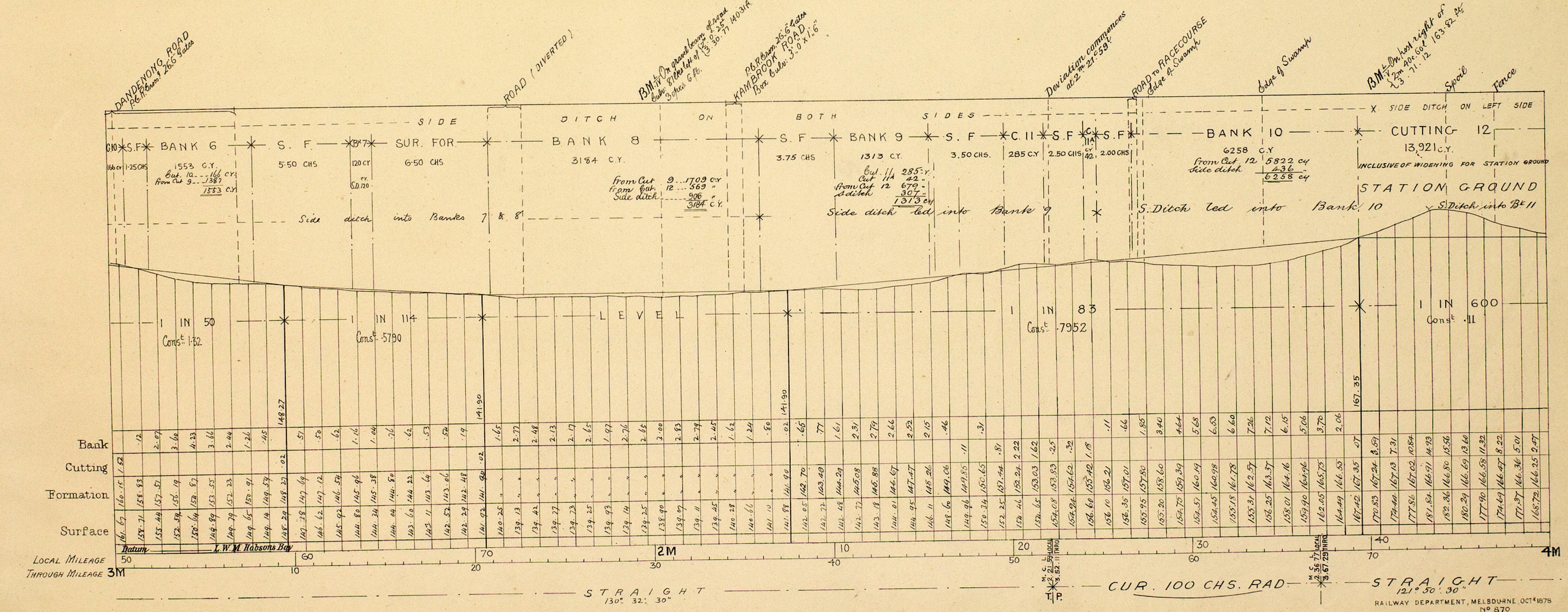
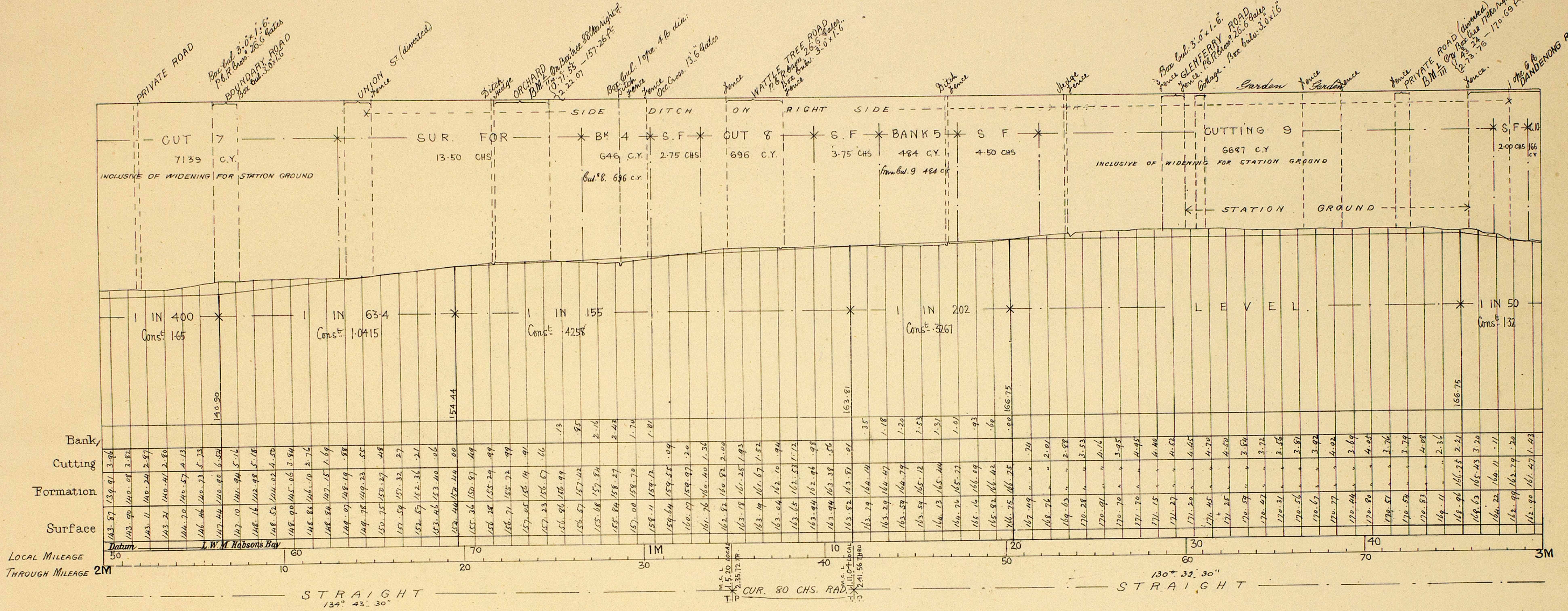



# VICTORIAN RAILWAYS, GIPPS LAND LINE, "SOUTH YARRA TO OAKLEIGH."

CONTRACT NO. III7.  
No. 3.

SCALES: HORIZONTAL 4 CHAINS TO AN INCH  
VERTICAL, - 40 FEET TO AN INCH

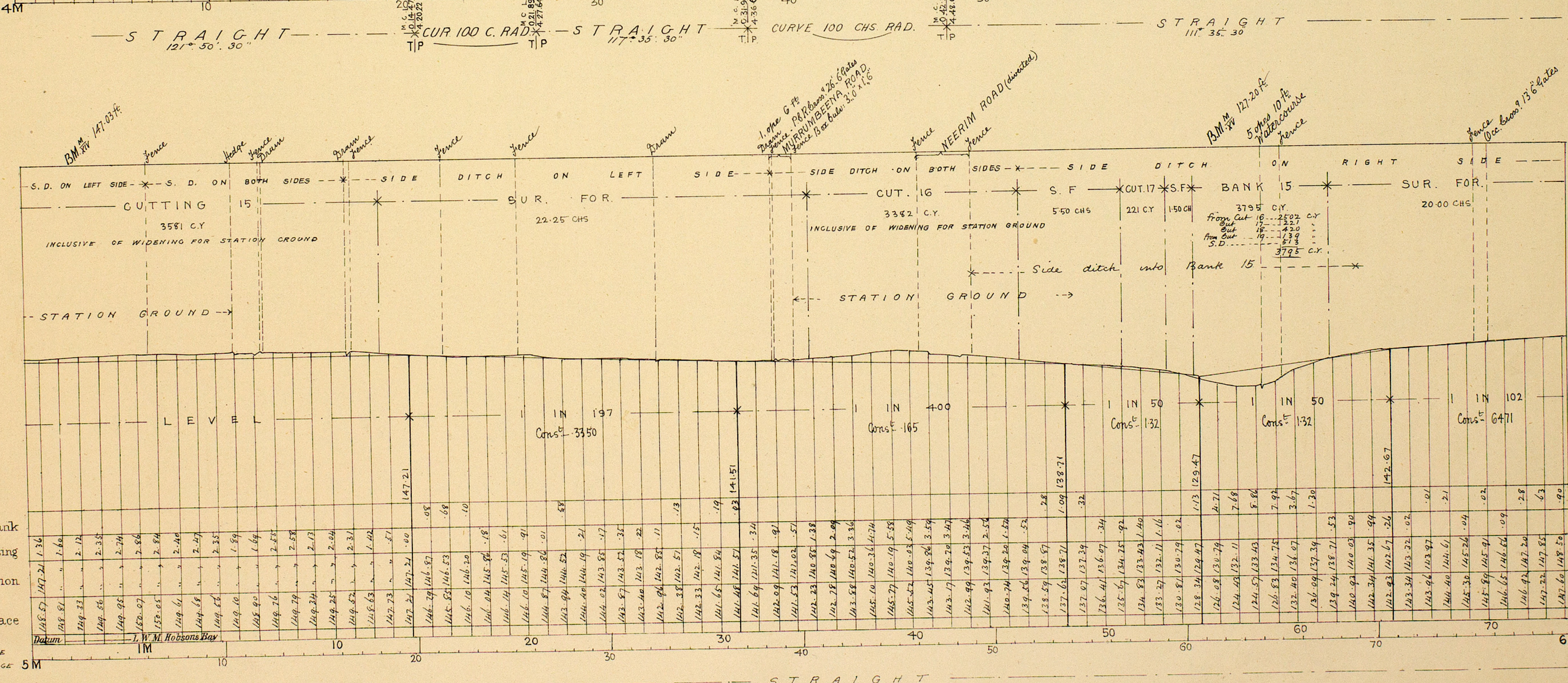
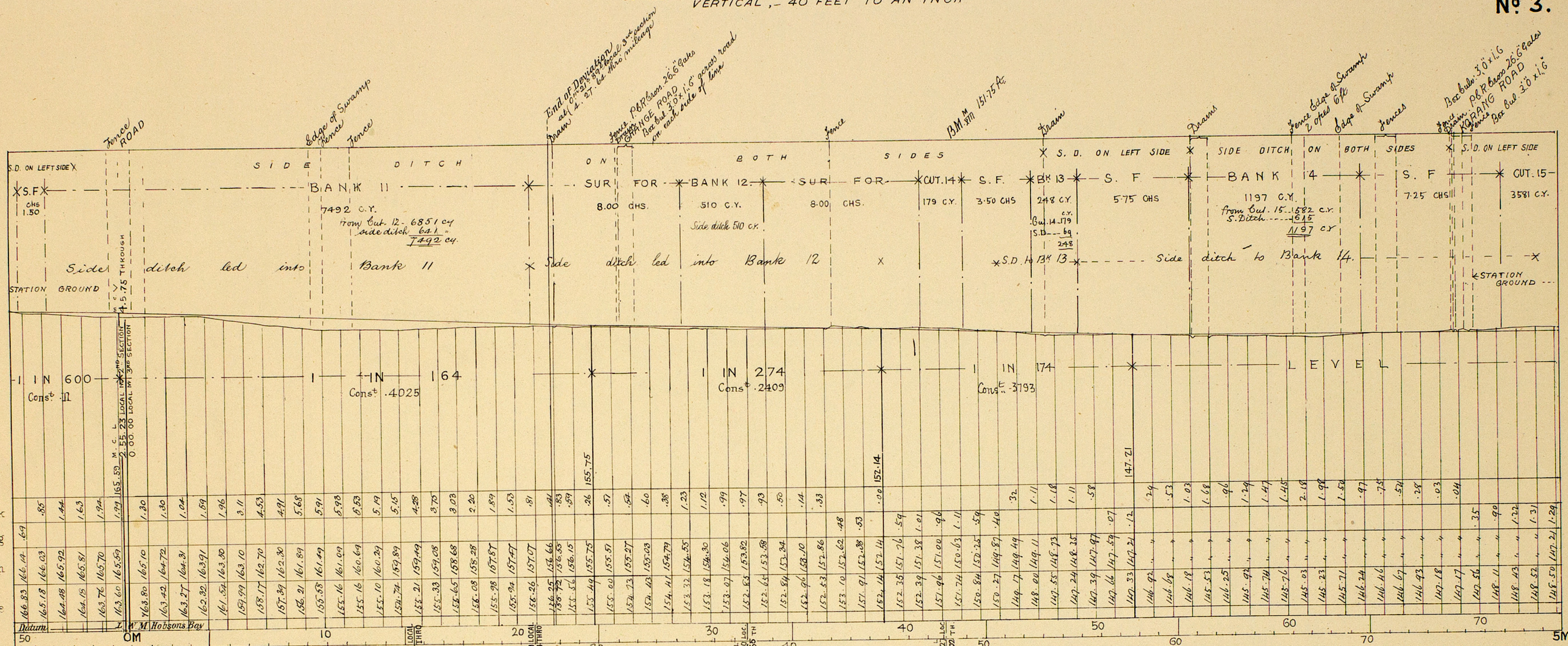



# VICTORIAN RAILWAYS, GIPPS LAND LINE, "SOUTH YARRA TO OAKLEIGH."

SCALES: HORIZONTAL 4 CHAINS TO AN INCH  
VERTICAL 1/40 FEET TO AN INCH

CONTRACT N<sup>o</sup> 1117.  
N<sup>o</sup> 4.

