

VICTORIAN RAILWAYS, CASTLEMAINE AND MALDON LINE

CONTRACT NO 1651
NO 5.

SCALES. HORIZONTAL 4 CHAINS TO AN INCH.
VERTICAL 40 FEET TO AN INCH.

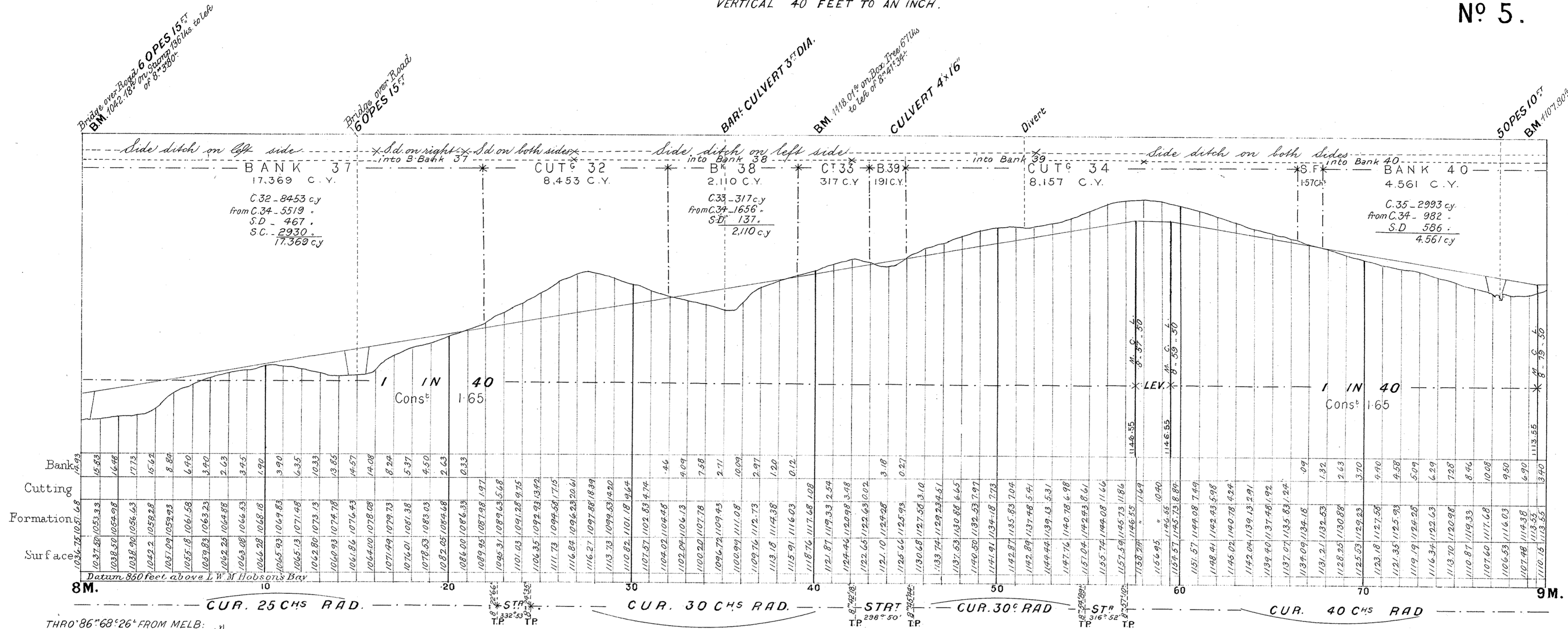

THRO 86° 68' 26" FROM MELB.

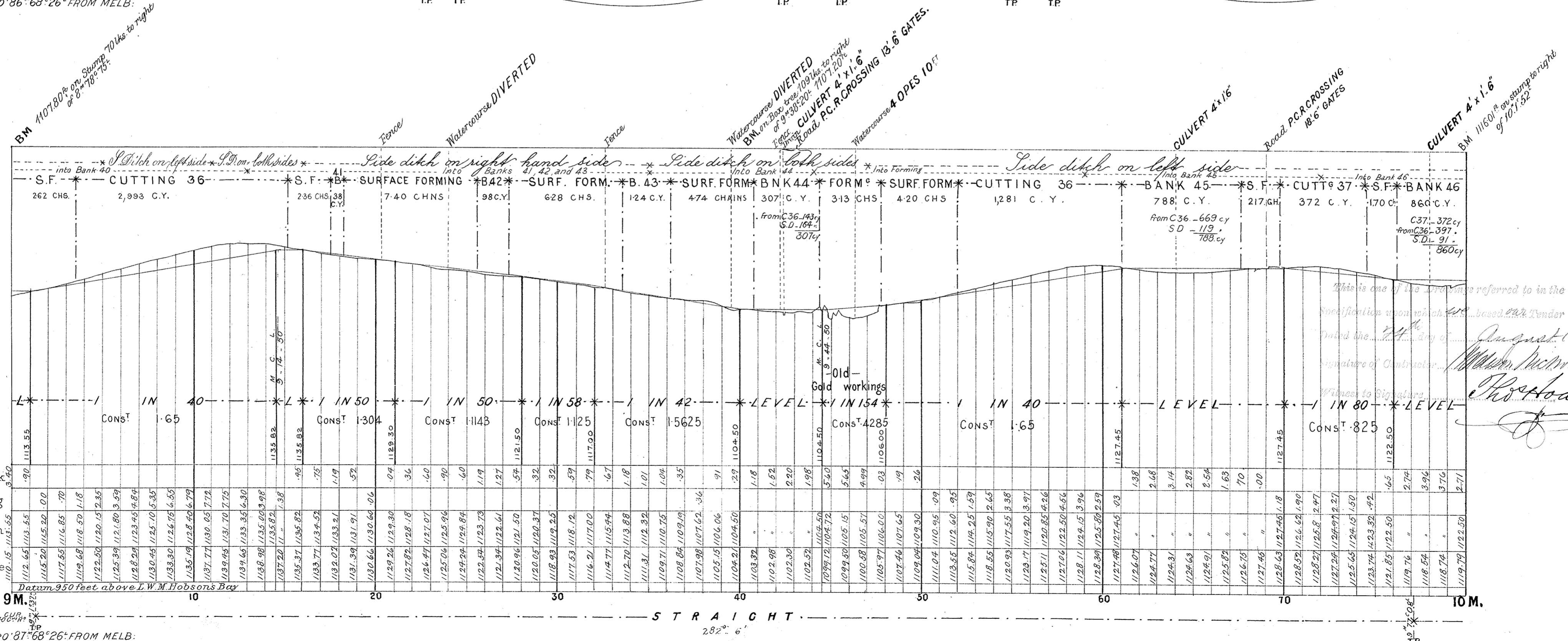

THRO 87° 68' 26" FROM MELB.